

PLAT OF SURVEY

THE SOUTH LINE OF THE PARCEL DESCRIBED IN DEED DOCUMENT NUMBER 565370, ALSO KNOWN AS THE SOUTH LINE OF LOT 14 OF THE UNRECORDED PLAT OF GREIVE'S LOTS, LOCATED IN GOVERNMENT LOT 3 OF SECTION 14, TOWNSHIP 34 NORTH, RANGE 8 EAST, TOWN OF HARRISON, LINCOLN COUNTY, WISCONSIN.

SURVEYOR'S CERTIFICATE
 I, JESSE L. ROBERGE, WISCONSIN PROFESSIONAL LAND SURVEYOR S-2958, DO HEREBY CERTIFY TO THE BEST OF MY KNOWLEDGE AND BELIEF: THAT I HAVE SURVEYED AND MAPPED THE SOUTH LINE OF THE PARCEL DESCRIBED IN DEED DOCUMENT NUMBER 565370, ALSO KNOWN AS THE SOUTH LINE OF LOT 14 OF THE UNRECORDED PLAT OF GREIVE'S LOTS, LOCATED IN GOVERNMENT LOT 3 OF SECTION 14, TOWNSHIP 34 NORTH, RANGE 8 EAST, TOWN OF HARRISON, LINCOLN COUNTY, WISCONSIN, MORE PARTICULARLY DESCRIBED AS FOLLOWS:
 COMMENCING AT THE WEST 1/4 CORNER OF SAID SECTION 14; THENCE SOUTH 00°39'54" EAST, COINCIDENT WITH THE WEST LINE OF SAID GOVERNMENT LOT 3, 1046.44 FEET; THENCE NORTH 89°20'06" EAST, 767.75 FEET TO THE SOUTHWEST CORNER OF THE PROPERTY DESCRIBED IN DEED DOCUMENT NUMBER 565370, ALSO KNOWN AS THE SOUTHWEST CORNER OF LOT 14 OF THE UNRECORDED PLAT OF GREIVE'S LOTS, THE WATER'S EDGE OF SEVEN ISLAND LAKE, AND THE POINT OF BEGINNING; THENCE NORTH 62°27'24" EAST, COINCIDENT WITH THE SOUTH LINE OF SAID PARCEL DESCRIBED IN DEED DOCUMENT NUMBER 565370, ALSO KNOWN AS THE SOUTH LINE OF SAID LOT 14 OF THE UNRECORDED PLAT OF GREIVE'S LOTS, 400.59 FEET TO THE SOUTHEAST CORNER OF SAID PARCEL DESCRIBED IN DEED DOCUMENT NUMBER 565370, ALSO KNOWN AS THE SOUTHEAST CORNER OF SAID LOT 14 OF THE PLAT OF GREIVE'S LOTS, THE WEST RIGHT-OF-WAY LINE OF MARQUARDT ROAD AND THE POINT OF TERMINATION.

THAT I HAVE MADE THIS SURVEY AND MAP THEREOF AT THE DIRECTION OF BRYAN HODGKINS, OWNER OF SAID PARCEL DESCRIBED IN DEED DOCUMENT NUMBER 565370.

THAT SAID LINE IS SUBJECT TO EASEMENTS, RESTRICTIONS, AND RIGHTS-OF-WAY OF RECORD.

THAT I HAVE FULLY COMPLIED WITH THE PROVISIONS OF WISCONSIN ADMINISTRATIVE CODE A-E7.

THAT SAID PARCEL IS A CORRECT AND ACCURATE REPRESENTATION OF THE LINE SURVEYED.

DATED THIS 30TH DAY OF JULY, 2024

REI
 JESSE L. ROBERGE
 WI P.L.S. S-2958

LEGEND

- - 3/4 IN. IRON BAR FOUND
- - 1 IN. O.D. IRON PIPE FOUND
- - 1-1/4 IN. O.D. IRON PIPE FOUND
- - 1-1/4 IN. O.D. X 18 IN. IRON PIPE WEIGHING 1.68 LBS/LIN. FT. SET
- (126°) - RECORDED BEARING/LENGTH
- 126.00' - MEASURED BEARING/LENGTH
- *126.00' - MEASURED LENGTH ALONG WATER'S EDGE

NOTES:

1. BEARINGS ARE BASED ON THE LINCOLN COUNTY COORDINATE SYSTEM, NAD 83(2011) DATUM AND REFERENCED TO THE WEST LINE OF GOVERNMENT LOT 3 OF SECTION 14, TOWNSHIP 34 NORTH, RANGE 8 EAST, MEASURED TO BEAR SOUTH 00°39'54" EAST.
2. FIELD WORK WAS COMPLETED ON 7-2-2024.
3. THE PROPERTY LINE SURVEYED EXTENDS TO THE WATER'S EDGE OF SEVEN ISLAND LAKE.

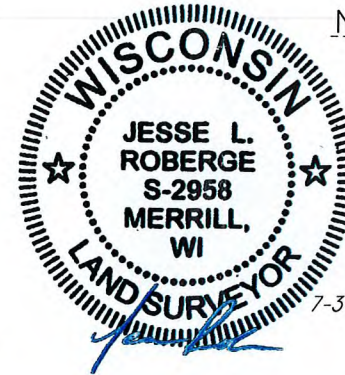

MARQUARDT ROAD
 "PRIVATE"
 WIDTH VARIES

GOVERNMENT LOT 3

DEED DOC. #548566
 LOT 12 UNRECORDED
 PLAT OF GREIVE'S LOTS
 OWNED BY OTHERS

DEED DOC. #548566
 LOT 13 UNRECORDED
 PLAT OF GREIVE'S LOTS
 OWNED BY OTHERS

DEED DOC. #565370
 LOT 14 UNRECORDED
 PLAT OF GREIVE'S LOTS
 OWNED BY CLIENT

DEED DOC. #480185
 LOT 15 UNRECORDED
 PLAT OF GREIVE'S LOTS
 OWNED BY OTHERS

DEED DOC. #498423
 LOT 16 UNRECORDED
 PLAT OF GREIVE'S LOTS
 OWNED BY OTHERS

RECEIVED BY LINCOLN COUNTY
 SURVEYOR THIS 2ND DAY
 OF August 20 24
Tom Dahr
 COUNTY SURVEYOR

MEANDER CORNER ON
 THE WEST LINE OF
 GOVERNMENT LOT 3
 SEC. 14, T34N, R8E
 FOUND 6"X6" STONE

SEVEN ISLAND LAKE

APPROXIMATE WATER'S EDGE

DRAWING FILE: Q:\1600-11699\11612 - BRYAN HODGKINS - N8641 MARQUARDT ROAD - TOWN OF HARRISON - LINCOLN COUNTY\DRAWING\SURVEY\11612 PLAT OF SURVEY.DWG LAYOUT: PLAT OF SURVEY-11X17 PLOTTED: Jul 30, 2024 - 7:59AM PLOTTED BY: JOSHUA R

REI Engineering, Inc.
 4080 N. 20TH AVENUE
 WAUSAU, WISCONSIN 54401
 PHONE: 715.675.9784 FAX: 715.675.4060
 EMAIL: MAIL@REIENGINEERING.COM



REI CIVIL & ENVIRONMENTAL
 ENGINEERING, SURVEYING

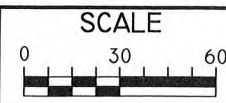

DATE	REVISION	BY	CHK'D	DESIGNED BY:	CHECKED BY:
				SURVEYED BY: AJB, PF	APPROVED BY: JLR
				DRAWN BY: JLR	DATE: 7-8-2024

PLAT OF SURVEY
 BRYAN HODGKINS
 N8641 MARQUARDT ROAD
 GLEASON, WISCONSIN 54435

REI
 REI No. 11612
 SHEET 1 OF 1

S927A