

North is referenced to the East line
NE 1/4, Sec. 10 being a bearing of
S 2° 13' 19" E.

**EASEMENT SURVEY
LOCATED ALONGSIDE THE EAST
LINE OF THE NE 1/4 OF THE NE 1/4,
SEC. 10, T. 35 N., R. 4 E.,
TOWN OF SOMO, LINCOLN COUNTY, WI.**

proposed 33 foot wide easement
for ingress and egress from Carpenter road
to the north line of the Southeast 1/4 of
the Northeast 1/4.

old partially standing wire fence lies
2 to 4 feet West of the Section line.

RECEIVED BY LINCOLN COUNTY
SURVEYOR THIS 6TH DAY
OF March 2024
Tony Dalk
COUNTY SURVEYOR

LEGEND

- subdivisinal monument of record
- subdivisinal monument set
- set 1" iron pipe od
- (0.00') bearing & distance of record

Survey based on Lincoln County Land
Information Maps #S517B & S665B.

SCALE

1" = 100'

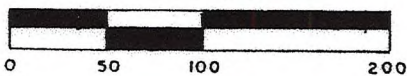

I, Todd Loftus, Professional Land Surveyor, hereby certify,
that I have surveyed the line shown hereon. That this
map represents an accurate survey of said line to the
best of my knowledge & belief. That I have performed this
survey by order of Angela S. Carlson
and that I have complied with the applicable requirements
of the Wisconsin Administrative Code A.E. 7.

DATE Aug. 3, 2023

South line of the NE-NE
North line of the SE-NE

S 85° 24' 36" W

N 1/16
1" iron pipe

1216.26'

E. 1/4
2.5" iron pipe
with 5"x5" plate

S904A

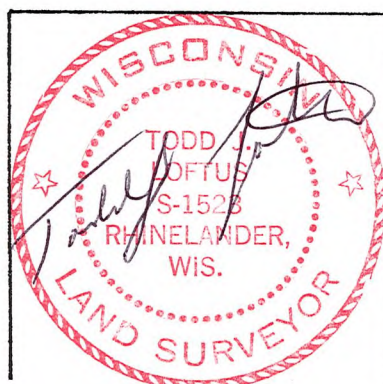

survey for Angela S. Carlson
395 Leeds Court
Nekoosa, WI. 54457

LOFTUS SURVEYING
5437 RIVERVIEW DRIVE
RHINELANDER, WI. 54501
TEL/FAX 715-369-1142
hodag28@hotmail.com

3091B7