

SITE PLAN

Of a Parcel of land described in Document Number 477911 located in part of Government Lot 4 of Section 2, Township 35 North, Range 6 East, Town of Bradley, Lincoln County, Wisconsin.

BEARINGS ARE BASED ON THE WISCONSIN COUNTY COORDINATE SYSTEM, LINCOLN COUNTY NAD 83 (2011) AND REFERENCED TO THE MONUMENTED SOUTH LINE OF GOVERNMENT LOT 4 SECTION 2, TOWNSHIP 35 NORTH, RANGE 6 EAST, MEASURED TO BEAR NORTH 89°43'21" WEST.



EXISTING & PROPOSED GARAGE DETAIL

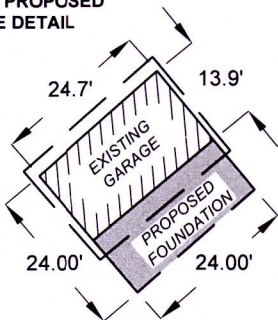

UNPLATTED LANDS OWNED BY OTHERS

Parcel Area
18,240 sq. ft.
0.419 acres

PLAT OF SURVEY
S-2118 11-20-13

DEER LAKE

LAKE

DETAIL 'A'

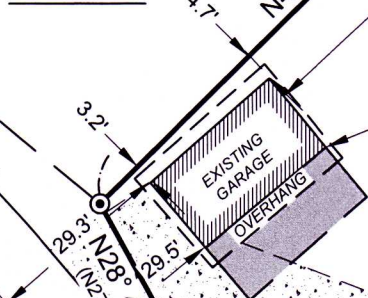

UNPLATTED LANDS OWNED BY OTHERS

LEGEND

- ⊙ - FOUND 3/4" REBAR
- - FOUND 1-1/2" O.D. IRON PIPE
- ⊙ - FOUND NAIL IN TREE
- ⊙ - WELL
- ⊙ - SEPTIC VENT
- ⊙ - SEPTIC TANK COVER
- ⊙ - SEPTIC CLEANOUT
- ▨ - GRAVEL
- ▨ - PAVERS
- - WOOD RAIL FENCE

NORTH

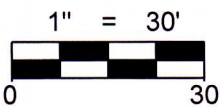

GOV'T LOT 4

FOUND 1" IRON PIPE BY JOHN FISCHER SURVEY MAP S13A DATED JULY 1970

SOUTHEAST CORNER SEC. 12, T35N, R6E, FOUND LINCOLN CO. MONUMENT



LEGAL DESCRIPTION

Of a Parcel of land described in Document Number 477911 located in part of Government Lot 4 of Section 2, Township 35 North, Range 6 East, Town of Bradley, Lincoln County, Wisconsin, described as follows:

Beginning at the Southeast corner of said Section 2; Thence North 89°43'21" West along the monumented South line of said Government Lot 4, 1032.00 feet, Thence North 32°31'12" West, 103.01 feet to the East right-of-way line of Acorn Road which is the point of beginning; Thence continuing North 28°41'58" West along said East right-of-way line, 100.09 feet to the Northwesternly line of a parcel of land described in Document Number 477911; Thence North 45°15'42" East along said Northwesternly line, 196.00 feet to a point located 8 feet, more or less, from the water's edge of Deer Lake, said point also being the point of beginning of a meander line along the West shore of said Deer Lake; Thence South 23°54'02" East along said meander line, 90.03 feet to a point on the Southeastly line of said parcel of land described in Document Number 477911, said point located 7 feet, more or less, from the water's edge of Deer Lake and the end of the meander line along the West shore of said Deer Lake; Thence South 41°39'42" West along said Southeastly line, 192.01 feet to the point of beginning.

That said parcel is subject to all easements, restrictions and right-of-ways of record.

SURVEYOR'S CERTIFICATE:

I, Christopher L. Fieri, Professional Land Surveyor S-2954, do hereby certify to the best of my knowledge and belief, that at the direction of Scott Brzezinski, Owner of said lands, I have surveyed and mapped the lands described hereon. I further certify that said survey and map thereof are a correct and accurate representation of the exterior boundaries of said land and that I have fully complied with the provisions of Wisconsin Administrative Code A-E7 in surveying and mapping said lands.

Dated this 11th day of MARCH 2025

Riverside Land Surveying, LLC
Christopher L. Fieri
WI P.L.S. S-2954

RECEIVED BY LINCOLN COUNTY SURVEYOR THIS 11th DAY OF March 20 25

SHEET 1 OF 1	SITE PLAN FOR SCOTT BRZEZINSKI N11710 ACORN ROAD TOMAHAWK, WI 54487	REVISION: SURVEYED BY: CLF		5310 WILLOW STREET, WESTON, WI 54476 PH 715-241-7500 - FAX 715-355-6894 email - mail@riversidelandsurveying.com	PROJECT No. 4571
		DRAWN BY: CLF CHECKED BY: KJW FIELD WORK: MAR 4, 2025 DRAFT DATE: MAR 7, 2025			

S1002A