

Gold Mine,
Litchfield County,
Connecticut System

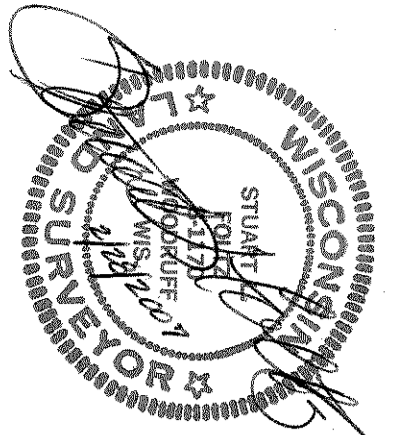

I hereby certify to the present owner(s) and/or those who may hereafter acquire the land described herein that this survey was performed in accordance with acceptable professional standards, that the information and data, a true and accurate representation of the land as surveyed, has been provided to the owner(s) and that this survey was performed by order of Steven Eganman.

Scale: 1" = 200'
0' 100' 200' 400'
● = 1-1/4" iron pipe found
○ = 1" iron pipe set
△ = computed point, not monumented
() = previously recorded

NOTE: This survey is based on the information contained in the plat of the Litchfield County, Connecticut System, effective Nov. 9, 2006, issued by Litchfield County, Connecticut. It is the responsibility of the client to verify the accuracy of the information and to consult a title attorney to discover all of the legal encumbrances attached to this property.

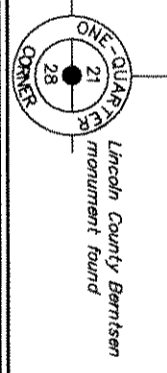

L437B

Town of Bradley
Litchfield County, Wisconsin

GOV'T. LOTS 1 & 3
and all of the
NE1/4 of the NW1/4
SE1/4 of the NW1/4
NW1/4 of the NE1/4
SW1/4 of the NE1/4
SECTION 21, T35N, R6E

Fitz and Associates, Inc.
Surveyors
8811 Highway B North, Wisconsin Rapids 54484
(715) 255-4400
L. 7-2010-001 2236/2827-7338

RECEIVED BY LINCOLN COUNTY
SURVEYOR THIS 19th DAY
OF March 2012
Steven E. Eganman
COUNTY SURVEYOR

