

T 34N RBE S 624

620.53	
748.00	600 - 16.79
797.12	125 - 15.98
1006.49	297 - 14.88
L 216.19	448 - 13.92
61.69	632 - 12.74
176.50	787 - 11.75
421.84	911 - 10.95
261.70	1050 - 10.19
257.51	1104 - 9.72
215.63	1173 - 9.15

2731 $\frac{1}{2}$ 537 - 7.66
 616 $\frac{1}{2}$ 643 8.09
 218 8.64
 854 8.95
 882 9.06
 1039 9.70
 1130 10.48
 1521 11.60
 1609 12.02
 1740 12.55
 1864 13.06
 2196 14.41
 2375 15.14
 2555 15.87

T 34N RBE

W Ret 24 - 18 T 1/2
 L 90° 24 1.52 624
 Sup 201 N-S L 1/2
 6+09.66 625
 2+69.82 250
 11+31.69 250
 13+75.55 270 167°
 16+39.66 275
 19+15.12 290
 22+60.71
 LT 10.05 13° 34' D 1/2
 27

2845.30 L 3+31.27

CS 1/2

ONE 14" N 39° W 27.70'
 " 12" S 12° W 21.80'

CS 1/2

ONE 12" S 82° E 3.30'
 " 11" S 49° W 42.10'

CS 1/2

ONE 7" N 23° W 3.60'
 " 7" S 31° E 8.70'

W 1/2 SW

R. Wire 10" N 47° E 12.40'
 D. 13.06 6" S 30° W 17.80'

L To Turn From SE/16SE

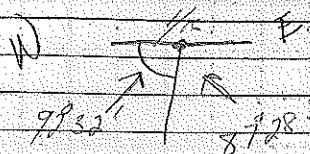

$$620.53 = 7.04$$

$$748.00 = 8.48$$

$$797.12 = 9.04$$

$$1006.49 = 11.41$$

$$216.19 = ~~7.28~~ 20.66$$

139.5' To Street Post

256' To C&N Post

PINE LK 35-5 SEC 25

NO SEC COR 000.00
123.67 1287.99

11.98 518.98
949.96
1067.87

1186.57
97.10 to Pipe - DEF LT
L 11°56'

to Hwy 17 15.75'
76.64.09'
L To MC East Side

of P.LK 100.26' DEF L
LT 408.35' Dist To MC
L From 1664.09 7°18' DEF S.

1100.40 172.42
1198.64
1567.31

1938.41 W of Rd.
2286.94

2892.85
DEF RT L To NW COR 200.41'
Dist 183.18' DEF RT

W BOUND 8" N45°W 42.2'
B LAKESIDE 10" N86°E 26.2'

1051.62 678.36
48.78

00.00

From NW corner of house
3 Small Corn W. House
14" NORTH

From top 1100.40 on W BANK
Back SITED To MC on E BANK
Turned L 35°16' 549.58 to

Point and Bench.
From NW on PINE (Red Bank)
Turned L 126.28' 6+78.36' To

High End on South Side of
L.P.

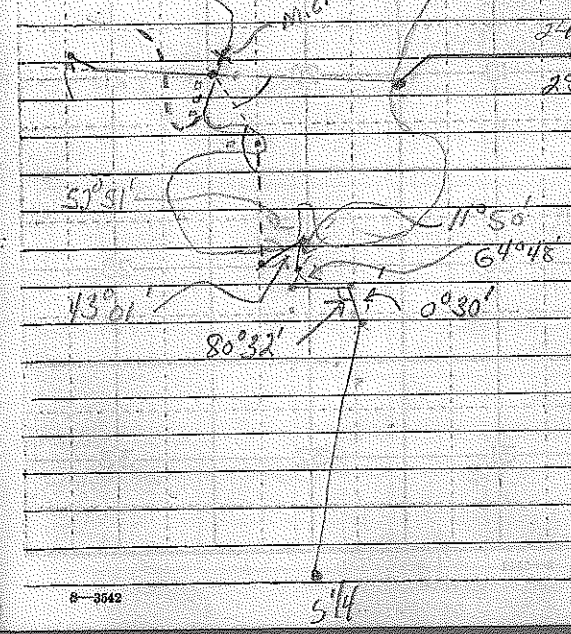

S/4 SEC 25

RT. 6" BALSAM S7°E 17.7'

7" CEDAR N56°W 19.8'

000

7+96.21

9+34.48

14+04.46

14+94.53

16+70.39

17+90.69

22+33.92

28+44.98

35+09.12 DEF. L 0°30'

3+98.76

5+99.56

117+00.00

90°02'

3+20.80 To WHAR 211.00

80 LN 1/4

64°48' 73.93'

DES 11°50' 4+59.38 To

MORNING STAKES

43°01' 2284.99 To W.S.

PREVIOUSLY SET

52°51'

L BETWEEN TWO RADIALS

70°11'

8-3542

12.00

1/4 COR.

WEST 86' To LEHUR SWAMP

SOUTH 193' To CREEK 10' WIDE

PINE STUB 20° S49E 67.1'

STUMP

66

4054

4054

44.59 4'

PINE 12" N23W 66'

Blowdown

E/4 To W/4

MAG. BEARING S89°15'W

000 1/4

BT. 7" MAPLE S82W 25.8'

7' Elm N35°W R.R.

428.30

791.96

ARE RUNNING ON

E 1080.00 OLD BURR LINE

1182.30

1543.38

1972.37

2515.82 ← CROSS OLD N-S

2603.86 BURR LINE.

3063.19

3857.21

4051.96

4190.45 THREW DEF L 5°42'

963.85 To C/4 COR

L 95°02' MAG 2 1/2

227.94 1135.46 2300.42

421.35 1455.96 L DEF 0°28' LT

761.12 2011.09 383.30

8-3542

TRADERS 31.00'

SEC COR. 15, 16, 21 & 22

L BRIDGE RD F DOWN

MILE 86° 34'

- 16+96.19

- 27+61.56

- 31+27.45

- 37+86.66 L 0° 36' BY

15+13.87

SET 1/4 2650.22 7.92' OFF RUN TO N.

BRIDGE RD TRADERS

30+93.84 L 1° 33' DEF LEFT

22+13.57 L 2° 46' DEF RT

9+44.26 L 3° 21' DEF LEFT

15+43.57 L 1° 38' DEF RT

9+19.27 L 2° 25' DEF LEFT

To SEC COR 43, 98/10

TRADERS

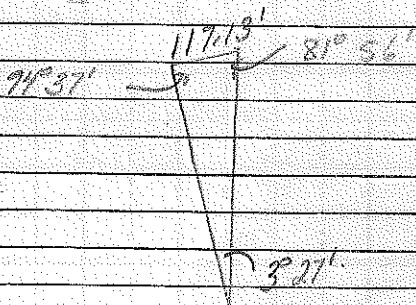

E-W BET 3 & 10

L FROM SEC COR 43, 98/10

L 27° 42' 4

7+47.98 L 31° 26' DEF LEFT

2+67.56 L 29° 52' DEF LEFT

6+17.08 L 13° 20' DEF RT

7+97.82 L 104° 50' E 9-10

8+33.82 "AT" "T" N

12+94.17 L 13° 56' DEF LEFT

2+70.12 L 11° 26' DEF RT

5+71.18

13+95.52 L 148° 42' INT

7+01.70 1° 59' RT DEF

60.24'

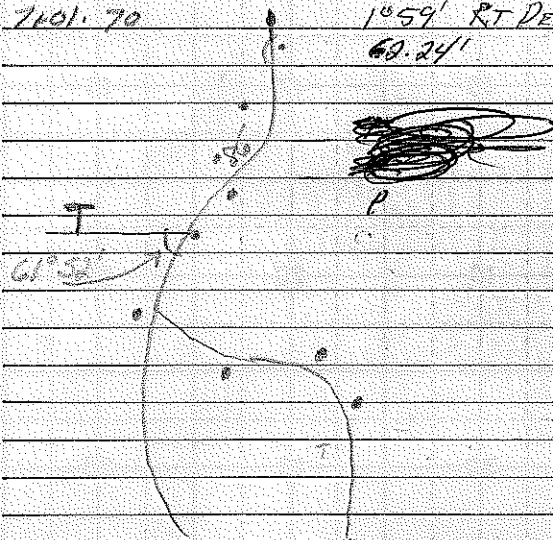

FRANK S. RANDOM 93° 20'

E. TO FENCE LINE

18.5'

BET HUBS

30.12

