

PROJECT I.D. NO. 33/6/18 & 19E
 TITLE: 1986 RECONSTRUCTION OF CTH "E"
 SCALE: 1"=50' HORIZONTAL ; 1"=2' VERTICAL
 SHEET NO. 8 OF

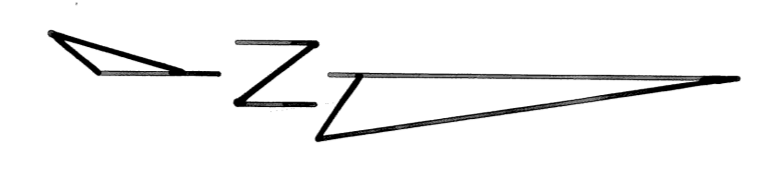

GARY PETERSON, et al

MAX PETERSON

PLAN
 SURVEYED BY: _____ DATE: _____
 PLOTTED BY: _____
 CHECKED BY: _____
 RT. OF WAY CHECKED BY: _____
 NOTE BOOK NO. _____

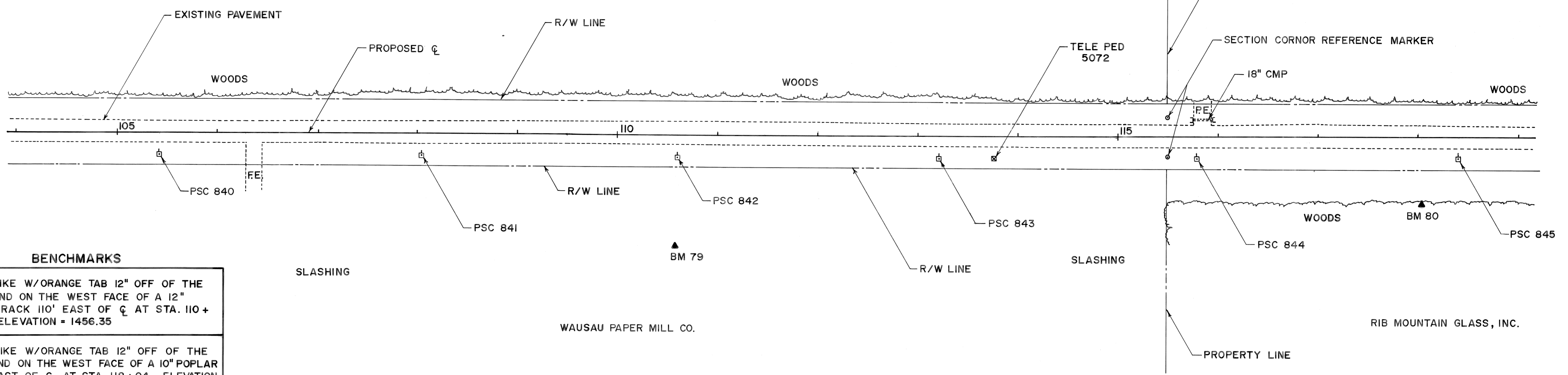

BENCHMARKS

79	4" SPIKE W/ORANGE TAB 12" OFF OF THE GROUND ON THE WEST FACE OF A 12" TAMERACK 110' EAST OF CL AT STA. 110 + 57. ELEVATION = 1456.35
80	4" SPIKE W/ORANGE TAB 12" OFF OF THE GROUND ON THE WEST FACE OF A 10" POPLAR 65' EAST OF CL AT STA. 118 + 04. ELEVATION = 1453.29 .

PROFILE
 SURVEYED BY: _____ DATE: _____
 PLOTTED BY: _____
 CHECKED BY: _____
 STRUCTURE NOTATIONS CHKD BY: _____
 NOTE BOOK NO. _____

