

CONVENTIONAL SIGNS AND ABBREVIATIONS

Acres	Ac.
Access Point	A.P.
Ahead	Ahd.
Back	Bk.
Central Angle	$\Delta$
Center Line	$\text{C}$
Certified Survey Map	C.S.M.
Company	Co.
Corner	Cor.
County Trunk Highway	C.T.H.
Curve	Cur.
Degree of Curve	D
East	E
Found Iron Pipe	FIP
Found Iron Rod	FIR
Feet	Ft.
House	H.
Left	L
Length of Curve	L=
Long Chord	LC
Long Chord Bearing	L.C.B.
Mile	Mi.
Monument	Mon.
North	N
Northeast	NE
Northwest	NW
Permanent Limited Easement	P.L.E.
Point of Curvature	P.C.
Point of Intersection	P.I.
Point of Tangency	P.T.
Point on Curve	P.O.C.
Point on Tangent	P.O.T.
Property Line	P.L.
Project	Proj.
Radius/Range	R
Reference Line	R
Remaining	Rem.
Right	R
Right of Way	R/W
Section	Sec.
Shed	S.
South	S
Southeast	SE
Southwest	SW
Square Feet	S.F.
State Trunk Highway	S.T.H.
Station	Sta.
Tangent Length of Curve	T
Temporary Limited Easement	TLE
Town	T
United States Highway	U.S.H.
West	W

COUNTY LINE	—————	GAS	— G —
TOWNSHIP & RANGE LINES	—————	ELECTRIC	— E —
SECTION LINE	—————	TELEPHONE	— T —
QUARTER LINE	—————	WATER	— WTM —
SIXTEENTH LINE	—————	SANITARY SEWER	— SAN —
EXISTING R/W LINE	— R/W —	STORM SEWER	— STM —
NEW R/W LINE	— R/W —	CABLE MARKER	
PROPERTY LINE	— PL —	FOUND IRON PIPE	○ FIP
LIMITED EASEMENT	— TI —	FOUND IRON ROD	● FIR
FEE TAKING			
TEMPORARY INTEREST			
HIGHWAY EASEMENT			
OBLITERATED ROADWAY			
SLOPE INTERCEPT			
CORPORATE LIMITS			
RAILROAD			
COMBUSTIBLE FLUIDS			
BUILDING			

COPY

R/W PROJECT NUMBER	SHEET NUMBER	TOTAL SHEETS
FEDERAL PROJECT NUMBER	4.1	4.15
PLAT OF RIGHT OF WAY REQUIRED FOR		
U.S.H. 8 TO NICK ROAD		
(0.7 MILES SOUTH OF U.S.H. 8 EASTERLY 3.1 MILES)		
COUNTY HIGHWAY CC		
WisDOT ID: 9408-03-70		



BEGIN RELOCATION PROJECT 9408-03-70  
 STA. 7+22.00 49.66' N. AND 0.88' W  
 N = 245,789.55 OF THE E. 1/4 COR.  
 E = 349,199.99 SEC. 16, T.35N., R.5E.

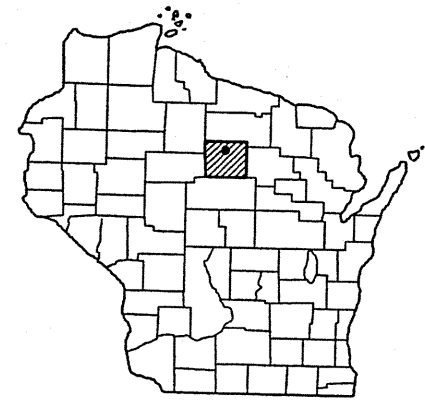
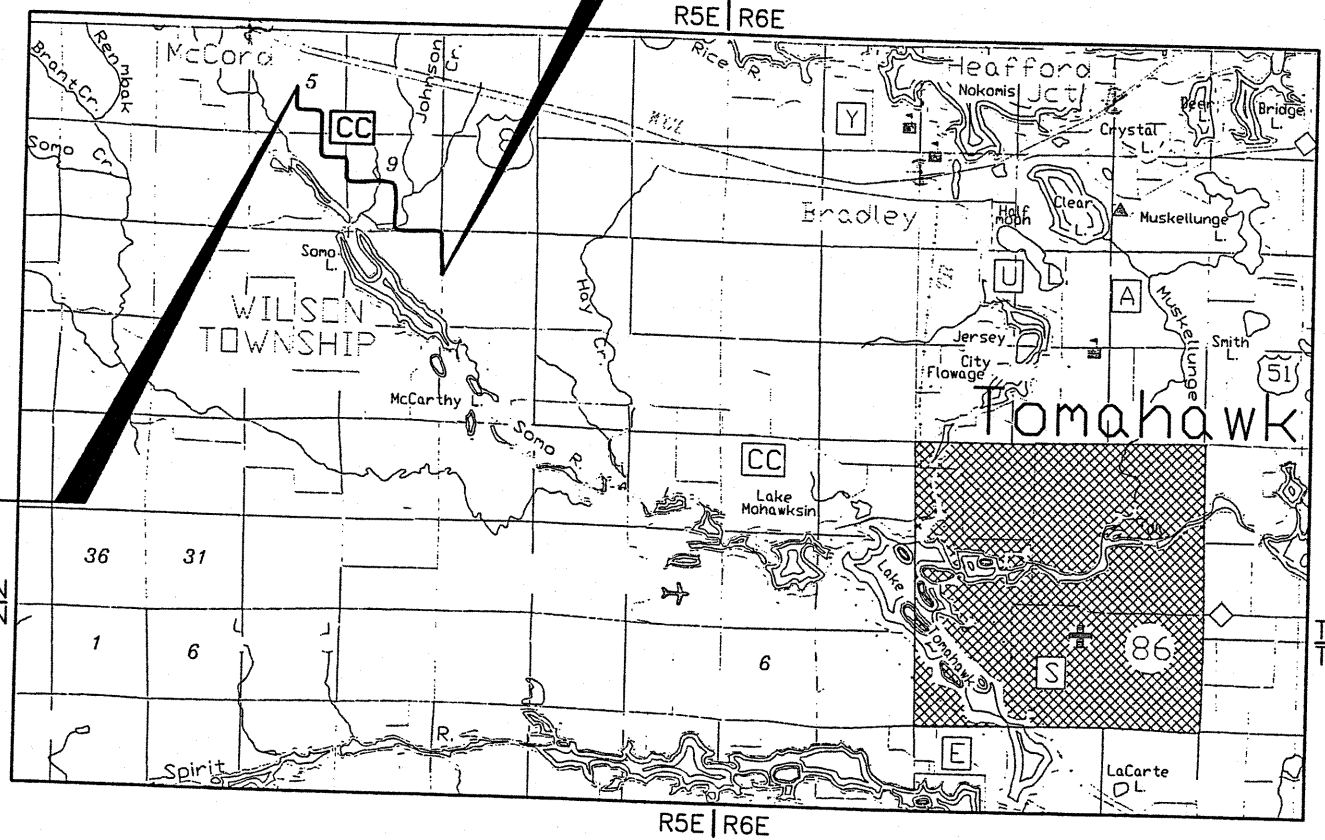

END RELOCATION ORDER PROJECT 9408-03-70  
 169+00.00 590.16' S. AND 2664.80' W.  
 N = 255,701.03 OF THE E. 1/4 COR.  
 E = 341,077.30 SEC. 5, T.35N., R.5E.

APPROVED FOR  
 LINCOLN COUNTY  
 DATE: \_\_\_\_\_  
 HIGHWAY COMMISSIONER

ORIGINAL PLAT PREPARED BY  
**BIA**  
 BECHER-HOPPE ASSOCIATES, INC.  
 ENGINEERS ARCHITECTS SCIENTISTS  
 330 FOURTH ST. P.O. BOX 8000 WAUSAU, WI. 54402-8000  
 Telephone: (715) 845-8000

WISCONSIN  
 DONALD D. FRISQUE  
 S-1218  
 Wausau Wis.  
 LAND SURVEYOR  
 Done 1/18/02

NOTES  
 COORDINATES AND BEARINGS ON THIS PLAT ARE ORIENTED TO THE LINCOLN COUNTY IMPERIAL COORDINATE SYSTEM NAD 1983 (91) AND ARE GROUND BASED.  
 RIGHT OF WAY MONUMENTS ARE TYPE 2 AND ARE PLACED PRIOR TO OR AT THE TIME OF LAND TITLE TRANSFER.  
 RIGHT OF WAY BOUNDARIES ARE DEFINED WITH COURSES OF THE PERIMETER OF THE HIGHWAY LANDS REFERENCED TO THE U.S. PUBLIC LAND SURVEY OR OTHER LAND SURVEYS OF PUBLIC RECORD.

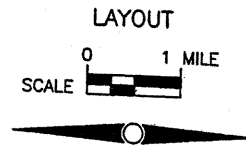

TOTAL NET LENGTH OF CENTERLINE = 3.064 MILES

REVISION DATE	STATE OF WISCONSIN
9/7/01 NO CHANGE	DEPARTMENT OF TRANSPORTATION
12/10/01 NO CHANGE	
1/9/02 NO CHANGE	