

R/W PROJECT NUMBER	SHEET	TOTAL
FEDERAL PROJECT NUMBER	4.1	4.15
PLAT OF RIGHT OF WAY REQUIRED FOR		
U.S.H. 8 TO NICK ROAD (0.7 MILES SOUTH OF U.S.H. 8 EASTERLY 3.1 MILES)		
COUNTY HIGHWAY CC		
WisDOT ID: 9408-03-70		

- Acres
- Access Point
- Ahead
- Back
- Central Angle
- Center Line
- Certified Survey Map
- Company
- Corner
- County Trunk Highway
- Curve
- Degree of Curve
- East
- Found Iron Pipe
- Found Iron Rod
- Feet
- House
- Left
- Length of Curve
- Long Chord
- Long Chord Bearing
- Lot
- Monument
- North
- Northeast
- Northwest
- Permanent Limited Easement
- Point of Curvature
- Point of Intersection
- Point of Tangency
- Point on Curve
- Point on Tangent
- Property Line
- Project
- Radius/Range
- Reference Line
- Remaining
- Right
- Right of Way
- Section
- Shed
- South
- Southeast
- Southwest
- Square Feet
- State Trunk Highway
- Station
- Tangent Length of Curve
- Temporary Limited Easement
- Town
- United States Highway
- West

- CONVENTIONAL SIGNS AND ABBREVIATIONS
- Ac. A.P.
  - Bk. Ahd.
  - Δ
  - ⊕
  - C.S.M.
  - Co. Cor.
  - C.T.H. Cur.
  - D
  - E
  - FIP
  - FIR
  - Fl. H.
  - L
  - L=
  - LC
  - L.C.B.
  - Mi.
  - Mon.
  - N
  - NE
  - NW
  - P.L.E.
  - P.C.
  - P.I.
  - P.T.
  - P.O.C.
  - P.O.T.
  - P.L
  - Proj.
  - R
  - Rem.
  - R
  - R/W
  - Sec.
  - S.
  - SE
  - SW
  - S.F.
  - S.T.H.
  - Sta.
  - T
  - TLE
  - T
  - U.S.H.
  - W

GAS	— G —	NON-COMPENSABLE	COMPENSABLE
ELECTRIC	— E —	SERVICE PEDESTAL	☒
TELEPHONE	— T —	POWER POLE	☐
WATER	— WTM —	TELEPHONE POLE	⊗
SANITARY SEWER	— SAN —	SIGN	⊥
STORM SEWER	— STM —		
CABLE MARKER	↑		
FOUND IRON PIPE	○ FIP		
FOUND IRON ROD	● FIR		

COPY

BEGIN RELOCATION PROJECT 9408-03-70  
 STA. 7+22.00 N = 245,789.55 49.66' N. AND 0.88' W  
 E = 349,199.99 OF THE E. 1/4 COR.  
 SEC. 16, T.35N., R.5E.

END RELOCATION ORDER PROJECT 9408-03-70  
 169+00.00 N = 255,701.03 590.16' S. AND 2664.80' W.  
 E = 341,077.30 OF THE E. 1/4 COR.  
 SEC. 5, T.35N., R.5E.

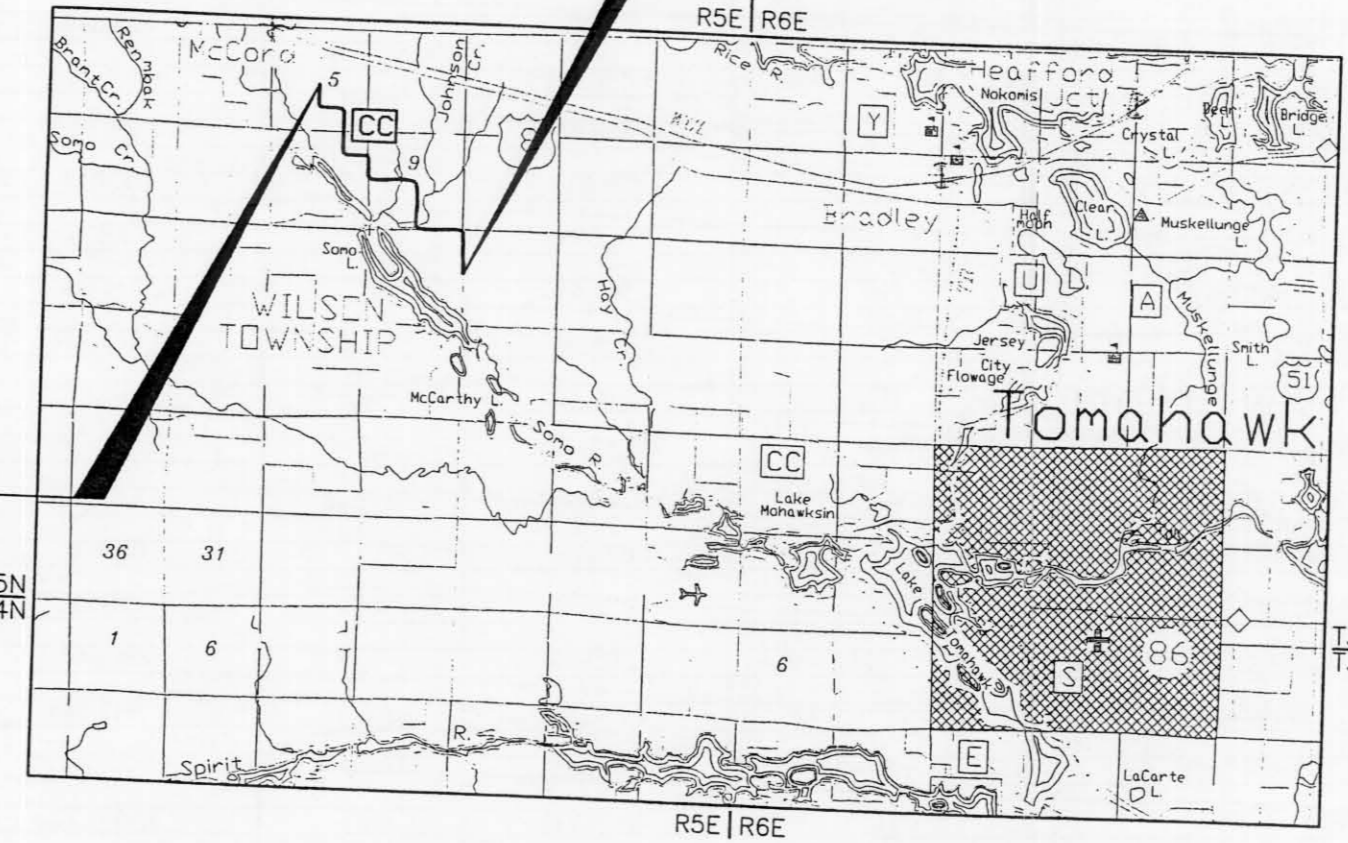

APPROVED FOR  
 LINCOLN COUNTY  
 DATE: \_\_\_\_\_  
 HIGHWAY COMMISSIONER

ORIGINAL PLAT PREPARED BY  
**BIA**  
 BECHER-HOPPE ASSOCIATES, INC.  
 ENGINEERS ARCHITECTS SCIENTISTS  
 330 FOURTH ST. P.O. BOX 8000 WAUSAU, WI 54402-8000  
 Telephone: (715) 845-8008

WISCONSIN  
 DONALD D. FRISQUE  
 S-1218  
 Wausau Wis.  
 LAND SURVEYOR  
 1/18/02

NOTES  
 COORDINATES AND BEARINGS ON THIS PLAT ARE ORIENTED TO THE LINCOLN COUNTY IMPERIAL COORDINATE SYSTEM NAD 1983 (91) AND ARE GROUND BASED.  
 RIGHT OF WAY MONUMENTS ARE TYPE 2 AND ARE PLACED PRIOR TO OR AT THE TIME OF LAND TITLE TRANSFER.  
 RIGHT OF WAY BOUNDARIES ARE DEFINED WITH COURSES OF THE PERIMETER OF THE HIGHWAY LANDS REFERENCED TO THE U.S. PUBLIC LAND SURVEY OR OTHER LAND SURVEYS OF PUBLIC RECORD.

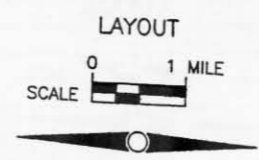

TOTAL NET LENGTH OF CENTERLINE = 3.064 MILES

REVISION DATE
9/7/01 NO CHANGE
12/10/01 NO CHANGE
1/9/02 NO CHANGE

STATE OF WISCONSIN  
 DEPARTMENT OF TRANSPORTATION