

NO	OWNER	ADDRESS	ACRES	DESCRIPTION	MORTGAGEE	ADDRESS	AMOUNTS PAID		REMARKS
							R	WIFENCE	
1	ELZEOR AND ADLINE MYRE		0.24	SW 1/4 - NE 1/4 SEC 22 T 35N R 6E - (A PART OF)					
2	MARY TRIMBERGER	TOMAHAWK, WIS.	2.69	SW 1/4 - " " " " " "					
3	" " " "	" " " "	4.85	NW 1/4 - " " " " " "					
4	BEULAH HULTS	" " " "	4.43	SW 1/4 - SE 1/4 " " 15	BANK OF TOMAHAWK	TOMAHAWK, WIS.			
5	ROY B. AND HELEN LEWERENZ	" " " "	0.03	NW 1/4 - " " " " " "	TECKLA AND NAFFZ	SAUK CITY, "			
6	" " " "	" " " "	0.53	SE 1/4 - " " " " " "	" " " "	" " " "			
7	" " " "	" " " "	0.00	NE 1/4 - " " " " " "	" " " "	" " " "			
8	W. C. BOSCHE	" " " "	4.90	NE 1/4 - " " " " " "	" " " "	" " " "			
9	PETER SCHOONE	" " " "	4.91	SE 1/4 - NE 1/4 " " " " " "	" " " "	" " " "			
10	BOYD SHOWERS	" " " "	2.42	NE 1/4 - " " " " " "	E. M. MAC DONALD	TOMAHAWK, WIS.			
11	FRANK THEILER	" " " "	7.28	NW 1/4 - NW 1/4 " " 14	" " " "	" " " "			
12	" " " "	" " " "	6.46	SW 1/4 - SW 1/4 " " 11	" " " "	" " " "			
13	JULIA S. FIELD	" " " "	6.41	NW 1/4 - " " " " " "	MARGARET M. BOWELL	MERRILL,			
14	F. L. SLATER	" " " "	4.36	SW 1/4 - NW 1/4 " " " " " "	HARDY-RYAN ABS. CO.	WAUKESHA,			
15	CAROLINE SHOWER	" " " "	7.58	ALL GOVT LOT 4, E OF C. M. ST. P. & P. RY.	HERBERT KAMKE	MERRILL,			
16	E. G. AND HELENE HOLLOWAY	CHICAGO, ILL.	2.21	NORTHERNMOST PARCEL OF GOVT LOT 4 W OF C. M. ST. P. & P. RY.	" " " "	" " " "			
17	CLARA SLATER	TOMAHAWK, WIS.	4.85	NE 1/4 - NE 1/4 SEC 10 T 35N R 6E	FEDERAL LAND BANK	ST. PAUL, MINN.			
18	EDWIN AND HELENE HOLLOWAY	CHICAGO, ILL.	1.61	NW 1/4 - " " " " " "	(N.E. CORNER OF)	" " " "			
19	CLARA SLATER	TOMAHAWK, WIS.	2.03	SE 1/4 - SE 1/4 " " 3	FEDERAL LAND BANK	ST. PAUL,			
20	" " " "	" " " "	1.98	SW 1/4 - " " " " " "	" " " "	" " " "			
21	ANNA LEE THEISEN, ARTHUR & HAZEL KOEHLER	IOWA TOMAHAWK	2.24	NW 1/4 - " " " " " "	(1/2 INTEREST EACH)	" " " "			
22	SAME AS PARCEL 21	" " " "	2.20	NE 1/4 - " " " " " "	" " " "	" " " "			
23	" " " "	" " " "	4.73	SE 1/4 - NE 1/4 " " " " " "	" " " "	" " " "			
24	" " " "	" " " "	1.60	SW 1/4 - " " " " " "	" " " "	" " " "			
25	ERIC & HILDA OLSON; IRENE, JAMES, GORDON, AND MARVIN ROBINSON	" " " "	9.54	NE 1/4 - " " " " " "	BRADLEY BANK	TOMAHAWK, WIS.			

FED. ROAD DIST. NO. 4 STATE WIS. FED. AID PROJ. NO. 431-C SHEET NO. 5 TOTAL SHEETS 60
DIVISION JOB NO. 7894

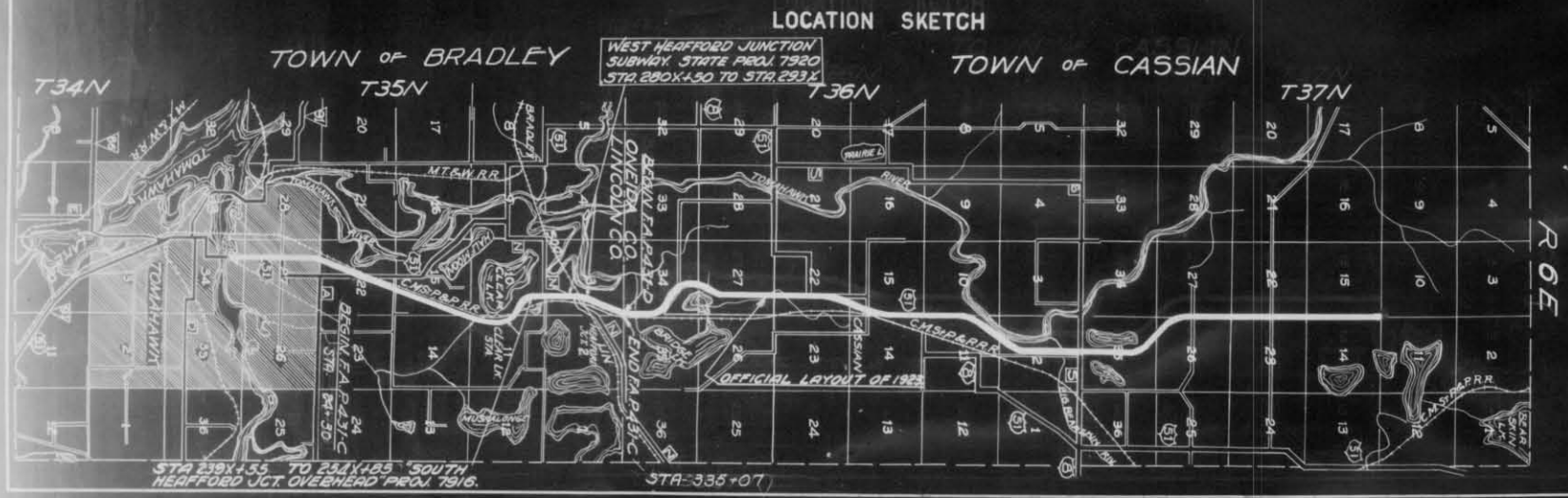

PLAT OF RIGHT OF WAY REQUIRED
FED. AID PROJECT NO. 431-C
TOMAHAWK - CASSIAN ROAD
U.S.H. NO. 51 LINCOLN COUNTY
SCALE 0 1 MI. 2 MI.