

U.S. PUBLIC LAND SURVEY MONUMENT RECORD

NOTE: This form is intended and designed to fulfill all requirements of Wisconsin Administrative Code, Chapter A-E 7.08 U.S. Public Land Survey Monument Record (3)(a)(b)(c)(d)(e)(f)(g)(h)(i). An additional sheet may be added if necessary to conform with said requirements.

(a) Corner location: Township 35 North

Range 08 East

Town of HARRISON

LINCOLN County, Wisconsin

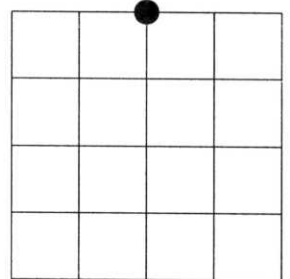

Section 27

(b)(f)(g)(h) Description of monument found at this corner and if it was accepted, state all evidence (material, testimonial, occupational, plats, records, other monuments) used as a basis for accepting. If not accepted or if nothing was found, state evidence used as basis for establishing location. If reestablished through lost corner proportionate methods, indicate all monuments, distances and directions used to establish. Indicate type of monument found or set and sign post.

1865 - Original corner set by Jos. L. Nowlin

1937- Francis Fuchs- found positive original corner as evidenced by plain markings cut of a hemlock stump, stake set about 7 years ago, set 6" x 6" granite stone.

Hemlock 12" N77°E 15.1 Lks.
 Hemlock 9" S33°W 30.8 Lks.
 Old Hemlock BT 14" N26°W Lks.

2003- I found 6"x6" granite stone up 15" in mound of stone BTs by others (grown over)

10" Maple N71°W 2.9'
 10" Maple N14°E 30.5'
 8" Maple S72°E 14.0'
 8" Maple S08°W 9.0'

Witnessed corner as shown below.

(c)(d)(e) Plan view of corner with ties to at least 4 witness monuments. If in disagreement with previously established corner, show the distances between the two corners and also indicate the ties to the disputed corner.

RECEIVED AT LINCOLN COUNTY
 COURTHOUSE THIS 11TH DAY
 OF June 20 03
Tony Dabbs
 LAND INFORMATION OFFICE

- FOUND 6"x6" GRANITE MONUMENT
- SET 3/4" DIA. ROD WITH ALUMINUM CAP
- T** PLASTIC "T" SIGN EAST 1'

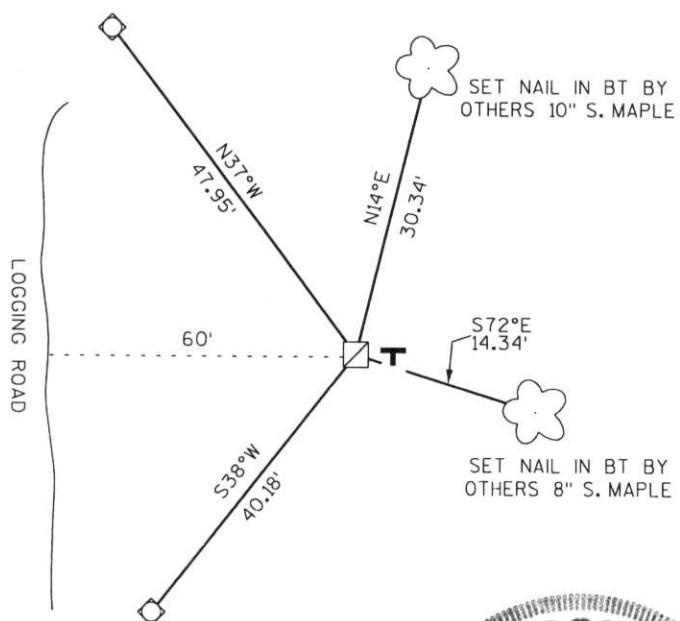

(i) I, Dennis Roberts, Registered Land Surveyor #S-1863, hereby certify that the corner location on this record was determined by me or under my direction and control and that this U.S. Public Land Survey Monument Record is correct and complete to the best of my knowledge and belief.



Index No. *****
 0-15

Dennis B. Roberts
 Signature

5/29/03
 Date

