

CERTIFIED LAND CORNER RESTORATION

Index No. M-23

State of Wisconsin }  
County of LINCOLN } ss.

I William Immich, do hereby certify that on the 4th day of MAY, 1985, I found evidence of the SOUTH 1/4 corner of SECTION 13 Township 35, North, Range 8 EAST, Fourth, Principal Meridian, as described hereon; and that from this evidence I established a new monument and accessories as described hereon to perpetuate the original location of this corner.

Resident witnesses:

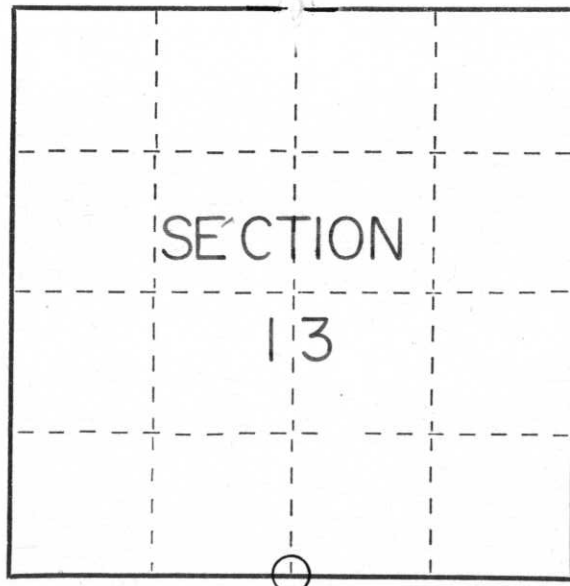
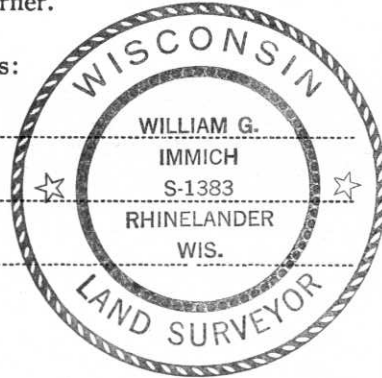

○ = Corner monument restored.

History of original corner establishment:

1865 - NOWLIN GOVT SURVEYOR - WEST ON TRUE LINE 40.00 SET 1/4 POST BIRCH 12 N 48E 10, BIRCH 10 S10W 8

F. FOX RAN EAST BETWEEN 13-24 39.50 SET 1/4 STONE AT FENCE LINE ELM 16" S24E 105.51k ELM 3" N 32°W 42.1ks

Description of corner evidence found:

FOUND FOXS STONE AT FENCE LINE RUNNING NORTH. ROCK PILE AROUND STONE CORNER 39.47 EAST OF S.W. Sec CORNER (FOX 39.5) CORNER 33.92 WEST OF S.E. Sec CORNER (FOX 34.39)

Description of monument and accessories I established to perpetuate the original location of this corner.

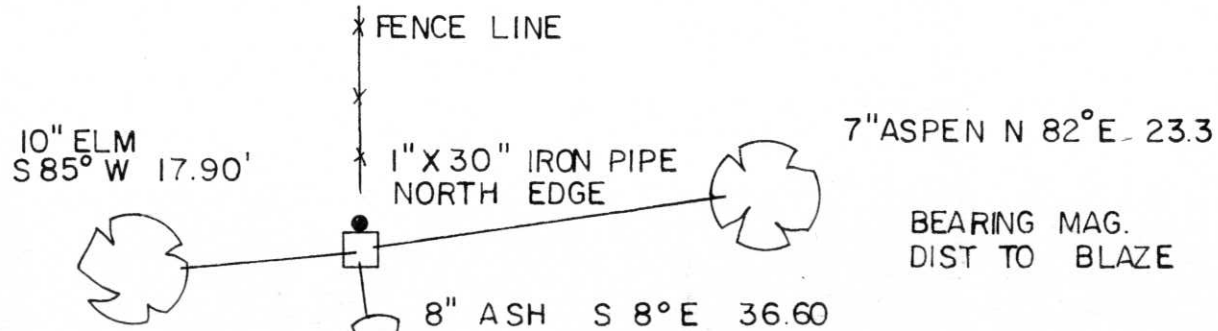

Dated at Rhinelander, Wis., this 5th day of MAY, 1985.

Signature William Immich Title R.L.S. Registration No. 1383  
(County Surveyor, Registered Land Surveyor, or other duly authorized official)

Office of Register of Deeds, County of \_\_\_\_\_, I hereby certify that the within instrument was filed in this office for record on the \_\_\_\_\_ day of \_\_\_\_\_, 19\_\_\_\_ at \_\_\_\_\_ o'clock \_\_\_\_\_ M.

(Register of Deeds)

By \_\_\_\_\_ Deputy



18 5:03 PM





18 4:55 PM





18 4:55 PM



**POSTED**  
PRIVATE PROPERTY  
HUNTING, FISHING, TRAPPING OR  
HARVESTING FOR ANY PURPOSE  
IS STRICTLY FORBIDDEN  
VIOLATORS WILL BE PROSECUTED

18 5:03 PM