

**U.S. PUBLIC LAND SURVEY MONUMENT RECORD**

Note: This form is intended and designed to fulfill all requirements of Wisconsin Administrative Code, Chapter A-E 7.08 U.S. Public Land Survey Monument Record (3) (a) (b) (c) (d) (e) (f) (g) (h) (i). An additional sheet may be added if necessary to conform with said requirements.

(a) CORNER LOCATION: WISCRS - Oneida County  
Cor. of Secs. 13, 18, 19 & 24 N: 118,884.09 USft  
Township 35 North E: 260,009.06 USft  
Range 8 & 9 East of the 4th P.M. Datum: NAD 1983(2011)  
Town of Enterprise County of Oneida

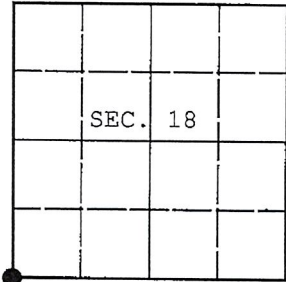

(b) HISTORY OF ORIGINAL CORNER ESTABLISHMENT

Original Surveyor: \_\_\_\_\_ Original Accessories: ●  
Date of Survey: Commenced: \_\_\_\_\_  
Completed: \_\_\_\_\_

(b) (f) (g) (h) Description of monument found at this corner and if it was accepted, state all evidence (material, testimonial, occupational, plats, records, other monuments) used as a basis for accepting. If not accepted or if nothing was found, state evidence used as basis for establishing location. If re-established through lost corner proportionate methods, indicate all monuments, distances and directions used to establish. Indicate type of monument and sign post found or set.

NOTE: This is a perpetuation of a previous USPLS Monument Record by William G. Immich, RLS dated November 5, 1981 and filed in the office of the Oneida County Register of Deeds. A complete history of the corner can be found on the previous monument record. I accept the previous location as a true and faithful perpetuation or reestablishment of the original corner location and further perpetuate it as follows.

June 14, 2016: I found and accepted the record monument, a 2.5" diam. iron pipe with brass cap projecting 20" above a ring of rocks. The existing accessories were found in substantial agreement with the record and were not remeasured as the sole purpose of this work is to report the coordinates of the corner point.

The coordinates shown were derived from two independent RTK observations of the corner point and are referenced to the WISCORS GNSS Network.

(c) (d) (e) Plan view of corner with ties to at least 4 witness monuments. If in disagreement with previously established corner, show the distances between the two corners and also indicate the ties to the disputed.

REGISTER OF DEEDS OFFICE  
ONEIDA COUNTY  
FILED

DEC 28 2016

AT \_\_\_\_\_ O'CLOCK \_\_\_\_\_ M  
KYLE J. FRANSON  
REGISTER OF DEEDS

RECEIVED BY LINCOLN COUNTY  
SURVEYOR THIS 17<sup>TH</sup> DAY  
OF January 2018  
Tommy Dahl  
COUNTY SURVEYOR

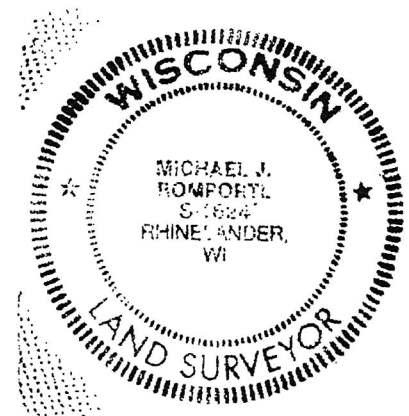

(i) I, Michael J. Romportl, Professional Land Surveyor No. S-1624, hereby certify that the corner location on this record was determined by me or under my direction and control and that this U.S. Public Land Survey Monument Record is correct and complete to the best of my knowledge and belief.

Michael J Romportl 12/23/2016  
Signature Date

M-25

CERTIFIED LAND CORNER RESTORATION

Index No. M-25

State of Wisconsin }  
County of LINCOLN } ss.

I William Immich, do hereby certify that on the 4th day of MAY, 1985, I found evidence of the SOUTHEAST corner of SECTION 13 Township 35, North, Range 8 EAST, Fourth, Principal Meridian, as described hereon; and that from this evidence I established a new monument and accessories as described hereon to perpetuate the original location of this corner.

Resident witnesses

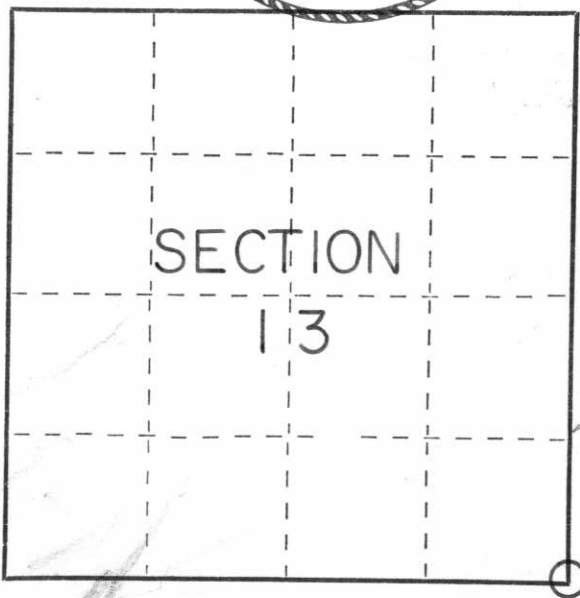

○ = Corner monument restored.

History of original corner establishment:

1859 H.F. FELLOWS - 80.00 SET CORNER TO 13-18-19-24 BIRCH 14 S 84W 251K  
BIRCH 10 N 33W 13; BIRCH 12 N 35E 221K; LIND. 10 S 53E 151K; SUGAR 12 S 33W 16 1/2 1K  
1935 V.M. MAINE - IDENTIFIED BY B.N. MORGAN AS LOCATION OF ORIGINAL CORNER, FOUND OLD STAKE AND PILE OF ROCKS, FOUND STUMP HOLES OF ORIGINAL BTS FOUND D.H. VAUGNS B.T. SET CAPPED IRON PIPE, NEW B.T. BLACK OAK 7" S 31 E 67 3/4 1K

Description of corner evidence found:

FOUND V.M. MAINE'S CAPPED IRON PIPE IN GOOD CONDITION, LINE CUT WEST FROM CORNER, PIPE STAMPED AS SHOWN  
PIPE IN ROCK PILE

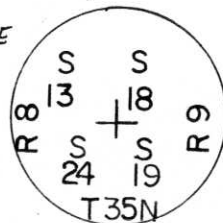

Description of monument and accessories I established to perpetuate the original location of this corner.

18" TWIN OAK N 11 W 30.92'

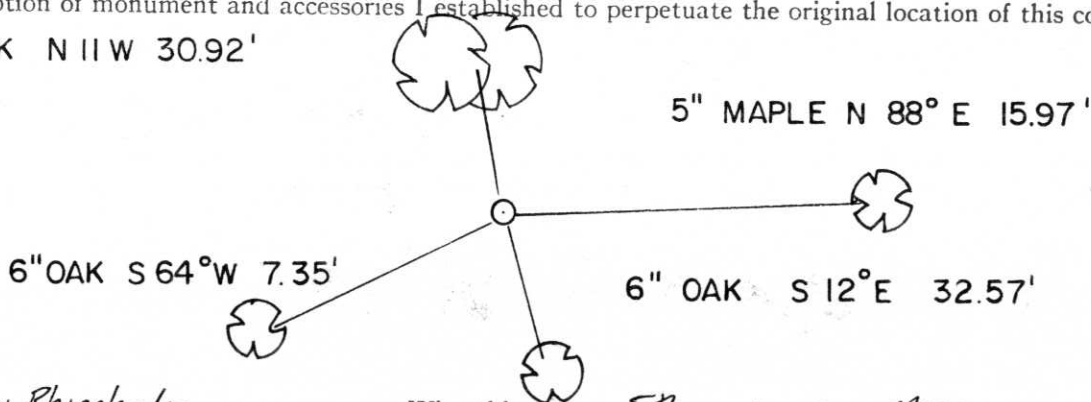

BEARINGS MAG. DIST. TO P.K. NAIL

Dated at Rhinelander, Wis., this 5th day of MAY, 1985.

Signature William Immich Title R.L.S. Registration No. 1383  
(County Surveyor, Registered Land Surveyor, or other duly authorized official)

Office of Register of Deeds, County of \_\_\_\_\_, I hereby certify that the within instrument was filed in this office for record on the \_\_\_\_\_ day of \_\_\_\_\_, 19\_\_\_\_ at \_\_\_\_\_ o'clock \_\_\_\_\_ M.

(Register of Deeds)

By \_\_\_\_\_ Deputy





18 5:55 PM



18 5:55 PM



18 6:24 PM

SMARKER  
VEYR

18 6:23 PM

