

CERTIFIED LAND CORNER RESTORATION

Index No. I, 17-18

State of Wisconsin }
County of LINCOLN } ss.

I William Immich, do hereby certify that on the 6th day of APRIL, 1985, I found evidence of the M.C. EAST ON HILTS LK. OF RANDOM LINE corner of SECTION 11 Township 35, North, Range 8 EAST, Fourth, Principal Meridian, as described hereon; and that from this evidence I established a new monument and accessories as described hereon to perpetuate the original location of this corner.

Resident witnesses:

.....
.....
.....

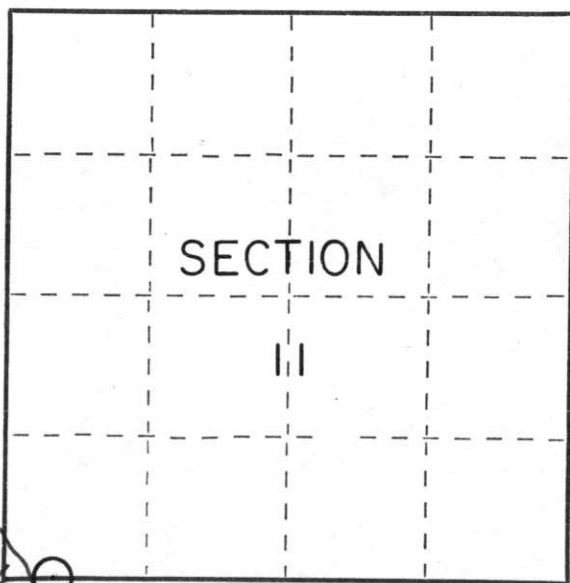

HILTS LAKE
○ = Corner monument restored.

History of original corner establishment:

1865 NOWLIN - GOVT SURVEYOR : WEST ON TRUE LINE
75:00 INTERSECT LAKE SET M.C. SPRUCE 8 N 65 E 12 IK
BIRCH 6 S 28 E 22 IK
F. FOX SET M.C. ON EAST SHORE 24.3 NORTH
OF RANDOM LINE NORWAY PINE 10" S 78 E 10.6 IK
A STONE 2' x 3' 12" ABOVE GROUND N 34 43.3 IK
TO NEAREST EDGE MOUNDED WITH STONE AT FOOT OF SLOPE

Description of corner evidence found:

I FOUND SQ. STONE, LYING ON SIDE, STRAIGHTENED STONE AND SET 1" IRON PIPE ON EAST SIDE OF STONE.
I ALSO FOUND FOX'S WITNESSES AS SHOWN BELOW.

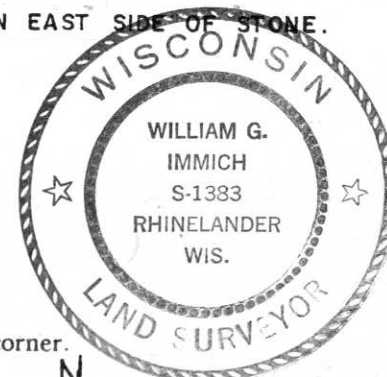

Description of monument and accessories I established to perpetuate the original location of this corner.

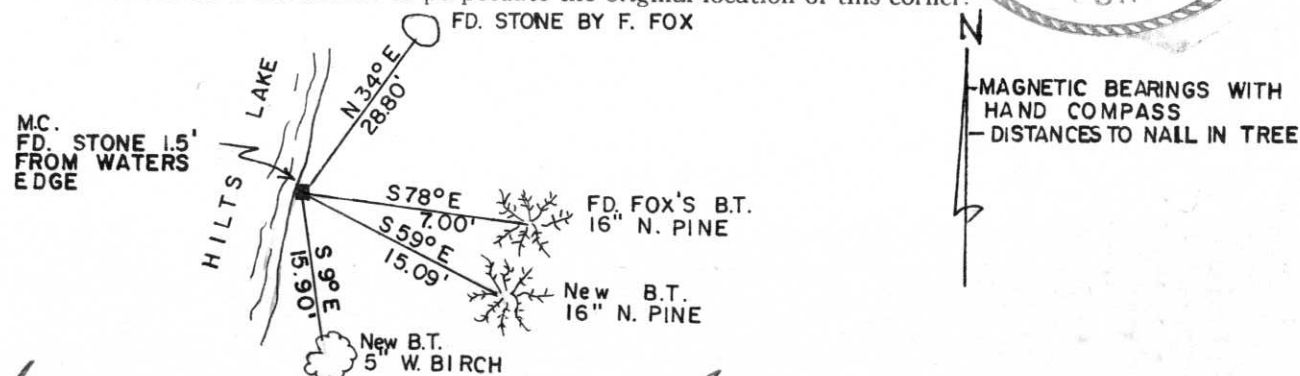

Dated at Rhinelanders, Wis., this 7th day of April, 1985.

Signature William Immich Title RLS Registration No. 1383
(County Surveyor, Registered Land Surveyor, or other duly authorized official)

Office of Register of Deeds, County of _____, I hereby certify that the within instrument was filed in this office for record on the _____ day of _____, 19____ at _____ o'clock _____ M.

.....
(Register of Deeds)

By _____ Deputy