

CERTIFIED LAND CORNER RESTORATION

Index No. G-17

State of Wisconsin }  
County of LINCOLN } ss.

I William Immich, do hereby certify that on the 6th day of APRIL, 1985, I found evidence of the WEST 1/4 corner of SECTION 11 Township 35, North, Range 8 EAST, Fourth, Principal Meridian, as described hereon; and that from this evidence I established a new monument and accessories as described hereon to perpetuate the original location of this corner.

Resident witnesses:

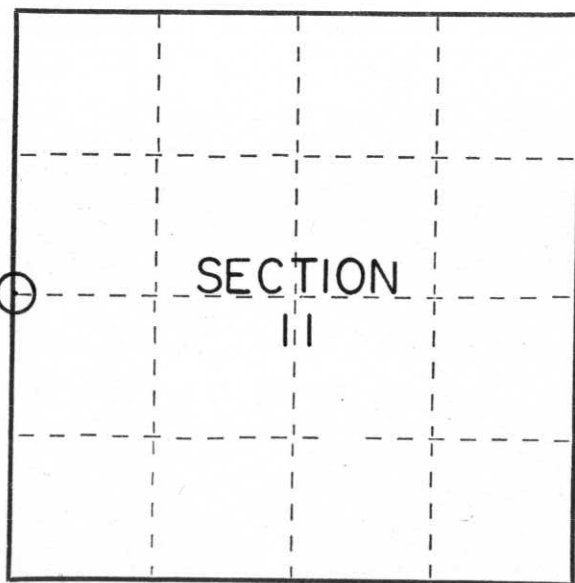

○ = Corner monument restored.

History of original corner establishment:

1865 NOWLIN GOVT SURVEYOR : NORTH BET 10+11 VAR 8°E  
40.00 SET 1/4 POST MAPLE 10 N 70 E 131K SUGAR 10 N 65 W 231K  
F. FOX RAN FROM N.W. CORNER SECTION 11 TO WEST 1/4 COR.  
SECTION 14 121.97 , AT STA. 40.66 SET STONE WEST 70.151K  
OAK 7 N 49 E 67.4 1K OAK 5 S 36° E 48.4 1K  
PINE 8 N 26° W 1001K MARKED WITH A CROSS (+) IN THE BARK  
ONLY GROUND SLOPES DOWN WEST FOR ABOUT 30' TO FOOT  
OF SHALLOW RAVINE.

Description of corner evidence found:

I FOUND SQUARE STONE IN GOOD CONDITION & FOX'S WITNESSES AS SHOWN BELOW. I SET A 1" IRON PIPE ALONG NORTH SIDE OF STONE.

Description of monument and accessories I established to perpetuate the original location of this corner:

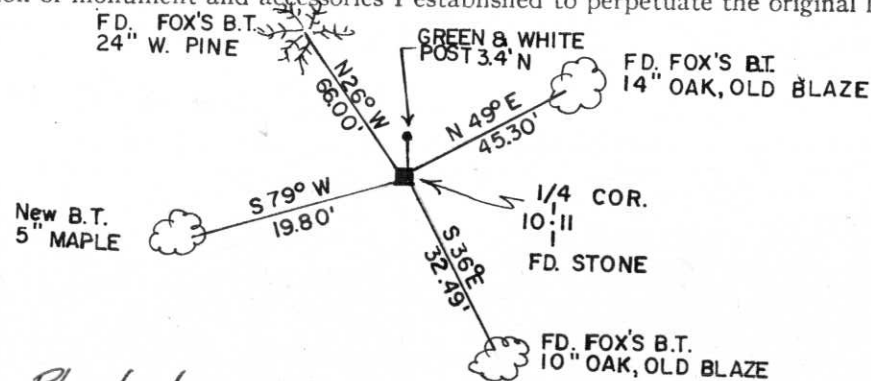

- MAGNETIC BEARINGS WITH HAND COMPASS  
- DISTANCES TO NAIL IN TREE

Dated at Rhinelanders, Wis., this 7th day of April, 1985

Signature Will Immich Title R.L.S. Registration No. 1383  
(County Surveyor, Registered Land Surveyor, or other duly authorized official)

Office of Register of Deeds, County of \_\_\_\_\_, I hereby certify that the within instrument was filed in this office for record on the \_\_\_\_\_ day of \_\_\_\_\_, 19\_\_\_\_ at \_\_\_\_\_ o'clock \_\_\_\_\_ M.

(Register of Deeds)

By \_\_\_\_\_ Deputy