

CERTIFIED LAND CORNER RESTORATION

Index No. H-I, 17

State of Wisconsin }  
County of LINCOLN } ss.

I, William Immich, do hereby certify that on the 6th day of APRIL, 1985, I found evidence of the M.C. NORTH ON HILTS LAKE SECTION 11 corner of SECTION 11 Township 35, North, Range 8 EAST, Fourth, Principal Meridian, as described hereon; and that from this evidence I established a new monument and accessories as described hereon to perpetuate the original location of this corner.

Resident witnesses:

.....  
.....  
.....

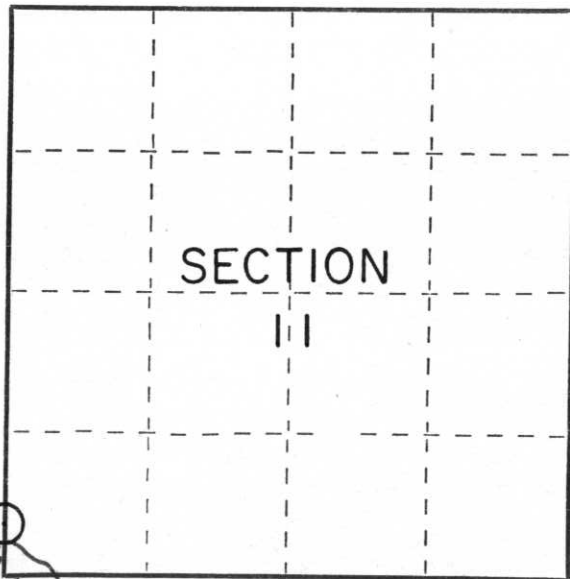

HILTS LAKE  
○ = Corner monument restored.

History of original corner establishment:

1865 NOWLIN GOVT SURVEYOR: NORTH BET 11+12 VAR 8°E  
7.74 OVER LAKE AND SET M.C. BIRCH 8 N 49 W 22IK  
SPRUCE 8 N 46 E 20IK  
F. FOX RAN FROM N.W. COR SEC 11 TO WEST 1/4 COR  
SECTION 14, 121.97, AT STA. 72.23 OFFSET WEST 109.71K  
SET M.C. STONE AT MEAN HIGHWATER MARK W. PINE 6  
N 87E 124.5 IK W. PINE 12 N 18 W 95 IK MOUNDED M.C.  
WITH STONE.

Description of corner evidence found:

I FOUND SQUARE STONE IN GOOD CONDITION & FOX'S WITNESS AS SHOWN BELOW. I SET A 1" IRON PIPE ALONG NORTH SIDE OF STONE.

Description of monument and accessories I established to perpetuate the original location of this corner

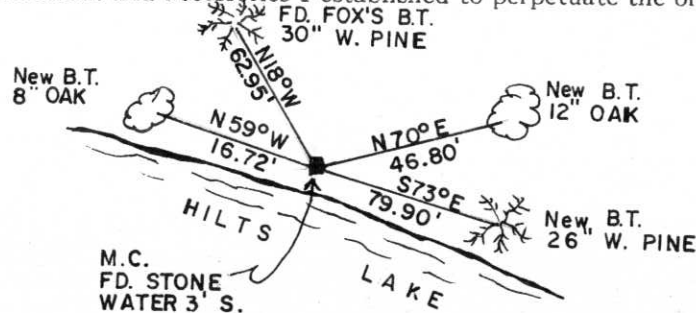

- MAGNETIC BEARINGS WITH HAND COMPASS  
- DISTANCES TO NAIL IN TREE

Dated at Rhinelander, Wis., this 7th day of APRIL, 1985.

Signature William Immich Title R.L.S. Registration No. 1383  
(County Surveyor, Registered Land Surveyor, or other duly authorized official)

Office of Register of Deeds, County of \_\_\_\_\_, I hereby certify that the within instrument was filed in this office for record on the \_\_\_\_\_ day of \_\_\_\_\_, 19\_\_\_\_ at \_\_\_\_\_ o'clock \_\_\_\_\_ M.

(Register of Deeds)

By \_\_\_\_\_ Deputy