

U.S. PUBLIC LAND SURVEY MONUMENT RECORD

Note: This form is intended and designed to fulfill all requirements of Wisconsin Administrative Code, Chapter A-E 5.02, U.S. Public Land Survey Monument Record (3) (a) (b) (c) (d) (e) (f) (g) (h) (i). An additional sheet may be added if necessary to conform with said requirements.

(a) Corner location: Township 34 North

Range 6 East

~~Town~~ City of Tomahawk

County Lincoln

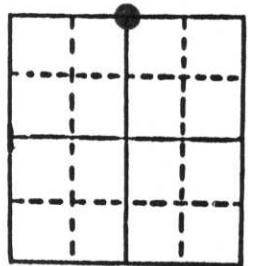

Section 2

b) (f) (g) (h) Description of monument found at this corner and if it was accepted, state all evidence (material, testimonial, occupational, plats, records, other monuments) used as a basis for accepting. If not accepted or if nothing was found, state evidence used as basis for establishing location. If reestablished through lost corner proportionate methods, indicate all monuments, distances and directions used to establish. Original Gov't. Survey: Aug. 1851 by James Marsh, set wood post for corner with bearings, yellow pine 12 S 24° E 34 links & yellow pine 12 S 78° W 42 links. I found a 1½" iron pipe for the corner at the intersection of partially downed old fence lines from the north, south, east & west. Corner is also at the Southeast corner of Atcherson & Larson Subdivision.

c) (d) (e) Plan view of corner with ties to at least 4 witness monuments. If in disagreement with previously established corner, show the distances between the two corners and also indicate the ties to the disputed corner.



Replaced 1½" iron pipe with Berntsen monument. Partial open marsh to the northeast.

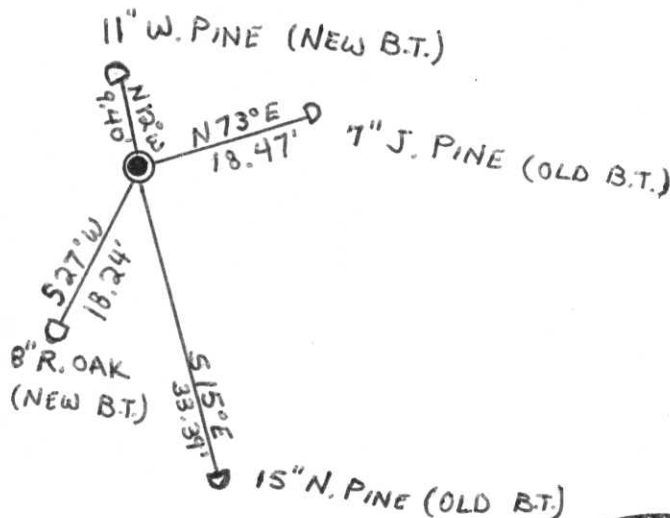

(i) I, Lester J. Schmit
 (type or print name) certify that the corner location on this record was determined by me or under my direction and control and that this U.S. Public Land Survey Monument Record is correct and complete to the best of my knowledge and belief.

Lester J. Schmit
 Signature

7 July 85
 Date



Index No. A-19