

FIELD SURVEY NOTES  
**PRESERVATION OF LANDMARKS**  
(Pursuant to Section 59.635(7) Wisconsin Statutes  
E-D-707-69

State of Wisconsin / Department of Transportation

COUNTY <b>Lincoln</b>		
TOWN <b>Bradley</b>		
HIGHWAY <b>U.S.H. 51 Freeway</b>		
SECTION <b>23</b>	TOWNSHIP <b>T 35 N</b>	RANGE <b>R 6 E</b>
TYPE OF LANDMARK <b>East 1/4 corner</b>		

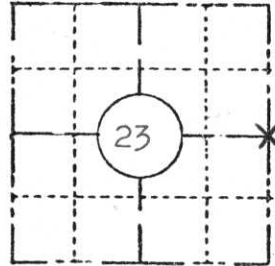

**LOCATION SKETCH**  
(Location of landmark indicated by "x")



This space for copy of field notes or ties to the above described landmarks

Set Berntsen Monument for E 1/4 cor.,  
Sec. 23 by single proportionate  
measurement between NE & SE cor.  
of Sec. 23.

Made new B.T.'s.

Berntsen Monument is flush with  
ground. The corner is in a  
stand of large norway and white  
pine.

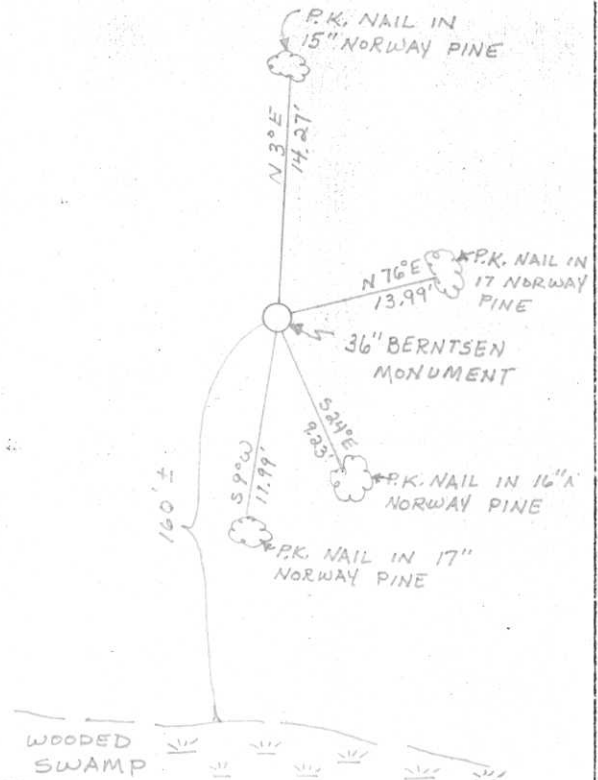

FILED UNDER PROJECT <b>U.S.H. 51 Freeway Number I.D. 1173-3-10</b>		
DISTRICT OFFICE NUMBER <b>7</b>	CITY <b>Tomahawk</b>	COUNTY <b>Lincoln</b>
LOCATED OR ESTABLISHED BY <b>Timberland Surveyors, Inc.</b>		
NAME <i>Lester J. Schmit</i>		
TITLE <b>Land Surveyor S1192</b> DATE <b>Aug. 1978</b>		

COUNTY CLERK'S OFFICE COUNTY OF <b>Lincoln</b> WISCONSIN } SS	
DATE RECEIVED FOR RECORD <b>8/11/78</b>	DATE COPY SENT TO COUNTY SURVEYOR
SIGNATURE OF COUNTY CLERK <i>Ken Oldenburg</i>	

PRESERVATION OF LANDMARKS

PAGE \_\_\_\_\_



RECEIVED AT LINCOLN COUNTY  
COURTHOUSE THIS 14 DAY  
OF August 1978.  
*Pat Ruelke*  
TAX DESCRIPTION OFFICE

0-21