

# Attachment to Tie Sheet U-13, T35N, R5E

43505280000

I visited the corner on 5/30/2019 to verify the corner and reference tie monumentation before Town Road work. I found a surface SMN-1 Nail and all 4 ties from the Matthew Hoglund tie sheet (10/21/2009). The established Coordinates and ties agree with existing monument.

*Anthony R. Dallman* 8/29/19

Anthony R. Dallman, PLS-2405

Lincoln County Surveyor



# U.S. PUBLIC LAND SURVEY MONUMENT RECORD

NOTE: This form is intended and designed to fulfill all requirements of Wisconsin Administrative Code, Chapter A-E 7.08 U.S. Public Land Survey Monument Record (3)(a)(b)(c)(d)(e)(f)(g)(h)(i). An additional sheet may be added if necessary to conform with said requirements.

(a) Corner location: Township 35 North

Range 5 East

Town of Wilson

County of Lincoln

Lincoln County N 232549.517  
Coordinates E 349153.360

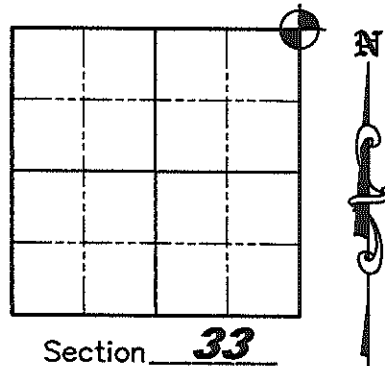

Section 33

(b)(f)(g)(h) Description of monument found at this corner and if it was accepted, state all evidence (material, testimonial, occupation, plats, records, other monuments) used as a basis for accepting. If not accepted or if nothing was found, state evidence used as a basis for establishing location. If reestablished through lost corner proportionate methods, indicate all monuments, distances and directions used to establish. Indicate type of monument found or set and sign post.

September 27, 1862 - Joseph H. Jenkins set wood Section post with bearing trees: White Pine 12° S44°W, 9 links, White Pine 12° N11°W, 45 links

1963 - Owens-Illinois "Staff Compass & Chain Survey using corners found" of Section 34 (per drawing dated 1/2/87 by W.H. Stuth) shows monument "By Others" in place at corner at road intersection.

November 11, 1984 - Certified Land Corner Restoration by Lester Schmit, he "Found a 5/8" iron rod for the corner, below a piece of sheet metal. Corner falls near the intersection of the centerlines of Turkey Farm Road and Zenith Tower Road. Bruce Schreffler, a long time resident verified location as being the corner, having been shown the corner by his father many years ago." Replaced iron rod with Bermtsen Monument - set witnesses: 10" Norway Pine, N40°E, 122.26'; 6" Norway Pine, S65°E, 60.81'; 13" Jack Pine, S56°W, 67.30'; 6" Norway Pine, N8°W, 133.70'.

July-September, 2009 - Matthew E. Hoglund found all 4 witnesses, SE BT was a badly rotted stump with blaze scar visible and NW BT was a stump freshly cut with blaze visible. Had multiple inconsistent weak indications with magnetic locator (none that matched the location by ties), just like the East 1/4 corner 1/4 mile South that I excavated and found the monument broken and disturbed by road reconstruction when Zenith Tower Road was reconstructed several years ago. Called Lester and asked him how he took witness distances back in 1984 and he said he took them to the face of the blaze. Swung ties using blaze faces and had an excellent intersection (once I discovered Lester had a one foot bust in the NE BT distance and that it was actually 121.26') to re-establish corner. Set Bermtsen pavement nail stamped "SURVEY MARK" for corner in pavement, took static post-processed GPS measurements to establish Lincoln County Coordinates and set new witnesses as shown below.

(c)(d)(e) Plan view of corner with ties to at least 4 witness monuments. If in disagreement with previously established corner, show the distances between the two corners and also indicate the ties to the disputed corner.



Basis of Bearings: Magnetic compass bearing to U.S.G.S. monument of S42°00'00"W.

Scale 1" = 60'

Project # 878

## Legend

● Set 7/8" by 30" Iron Rod with Aluminum Cap

⊙ Set Bermtsen pavement spike stamped "SURVEY MARK"

Monument is 2' N. of C/L Turkey Farm Rd. and 1.5' E. of C/L Zenith Tower Rd.

**TURKEY FARM RD.**

**TOWER RD.**

**ZENITH**

16" Jack Pine w/blaze "SC BT" scribing visible

S60°20'42"W 66.41'  
A4.82'  
S42°00'00"W

16" Norway Pine w/blaze "SC BT" scribing visible

N45°34'56"E 119.61'

Note: All witness monuments set approximately 1 foot from the bearing tree.

6" Jack Pine - set BT sign in new blaze

Fd. U.S. Dept. of Interior Geological Survey Brass Cap Benchmark Monument in conc. stamped "4DWB - 1970"

(i) I, Matthew E. Hoglund, certify that the corner location on this record was determined by me under my direction and control and that this U.S. Public Land Survey Monument is correct and complete to the best of my knowledge and belief.

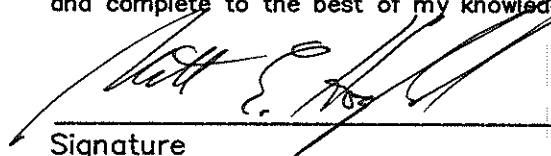
  
Signature \_\_\_\_\_ Date 10/21/2009

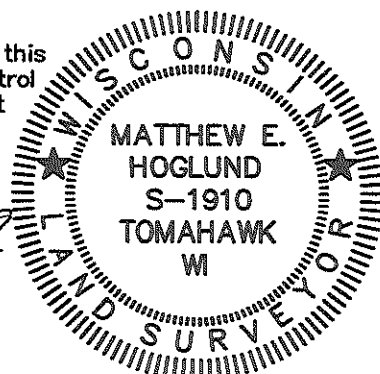

INDEX NO. U-13

CERTIFIED LAND CORNER RESTORATION

Index No. 4-13

State of Wisconsin }  
County of Lincoln } ss.

I Lester J. Schmit, do hereby certify that on the 8<sup>th</sup> day of November, 1984, I found evidence of the Northeast corner of Section 33 Township 35, North, Range 5 East, Fourth, Principal Meridian, as described hereon; and that from this evidence I established a new monument and accessories as described hereon to perpetuate the original location of this corner.

Resident witnesses:

Bruce Schreffler  
.....  
.....

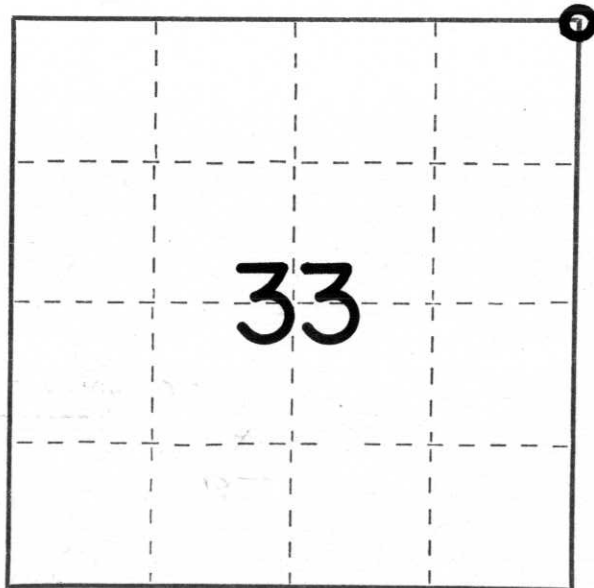

○ = Corner monument restored.

History of original corner establishment:

Surveyor: Joseph W. Jenkins  
Date: 27 September 1862  
Monumentation: Wood Post  
Witnesses: White Pine 12, S 44° W, 9 links  
White Pine 12, N 11° W, 45 links

Description of corner evidence found: Found a 5/8" iron rod for the corner, below a piece of sheet metal. Corner falls near the intersection of the centrelines of Turkey Farm Road and Zenith Tower Road. Bruce Schreffler, a long time resident verified location as being the corner, having been shown the corner by his father many years ago.

Description of monument and accessories I established to perpetuate the original location of this corner.

Set Berntsen monument for the corner to replace the iron rod.  
See reverse side for diagram.

Witnessed by: 10" norway pine, N 40° E, 122.26'  
6" norway pine, S 65° E, 60.81'  
13" jack pine, S 56° W, 67.30'  
6" norway pine, N 8° W, 133.70'

Dated at Tomahawk, Wis., this 11<sup>th</sup> day of November, 1984

Signature Lester J. Schmit Title Land Surveyor Registration No. S-1192  
(County Surveyor, Registered Land Surveyor, or other duly authorized official)

Office of Register of Deeds, County of....., I hereby certify that the within instrument was filed in this office for record on the.....day of....., 19..... at.....o'clock..... M..

.....  
(Register of Deeds)

By.....Deputy