

# U.S. PUBLIC LAND SURVEY MONUMENT RECORD

Note: This form is intended and designed to fulfill all requirements of Wisconsin Administrative Code, Chapter A-E 5.02, U.S. Public Land Survey Monument Record (3) (a) (b) (c) (d) (e) (f) (g) (h) (i). An additional sheet may be added if necessary to conform with said requirements.

(a) Corner location: Township 35 North

Range 4 East

Town/ ~~\_\_\_\_\_~~ Somo

County Lincoln

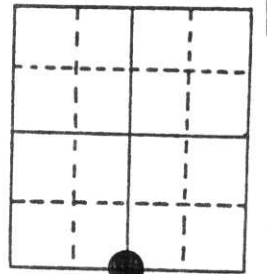

Section 34

(b) (f) (g) (h) Description of monument found at this corner and if it was accepted, state all evidence (material, testimonial, occupational, plats, records, other monuments) used as a basis for accepting. If not accepted or if nothing was found, state evidence used as basis for establishing location. If reestablished through lost corner proportionate methods, indicate all monuments, distances and directions used to establish. Original Gov't. Survey: July 1864 by Alex Anderson, set wood post for corner with bearings, birch 7 N 65° E 7 links & hemlock 12 S 15° W 38 links. During a survey in February 1981 by William Immich of Genisot & Associates, set the corner at the intersection of the centerline of road running east & centerline of County Trunk Highway "T". He made witnesses of a 5" white spruce N 42° E 63.19', 2" maple S 50° E 65.90' & 3" balsam S 38° W 72.60'. I found the 3 witness trees but no monument at the corner. Using the 3 witness trees, I relocated the corner position, set a Berntsen monument at that location and further referenced the corner with 7/8" capped iron rebars as shown below.

**RECEIVED AT LINCOLN COUNTY  
COURTHOUSE THIS 14th DAY  
OF Dec. 1995  
Pat Priske  
TAX DESCRIPTION OFFICE**

(c) (d) (e) Plan view of corner with ties to at least 4 witness monuments. If in disagreement with previously established corner, show the distances between the two corners and also indicate the ties to the disputed corner.

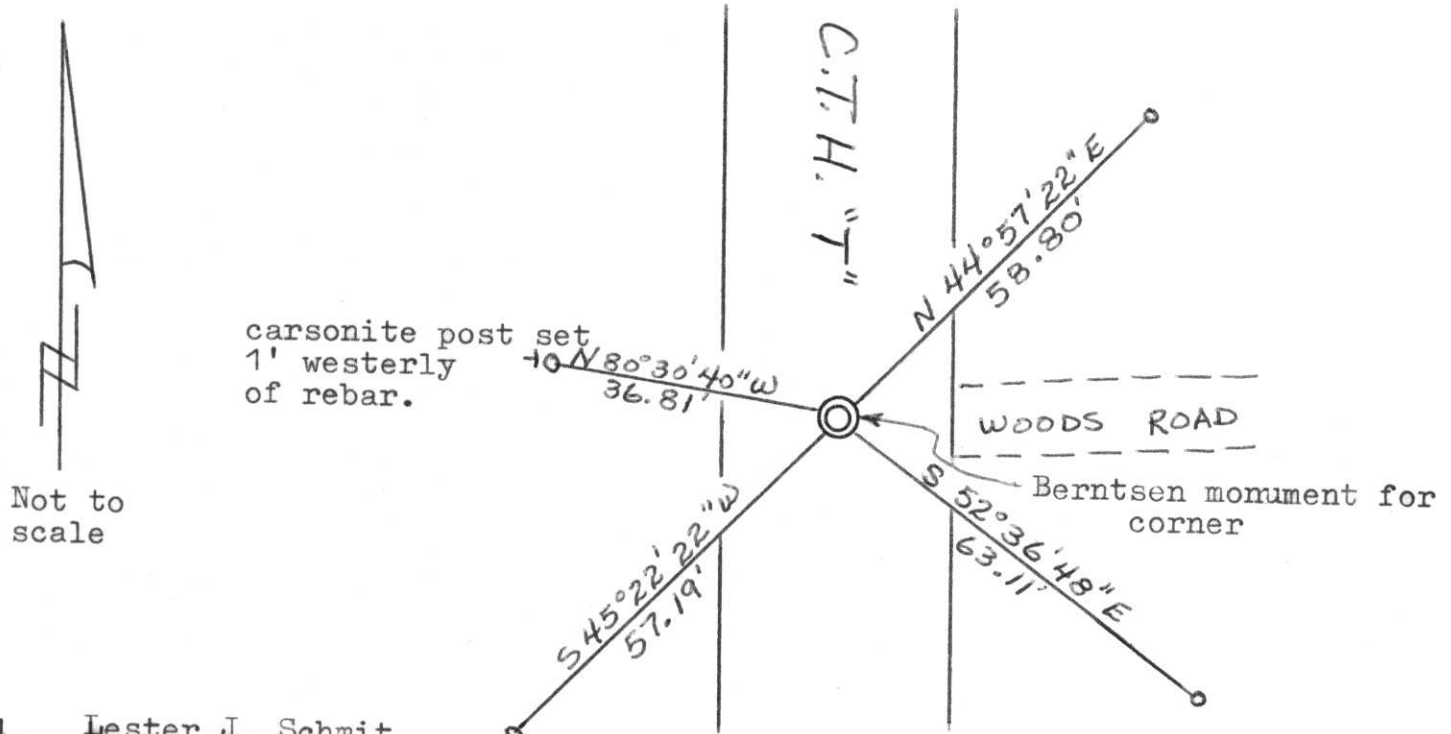

Not to scale

(i) I, Lester J. Schmit

(type or print name) certify that the corner location on this record was determined by me or under my direction and control and that this U.S. Public Land Survey Monument Record is correct and complete to the best of my knowledge and belief.

Lester J. Schmit  
Signature

11 Dec 95  
Date



Index No. 1-15