

CERTIFIED LAND CORNER RESTORATION

Index No. M-5

State of Wisconsin }
County of LINCOLN } ss.

I WILLIAM IMMICH, do hereby certify that on the 27th day of SEPTEMBER, 1982, I found evidence of the SOUTHWEST corner of SECTION 17 Township 35, North, Range 4 EAST, Fourth, Principal Meridian, as described hereon; and that from this evidence I established a new monument and accessories as described hereon to perpetuate the original location of this corner.

Resident witnesses:

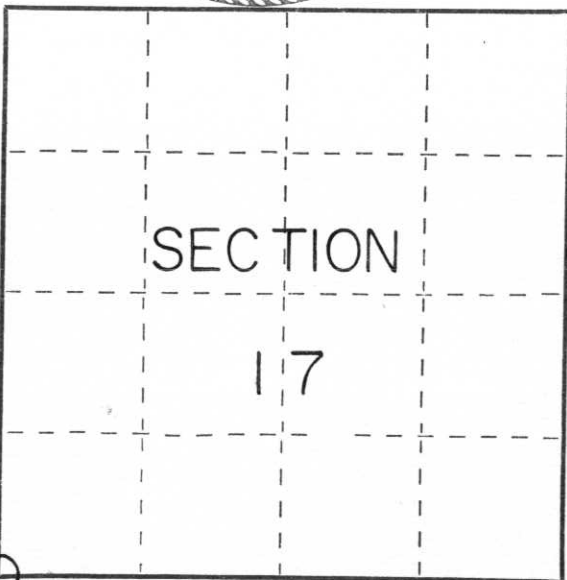

○ = Corner monument restored.

History of original corner establishment:

ORIGINAL GOVERNMENT SURVEY SET CORNER AT 80.00 chs. 1865 A ANDERSON
1923 BURNETT FOUND OLD STAKE, ONE GOIT BT., SET 4x4 CEDAR STAKE
MADE NEW BTs.

Description of corner evidence found:

FOUND IRON PIPE AND REMAINS OF CEDAR POST BEARING TREES IN PLACE
REPLACE IRON PIPE WITH MONUMENT

Description of monument and accessories I established to perpetuate the original location of this corner.

SET LINCOLN COUNTY MONUMENT STAMPED AS SHOWN.

OLD BTs:

10" ELM N36°W 35.1' FACE OF BLAZE

7" ELM N43°E 30.1' FACE OF BLAZE

8" BALSAM S30W 29.8' FACE OF BLAZE

NEW BT:

7" BALSAM S73°E 52.95' PK IN BLAZE

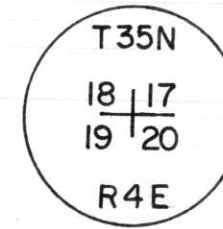

Dated at RHINELANDER, Wis., this 28th day of SEPTEMBER, 1982.

Signature William Immich Title REGISTERED LAND SURVEYOR Registration No. 1383
(County Surveyor, Registered Land Surveyor, or other duly authorized official)

Office of Register of Deeds, County of _____, I hereby certify that the within instrument was filed in this office for record on the _____ day of _____, 19____ at _____ o'clock _____ M.

(Register of Deeds)

By _____ Deputy











