

U S PUBLIC LAND SURVEY MONUMENT RECORD

NOTE: This form is intended and designed to fulfill all requirements of Wisconsin Administrative Code, Chapter A-E 7.08 U.S. Public Land Survey Monument Record (3) (a-i)

A-E 7.08(3)(a) Identity of corner:
 SOUTHEAST CORNER SECTION 24,
 TOWNSHIP 34 NORTH,
 RANGE 08 EAST OF THE 4TH PM,
 TOWN OF HARRISON,
 COUNTY OF LINCOLN

WISCORS - LINCOLN COUNTY
 N: 206,089.459 USft (206,089.490)
 E: 460,324.830 USft (460,324.789)
 Datum: NAD83 (2011)
 GNSS Method RTN - Direct
 GNSS Control WISCORS VRS



The coordinate value shown has been verified by the average of two or more GPS observations at a markedly different time. Coordinates shown in parenthesis are provided by Lincoln County.

A-E 7.08(3)(b)

Original Surveyor: James M. Marsh

| | | | | | |
|-------------------------|------------|-----------------|-----------------------|-----------|-------------|
| Date of Original Survey | Commenced: | August 12, 1851 | Original Accessories: | | |
| | Completed: | August 18, 1851 | Witness Corner | South | 0.40 Chains |
| | | | Spruce | 10 S 2° E | 4.28 Links |
| | | | Spruce | 10 S 2° W | 4.66 Links |

1937 - Surveyors - Kilroe and Hintz - indicate this position as "Set Sec. cor. in the river close to N. or W. shore...at 4.545 chs. set W.C. to sec. cor. 19-24-25-30 " on field notes supplied by Lincoln County.

January 27, 1971 - Surveyor - Joseph C. Kirby - indicates this position being "S1°12'E, 301.45' from the Witness Corner" on Lincoln County map M610B.

April 15, 1991 - Surveyor 1192 - Lester J. Schmidt - indicates this position on Lincoln County map M297A. Schmidt does not provide a description of the monument.

December 22, 2003 - Surveyor 2656 - Jeffrey L. DeMuth - indicates this position as "falls in river N 206089.49 E 460324.79" on Lincoln County Section Summary - Section 24, Township 34 North, Range 8 East.

November 29, 2022 - While performing the 2022 Lincoln County PLSS Corner Remonumentation and GPS Services project, I went to the coordinate position provided by Lincoln County, I made a careful search of the area and found no evidence of the corner. I did find a 4" diameter iron pipe with a 4" diameter brass cap stamped W.C. (See U.S. Public Land Survey Monument Record P,Q -25)

Under the direction of Lincoln County, I restored the corner using coordinates provided by Lincoln County and set a Berntsen aluminum "swamp monument" being a 1" diameter x 50" long aluminum pipe with a 2.5" diameter aluminum cap. I established 4 new reference monuments as shown below.

A-E 7.08(3)(c)(d) Plan view of corner with references to at least 4 witness monuments.

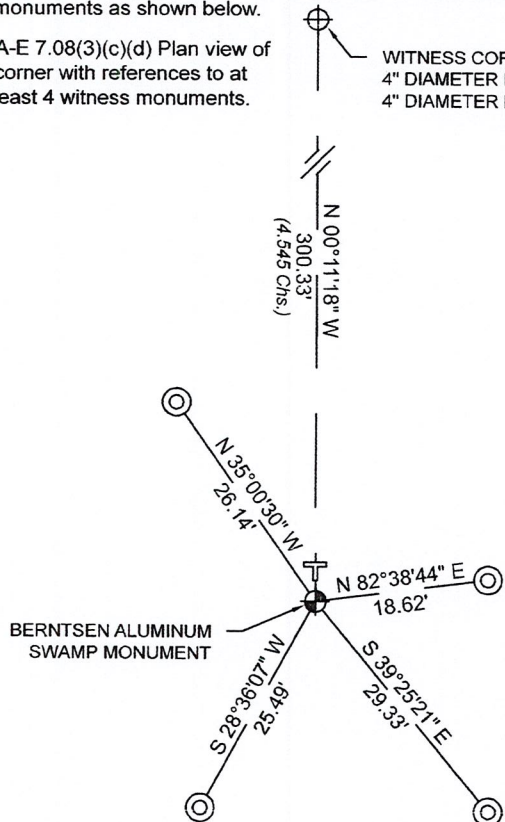

BEARINGS LISTED TO THE NEAREST SECOND ARE REFERENCED TO WISCONSIN COUNTY COORDINATE REFERENCE SYSTEM - LINCOLN COUNTY ZONE. ALL OTHER BEARINGS ARE MAGNETIC



RECEIVED BY LINCOLN COUNTY
 SURVEYOR THIS 27TH DAY
 OF December 20 22
Jeffrey DeMuth
 COUNTY SURVEYOR

LEGEND

- 1" diameter x 50" long aluminum pipe monument with a 2.5" diameter aluminum cap, set
- 1" diameter X 32" long aluminum pipe with 2.5" diameter aluminum cap, set
- Vinyl T-post, set ±2 feet north of corner

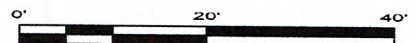

A-E 7.08(3)(e) 1851 Surveyor set a post, 1937 Surveyors set corner in river, 1991 Surveyor calculates position, 1991 Surveyor calculates position, 2003 Surveyor calculates position. I set a Berntsen aluminum monument.

A-E 7.08(3)(f) I restored the corner through ACCEPTANCE OF AN OBLITERATED LOCATION.

A-E 7.08(3)(g)(h) This corner was not determined through lost-corner-proportionate methods.

A-E 7.08(3)(i) I, Jeffrey L. DeMuth, Professional Land Surveyor No. S-2656, hereby certify that the corner location on this record was determined by the Lincoln County Surveyor, and the monuments found or set as shown hereon were measured by me or under my direction and control, and that this U.S. Public Land Survey Monument Record is correct and complete to the best of my knowledge, and belief.

Jeffrey L. DeMuth
 SIGNATURE
 December 14, 2022
 DATE



Q-25

REPORT

2022-Lincoln County PLSS Corner Remonumentation and GPS Services

Wisconsin Corner Point Identification Number: 43408240000

Surveyor: Jeffrey L. DeMuth – S2656

Corner monument: Set Berntsen aluminum "swamp monument", 1" diameter x 50" long with a 2.5" diameter cap at coordinates provided.

Field Book: Cardinal North – Lincoln Co. Remon. – 2022-00

Page: 69

Horizontal Datum: WisCRS – Lincoln County Zone – NAD83(2011)

Date / time of initial measurement:

November 29, 2022 - Start 10:13:04 CST – End 10:41:10 CST

Reference monuments:

4 – Set - 1" diameter X 32" long aluminum pipe with 2.5" diameter Lincoln Co. aluminum cap.

1 – Found – 4" diameter iron pipe with 4" brass capped witness.

Coordinate Table



| | County Provided | 2022 Measurement | Difference |
|-------|-----------------|------------------|------------|
| North | 206089.490 | 206089.459 | 0.03 |
| East | 460324.789 | 460324.830 | -0.04 |

Established coordinates match existing calculated coordinates within reason.

Request Data Log for more information.

Additional Notes:

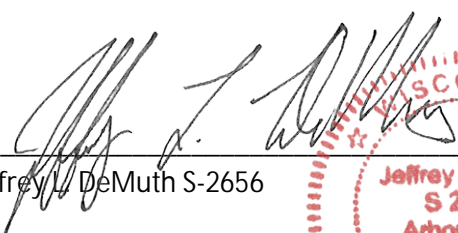
Corner falls ±50 feet north of the north bank of the Prairie River.

 Jeffrey L. DeMuth S-2656
 
 December 01, 2022
 Date

43408240000_Mon-N



43408240000_North



4340824000_West



4340824000_South

PLEASE
DO NOT
DISTURB
NEARBY

| | |
|---|---|
| S | M |
| U | R |
| R | R |
| V | K |
| E | E |
| Y | Y |

IF THE LOCATION
OF THIS MARKER
IS ENDANGERED
PLEASE CONTACT
COUNTY
SURVEYOR'S
OFFICE

A
3
4
-
0
8
2
4
-
0
0
0
0



43408240000_East

