

| | | |
|--------------------------------------|--------------------|----------------|
| COUNTY Lincoln | | |
| TOWN Skanawan | | |
| HIGHWAY U.S.H. 51 Freeway | | |
| SECTION 19 | TOWNSHIP T 34 N | RANGE R 7 E |
| TYPE OF LANDMARK South 1/4 corner | | |

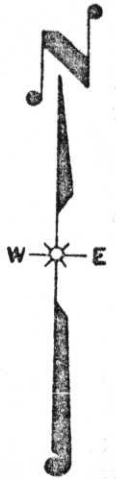
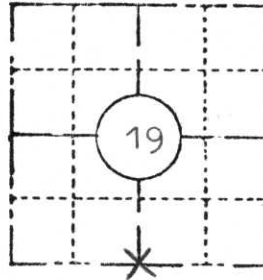

LOCATION SKETCH
 (Location of landmark indicated by "x")

This space for copy of field notes or ties to the above described landmarks

Set Berntsen Monument for S 1/4 cor.,
 Sec. 19 by single proportionate
 measurement between SE & SW cor.
 of Sec. 19 using original Gov't.
 notes.

Distance between SE & SW cor.,
 Sec. 19 obtained from map of
 Leonard L. Lampert.

Made new B.T.'s

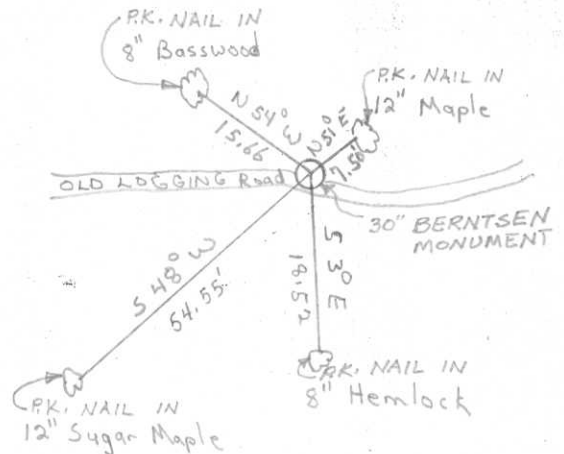

| | | |
|--|------------------|-------------------|
| FILED UNDER PROJECT U.S.H. 51 Freeway Number I.D. 1173-3-10 | | |
| DISTRICT OFFICE NUMBER 7 | CITY Tomahawk | COUNTY Lincoln |
| LOCATED OR ESTABLISHED BY Timberland Surveyors, Inc. | | |
| NAME <i>Lester J. Schmit</i> | | |
| TITLE Land Surveyor S1192 | | |
| DATE Aug. 1978 | | |

| | |
|--|-----------------------------------|
| COUNTY CLERK'S OFFICE COUNTY OF <i>Lewis</i> WISCONSIN } SS | |
| DATE RECEIVED FOR RECORD 8/11/78 | DATE COPY SENT TO COUNTY SURVEYOR |
| SIGNATURE OF COUNTY CLERK <i>Ken Oleary</i> | |

PRESERVATION OF LANDMARKS

PAGE _____



RECEIVED AT LINCOLN COUNTY
 COURTHOUSE THIS 14 DAY
 OF August 1978
Pat Riecke
 TAX DESCRIPTION OFFICE

Q-3