

U.S. PUBLIC LAND SURVEY MONUMENT RECORD

Note: This form is intended and designed to fulfill all requirements of Wisconsin Administrative Code, Chapter A-E 5.02, U.S. Public Land Survey Monument Record (3) (a) (b) (c) (d) (e) (f) (g) (h) (i). An additional sheet may be added if necessary to conform with said requirements.

(a) Corner location: Township 34 North

Range 6 East

Town Bradley

County Lincoln

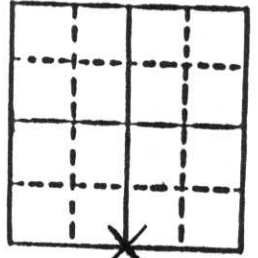

Section 35

b) (f) (g) (h) Description of monument found at this corner and if it was accepted, state all evidence (material, testimonial, occupational, plats, records, other monuments) used as a basis for accepting. If not accepted or if nothing was found, state evidence used as basis for establishing location. If reestablished through lost corner proportionate methods, indicate all monuments, distances and directions used to establish.

Found 8"x8" granite stone in place. Stone was set by F. Fox. Also found 1/16 corner and SW corner which confirmed stone location by distance and direction. Have submitted section summary.

c) (d) (e) Plan view of corner with ties to at least 4 witness monuments. If in disagreement with previously established corner, show the distances between the two corners and also indicate the ties to the disputed corner.

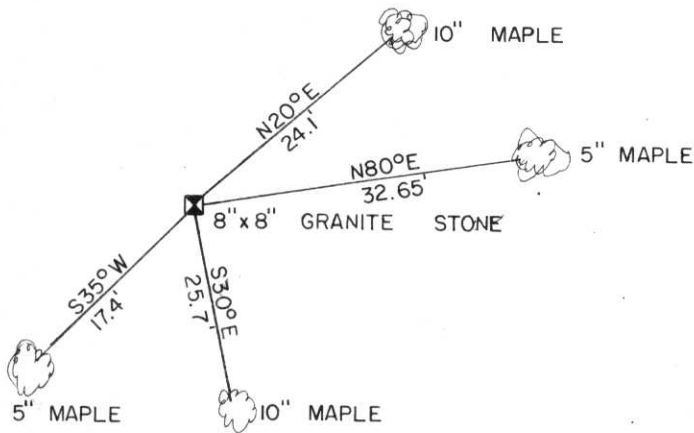

RECEIVED AT LINCOLN COUNTY
 COURTHOUSE THIS 27 DAY
 OF July 1986
 TAX DESCRIPTION OFFICE

Edwin R. Abendroth RLS No. S-798

(i) I, _____
 (Type or print name) certify that the corner location on this record was determined by me or under my direction and control and that this U.S. Public Land Survey Monument Record is correct and complete to the best of my knowledge and belief.

Signature _____

Date _____



Index No 61-19



23 2:26 PM



23 236PK



23 2:36 PM