

# U.S. PUBLIC LAND SURVEY MONUMENT RECORD

**Note:** This form is intended and designed to fulfill all requirements of Wisconsin Administrative Code, Chapter A-E 5.02, U.S. Public Land Survey Monument Record (3) (a) (b) (c) (d) (e) (f) (g) (h) (i). An additional sheet may be added if necessary to conform with said requirements.

(a) Corner location: Township 33 North  
 Range 6 East

Town Rock Falls  
 County Lincoln

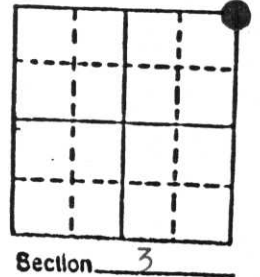

b) (f) (g) (h) Description of monument found at this corner and if it was accepted, state all evidence (material, testimonial, occupational, plats, records, other monuments) used as a basis for accepting. If not accepted or if nothing was found, state evidence used as basis for establishing location. If reestablished through lost corner proportionate methods, indicate all monuments, distances and directions used to establish. Original Gov't. Survey: Aug. 1851 by James M. Marsh, set wood post for corner with bearings, aspen 10 S 89 E 18 links, hemlock 10 S 1 W 33 links, birch 8 N 10 W 33 links & birch 11 N 41 E 33 links. On a survey by Francis Fox for the Town of Rock Falls in the 1930's, he set a 6"x6" red granite monument for the corner. Stone dug for but not found per C.S.M. # 370, and set a 1" iron rod at S 12° W, 22' from oak B.T. per F. Fox notes. I found the 1" iron rod in the center of a traveled way along the north edge of an open field, with the stump of the oak still in place. Set a Berntsen monument to replace the 1" iron rod for the corner and referenced as shown below.

c) (d) (e) Plan view of corner with ties to at least 4 witness monuments. If in disagreement with previously established corner, show the distances between the two corners and also indicate the ties to the disputed corner.

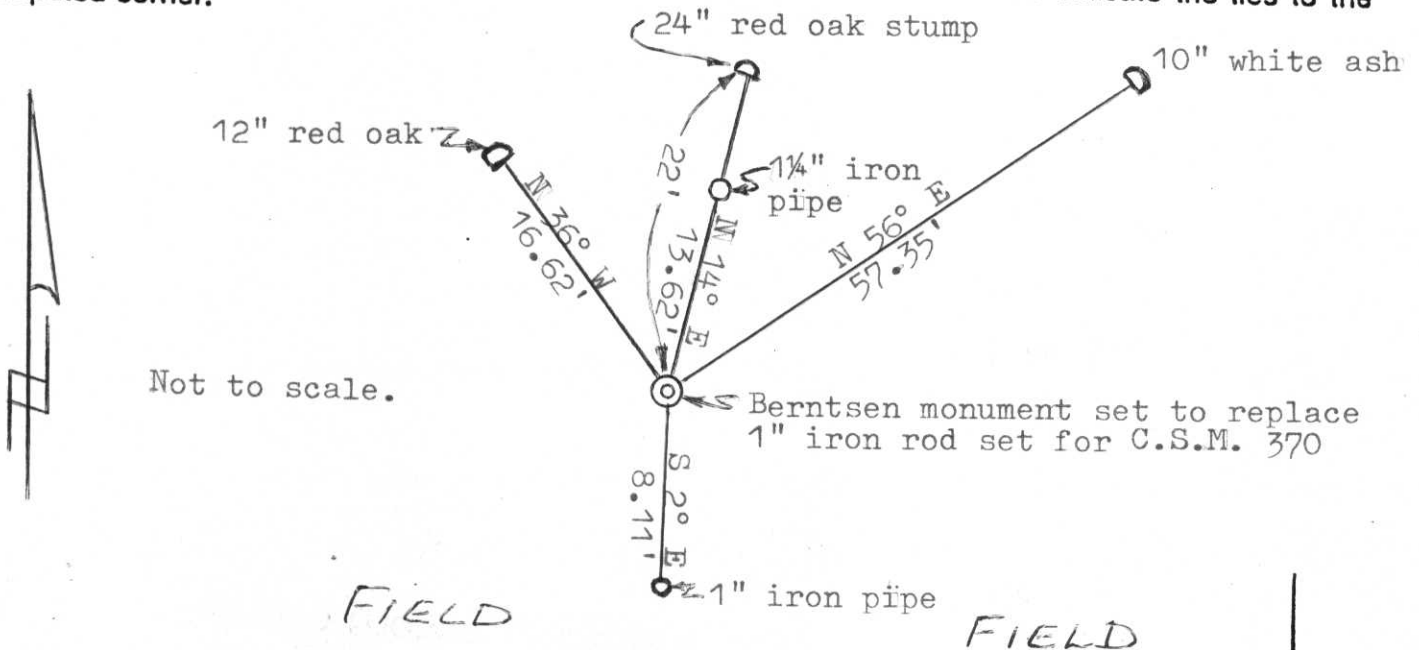

(i) I, Lester J. Schmit  
 (type or print name) certify that the corner location on this record was determined by me or under my direction and control and that this U.S. Public Land Survey Monument Record is correct and complete to the best of my knowledge and belief.

Lester J. Schmit 10 Dec 90  
 Signature Date



Index No. R-17