

U.S. PUBLIC LAND SURVEY MONUMENT RECORD

Note: This form is intended and designed to fulfill all requirements of Wisconsin Administrative Code, Chapter A-E 5.02, U.S. Public Land Survey Monument Record (3) (a) (b) (c) (d) (e) (f) (g) (h) (i). An additional sheet may be added if necessary to conform with said requirements.

(a) Corner location: Township 34 North

Range 6 East

Town/City/Village Town of Bradley

County Lincoln

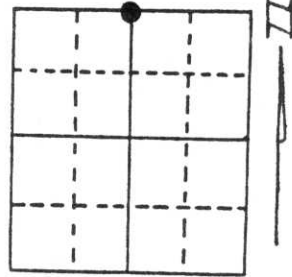

Section 10

(b) (f) (g) (h) Description of monument found at this corner and if it was accepted, state all evidence (material, testimonial, occupational, plats, records, other monuments) used as a basis for accepting. If not accepted or if nothing was found, state evidence used as basis for establishing location. If reestablished through lost corner proportionate methods, indicate all monuments, distances and directions used to establish.

- December 29, 1954: Original G.L.O. survey by Jackson L. Prentice.
- March 7, 1977: Lester J. Schmit found 1 1/2" pipe in roadway. He accepted corner position and remonumented corner with Lincoln County Bernsten aluminum monument.
- August 11, 1992: I, John R. Garske, found Lester J. Schmit's Bernsten monument in roadway. Top of monument had been broken off. Construction operations at Louisiana Pacific Waferboard Plant were going to obliterate monument and accessories. Additional accessories outside the construction limits were established.

(c) (d) (e) Plan view of corner with ties to at least 4 witness monuments. If in disagreement with previously established corner, show the distances between the two corners and also indicate the ties to the disputed corner.

August 10, 1993: Set new Lincoln County aluminum monument from accessories established in 1992. Monument sits on backslope of ditch.

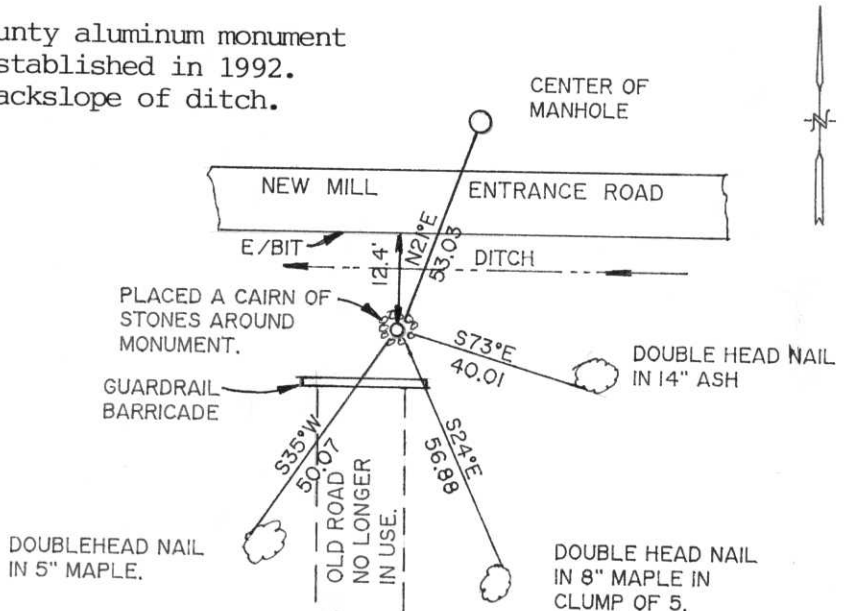

RECEIVED AT LINCOLN COUNTY
COURTHOUSE THIS 21st DAY
OF January 1994
Pat Pube
TAX DESCRIPTION OFFICE

(i) I, John R. Garske
(type or print name) certify that the corner location on this record was determined by me or under my direction and control and that this U.S. Public Land Survey Monument Record is correct and complete to the best of my knowledge and belief.

John R. Garske
Signature

1/20/94
Date



Index No. E-15

CERTIFIED LAND CORNER RESTORATION

Index No. E-15

State of Wisconsin }
County of Lincoln } ss.

History of original corner establishment:

Surveyor: Jackson L. Prentice
Date: 29 December 1854
Monumentation: Wood Post
Witnesses: Pine 10; N 3° E; 24 links
Pine 18; S 42° W; 50 links

I Lester J. Schmit do hereby certify that on the 7th day of March, 1977, I found evidence of the North ¼ corner of Section 10 Township 34, North, Range 6 East, Fourth, Principal Meridian, as described hereon; and that from this evidence I established a new monument and accessories as described hereon to perpetuate the original location of this corner.

Description of corner evidence found: 1½" iron pipe, 5" below surface of road for North ¼ corner, Section 10. Corner is 2' east of centreline of road north and south, and on the south edge of road east.

Resident witnesses:

Witness: 2" iron pipe; N 80°15'18" W; 33.30'

.....
.....
.....

Description of monument and accessories I established to perpetuate the original location of this corner.

Berntsen Monument - 30" (Set 1" below surface of road, to replace the 1½" iron pipe as North ¼ corner, Section 10.)

Witnesses: 1" iron pipe; N 35°43'45" E; 54.31'
P.K. Nail in 5" Cherry; S 29°42'05" E; 45.37'
P.K. Nail in Power Pole # 3103; S 18°59'21" W; 102.13'
P.K. Nail in Power Pole # 3104; N 64°54'51" W; 37.72'

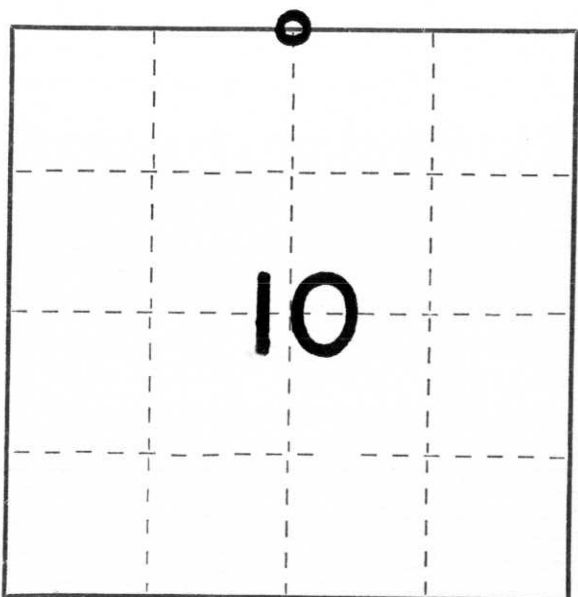

○ = Corner monument restored.

Dated at Tomahawk, Wis., this 31st day of March, 1977

Signature Lester J. Schmit Title Land Surveyor Registration No. S-1192
(County Surveyor, Registered Land Surveyor, or other duly authorized official)

Office of Register of Deeds, County of _____, I hereby certify that the within instrument was filed in this office for record on the _____ day of _____ 19____ at _____ o'clock _____ M.

(Register of Deeds)

By _____ Deputy

RECORDED & INDEXED
MARCH 31 1977
COUNTY CLERK
LINCOLN COUNTY, WISCONSIN