

# LINCOLN COUNTY U.S. PUBLIC LAND SURVEY MONUMENT LOCATION RECORD

SECTION 1  
TOWNSHIP 34 N  
RANGE 5 E

**E-23**  
NO.

LANDMARK       BENCHMARK  
CORNER IDENTITY: BERNTSEN SNM1 STEEL NAIL MARKER  
FOUND   
SET   
RESET   
RE-TIED

LINCOLN COUNTY COORDINATE: N: 222294.906  
E: 362335.632

ELEVATION-(FEET): \_\_\_\_\_ DATUM: 83 (2011)

WEATHER: P. CLOUDY

DATE OF SURVEY: 07/02/2019 TEMPERATURE: 80 °F

SURVEY PARTY: KEITH WALKOWSKI AND AUSTIN PELOT

TOMAHAWK

CITY, VILLAGE, TOWN

SECTION

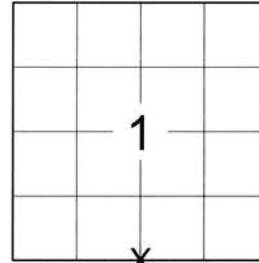

LOCATION  
(Indicated By X)



## BASIS FOR MONUMENT LOCATION:

(DESCRIBE METHOD OF SURVEY AND CORNER AUTHENTICATION)

SEARCHED FOR THE SOUTH 1/4 CORNER OF SECTION 1 BEFORE THE START OF THE RESURFACING PROJECT ON HWY "86" AND FOUND 5 OUT OF 8 TIES ALONG WITH A SMP NAIL FROM THE 2015 TIE SHEET BY ANTHONY DALLMAN. UPON COMPLETION OF THE STH 86 RESURFACING PROJECT SET A BERNTSEN SNM1 STEEL NAIL MARKER AT THE CORNER AND SET 2 ADDITIONAL TIES TO PERPETUATE THE CORNER LOCATION AS SHOWN BELOW.

FIELD BOOK NO. NA PAGE NO. NA  
COMPANY RIVERSIDE LAND SURVEYING LLC

CERTIFIED CORRECT:

*Keith J. Walkowski*

KEITH J. WALKOWSKI S-2717  
Professional Land Surveyor

DATE: OCTOBER 15TH, 2019

## TIE SKETCH:

- SET BERNTSEN SNM1 STEEL NAIL MARKER
- FOUND ALUMINUM CAPPED REBAR
- FOUND PLASTIC CAPPED REBAR
- FOUND 1.5" O.D. IRON PIPE
- SET VINYL "T" POST
- FOUND RW POST

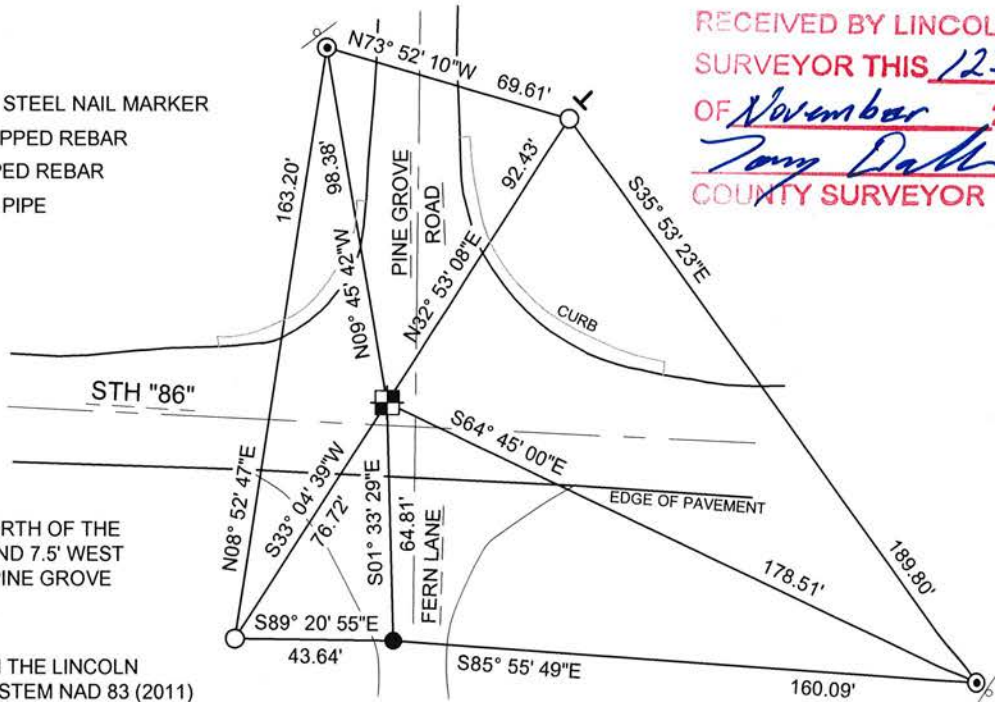

RECEIVED BY LINCOLN COUNTY  
SURVEYOR THIS 12TH DAY  
OF November 20 19  
*Tony Dallman*  
COUNTY SURVEYOR

NOTE: CORNER LIES 6' NORTH OF THE CENTERLINE OF STH 86 AND 7.5' WEST OF THE CENTERLINE OF PINE GROVE ROAD.

BEARINGS ARE BASED ON THE LINCOLN COUNTY COORDINATE SYSTEM NAD 83 (2011) AND REFERENCED AS SHOWN

THIS DRAWING IS NOT TO SCALE

**E-23**  
NO.

# U.S. PUBLIC LAND SURVEY MONUMENT RECORD

NOTE: THIS FORM IS INTENDED AND DESIGNED TO FULFILL ALL REQUIREMENTS OF WISCONSIN ADMINISTRATIVE CODE, CHAPTER A-E 7.08, U.S. PUBLIC LAND SURVEY MONUMENT RECORD (3)(a)(b)(c)(d)(e)(f)(g)(h)(i). ADDITIONAL SHEETS MAY BE NECESSARY TO CONFORM TO SAID REQUIREMENTS.

T 34 N, R 5 E

**(a) CORNER LOCATION:**

SOUTH QUARTER CORNER, SECTION 1  
 TOWNSHIP 34 NORTH  
 RANGE 5 EAST  
 TOWN OF TOMAHAWK  
 LINCOLN COUNTY  
 WISCONSIN

**(b) HISTORY OF ORIGINAL CORNER:**

ORIGINAL SURVEYOR: Jackson L. Prentice, Set post  
 COMMENCING DATE: July 6, 1855  
 COMPLETION DATE: July 12, 1855  
 ORIGINAL BEARING TREES:  
 9" Maple; S 2° W; 10 links  
 15" Hemlock(?); N 7° W; 20 links

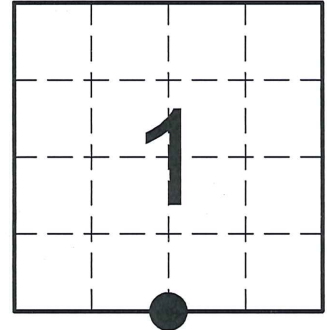

**(f)(g)(h) DESCRIPTION OF MONUMENT FOUND AT THIS CORNER AND IF IT WAS ACCEPTED. STATE ALL EVIDENCE (MATERIAL, TESTIMONIAL, OCCUPATIONAL, PLATS, RECORDS, OTHER MONUMENTS) USED AS A BASIS FOR ESTABLISHING LOCATION. IF RE-ESTABLISHING THROUGH LOST CORNER PROPORTIONATE METHODS, INDICATE ALL MONUMENTS, DISTANCES, AND DIRECTIONS USED TO ESTABLISH. INDICATE TYPE OF MONUMENTS FOUND OR SET.**

11/19/1974 - R. Winat, PLS-1040, found an old Iron Monument in the centerline of the right-of-way obtained by measuring from fences. Notes that there is a definite bend in the road and fences here. He replaced the Iron Monument with a Berntsen Aluminum Monument, 4' north of the centerline of S.T.H. "86". He made reference ties to perpetuate the corner location.

04/09/1991 - R. Johnson, WisDOT survey crew chief, found the Berntsen Aluminum Monument and set four new reference ties to further perpetuate the corner location.

06/22/1998 - L. Schmit, PLS-1192, set a Mag Nail for the corner, shown on Lincoln County Surveyor's Office Map No. L253B.

07/18/2013 - I, Anthony R. Dallman, PLS-2405, found no monument at the corner location. I set a Berntsen Survey Marker Nail using an existing 1974 tie and an existing 1991 tie. I set two new reference ties and measured to other existing monuments for reference ties to further perpetuate the corner location, as shown in the sketch below.

**(c)(d)(e) PLAN VIEW OF THE CORNER WITH TIES TO AT LEAST FOUR WITNESSES. IF IN DISAGREEMENT WITH PREVIOUSLY ESTABLISHED CORNER, SHOW THE DISTANCES BETWEEN THE TWO CORNERS AND ALSO THE TIES TO THE DISPUTED CORNER.**



- Bearings by hand-held compass.  
 - Distances by steel tape.

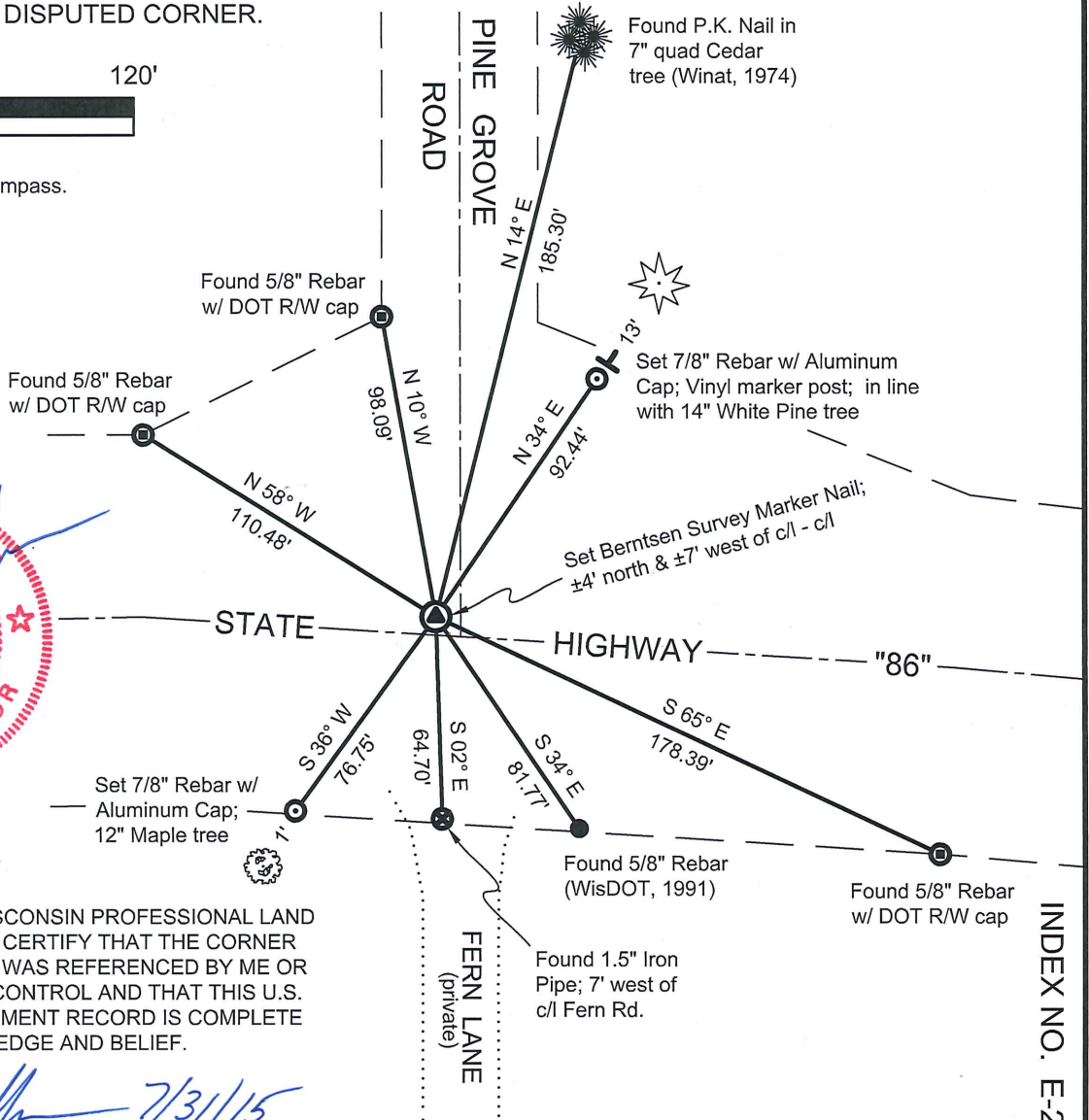
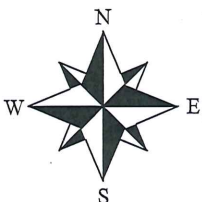

**WISCONSIN**  
 ANTHONY R. DALLMAN  
 S-2405  
 MERRILL, WI  
 LAND SURVEYOR  
 7/31/15

I, ANTHONY R. DALLMAN, WISCONSIN PROFESSIONAL LAND SURVEYOR, S-2405, HEREBY CERTIFY THAT THE CORNER LOCATION ON THIS RECORD WAS REFERENCED BY ME OR UNDER MY DIRECTION AND CONTROL AND THAT THIS U.S. PUBLIC LAND SURVEY MONUMENT RECORD IS COMPLETE TO THE BEST OF MY KNOWLEDGE AND BELIEF.

*Anthony R. Dallman* 7/31/15  
 ANTHONY R. DALLMAN, PLS S-2405

INDEX NO. E-23

**RECORD AND CERTIFICATION OF U.S. PUBLIC LAND SURVEY CONTROL STATION**

State of Wisconsin / Department of Transportation

E-D-716-72

District 7	Project I. D. 9215-06-00	Located by R.B. JOHNSON - SURVEY CREW CHIEF			
Corner 5 1/4 COR L SECTION	Township 34 N	Range (E,W) 5 E	County LINCOLN		
Wisconsin Coordinates CORNER	East (X) 2,049,811.86	North (Y) 590,943.00	Elevation (Z)	Zone C	
Control Station Name	East (X)	North (Y)	Elevation (Z)	Zone	
Horizontal — NORTH AMERICAN, 1927		CONTROL DATUM Vertical — MEAN SEA LEVEL, 1929 ADJUSTMENT			
Horizontal — 2ND Order		SURVEY CONTROL		Vertical — _____ Order	

**SKETCH**

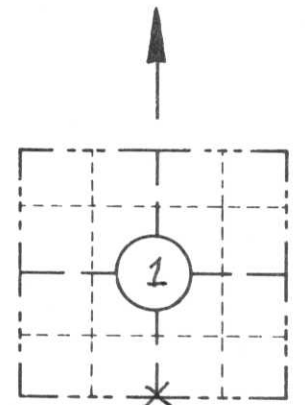

**LOCATION SKETCH**

(Location of landmark indicated by "X")

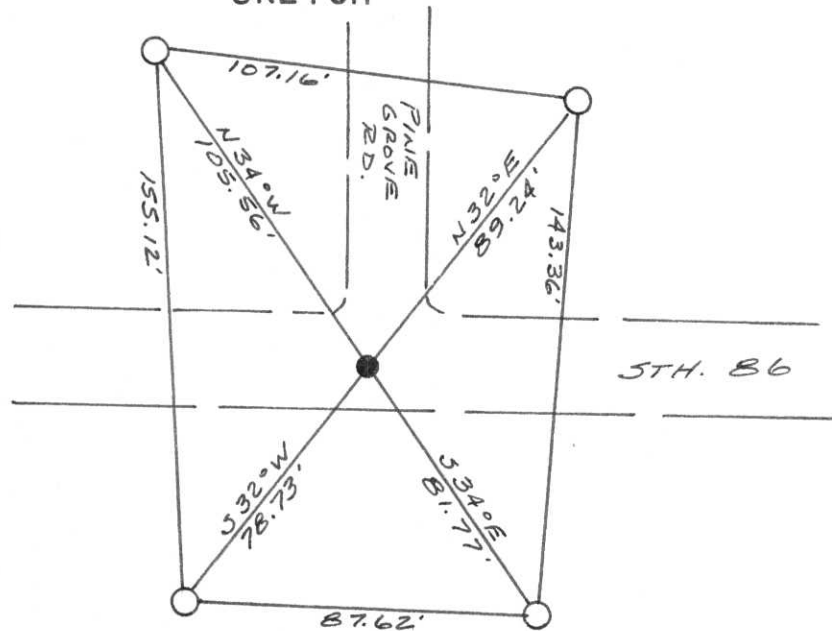

CORNER  
5 1/4 COR

SECTION  
1

TOWN  
34 N

RANGE  
5 E

I hereby certify that on the 9TH day of APRIL 1991, that I did locate the above corner which was evidenced by A BERNTSEN ALUMINUM MONUMENT

; I further certify that to perpetuate the location of such corner I did, at the exact location thereof, place a permanent marker consisting of \_\_\_\_\_

; I further certify that I did establish 4 references or witness monuments consisting of 5/8" X 24" RE-BARS WITH RED PLASTIC D.O.T. CAPS

located as shown above:

**SEAL**

Signature Registered Land Surveyor	Registration No. S--	Title
------------------------------------	-------------------------	-------

N 1/4 Sec 12  
T34N R5E

State of Wisconsin / Department of Transportation

RECEIVED JUN 18 1991

FIELD SURVEY NOTES

E.D-702 6-70

CORNER E 23 T34N-R5E  
36" REBAR W/ RED CAP

APRIL 9 1991

RBT, SM, GS, BT

E-23

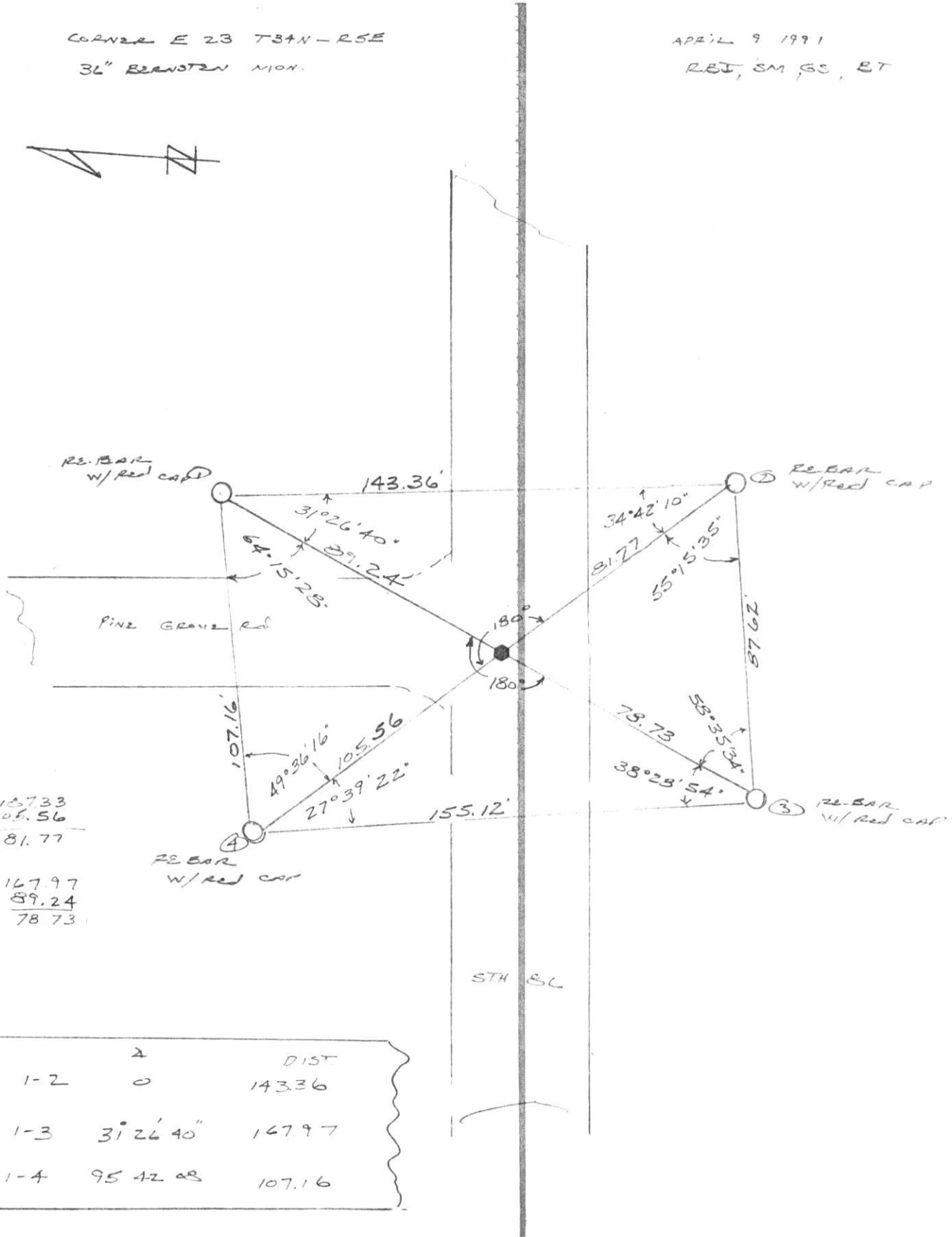

127.33  
105.56  
-----  
81.77

167.97  
89.24  
-----  
78.73

	Δ	DIST
1-2	0	143.36
1-3	31°26'40"	147.97
1-4	95°42'08"	107.16

- TOPOGRAPHY
- SURVEY ALIGNMENT

FIELD SURVEY NOTES

E-D-702 6-70

CORNER E 23 T34N-R5E  
36" BERNSTEIN MON.

APRIL 9 1991  
REI, SM, GS, ET

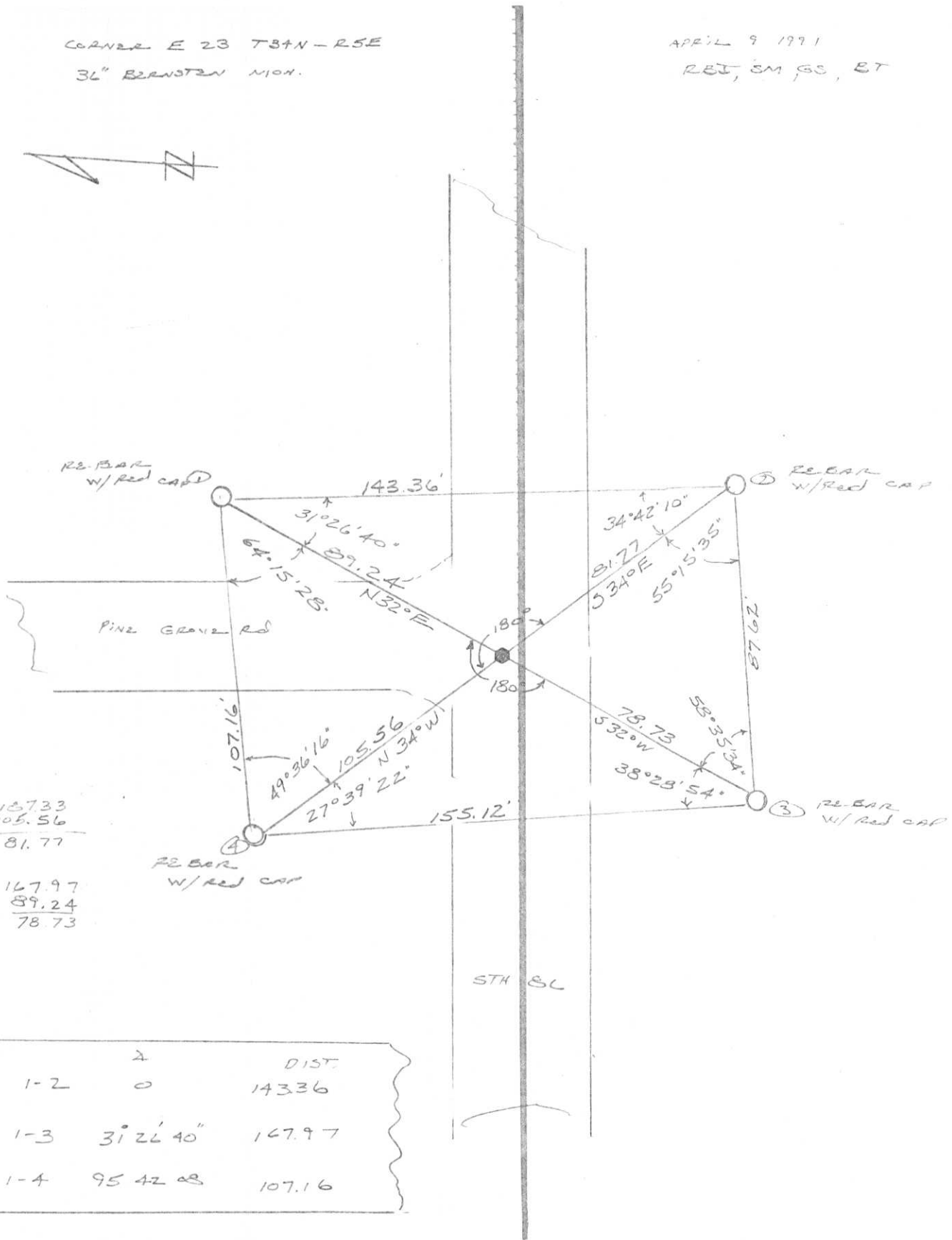

127.33  
105.56  
-----  
81.77

167.97  
89.24  
-----  
78.73

	Δ	DIST.
1-2	0	143.36
1-3	31°26'40"	167.97
1-4	95°42'08"	107.16

- TOPOGRAPHY
- SURVEY ALIGNMENT

CERTIFIED LAND CORNER RESTORATION

Index No. E-23

State of Wisconsin }  
County of LINCOLN } ss.

I ROBERT H. WINAT, do hereby certify that on the 8th day of January, 19 74, I found evidence of the North 1/4 corner of Section 12 Township 34, North, Range 5 East, Fourth, Principal Meridian, as described hereon; and that from this evidence I established a new monument and accessories as described hereon to perpetuate the original location of this corner.

Resident witnesses:

Roger Hilt  
\_\_\_\_\_  
\_\_\_\_\_  
\_\_\_\_\_

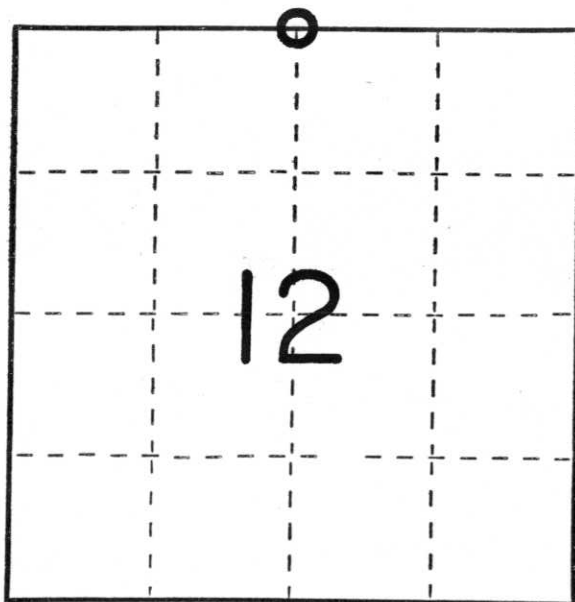

○ = Corner monument restored.

History of original corner establishment:  
Surveyor: Jackson L. Prentice  
Date: January 7th, 1855  
Monumentation: Wood post  
Witnesses: 9" Maple S2°W, 10 lks  
15" Hemlock N7°W, 20 lks

Description of corner evidence found:

Old iron monument in the centerline of the right of way obtained by measuring from the fences. Definite bend in road and fence lines here.

Description of monument and accessories I established to perpetuate the original location of this corner.

Berntsen monument - 36" 4' North of centerline of S.T.H. "86"  
P.K. nail in telephone pole S31°W, 31.98'  
P.K. Nail in power pole N48°E, 40.35'  
P.K. nail in 7" quad. cedar N14°E, 185.33'  
Nail in 10" Maple S37°W, 65.01'

Dated at Minasqua, Wis., this 19th day of November, 19 74.

Signature Robert H. Winat Title Land Surveyor Registration No. S-1040  
(County Surveyor, Registered Land Surveyor, or other duly authorized official)

Office of Register of Deeds, County of \_\_\_\_\_, I hereby certify that the within instrument was filed in this office for record on the \_\_\_\_\_ day of \_\_\_\_\_, 19 \_\_\_\_\_ at \_\_\_\_\_ o'clock \_\_\_\_\_ M.

\_\_\_\_\_  
(Register of Deeds)

By \_\_\_\_\_ Deputy

RECEIVED & INDEXED  
OCT 11 1974  
LINCOLN COUNTY  
J. L. Prentice  
Surveyor