

CERTIFIED LAND CORNER RESTORATION

Index No. I-5

State of Wisconsin }  
County of LINCOLN } ss.

I DAVID L. LEMKE, do hereby certify that on the 23<sup>rd</sup> day of NOVEMBER, 1988, I found evidence of the SOUTH EAST corner of SECTION 7 Township 34, North, Range 4 EAST, Fourth Principal Meridian, as described hereon; and that from this evidence I established a new monument and accessories as described hereon to perpetuate the original location of this corner.

Resident witnesses:

EUGENE EMMERICH

MICHAEL CROWELL

History of original corner establishment:

POST SET BY EDWARD PALMER APRIL, 20 1865  
STONE CALLED OUT BY KORDICK'S SURVEY DATED AUG 20, 1966

Description of corner evidence found:

6" X 6" RED GRANITE STONE

Description of monument and accessories I established to perpetuate the original location of this corner.

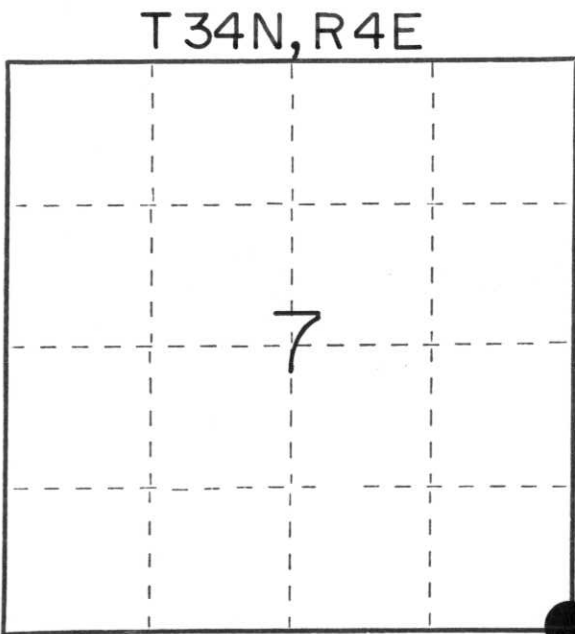
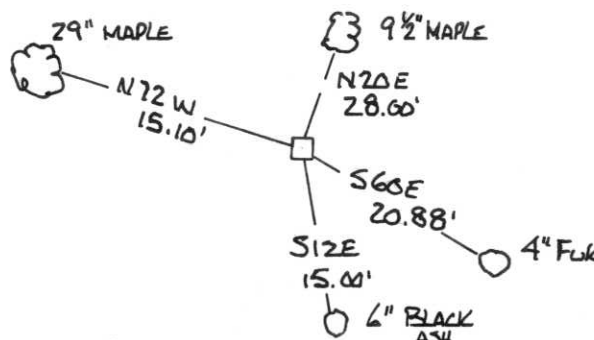

○ = Corner monument restored.

Dated at TOMAHAWK, Wis., this 23<sup>rd</sup> day of NOVEMBER, 1988

Signature: [Signature] Title: REGISTERED LAND SURVEYOR Registration No. S-1845  
(County Surveyor, Registered Land Surveyor, or other duly authorized official)

Office of Register of Deeds, County of....., I hereby certify that the within instrument was filed in this office for record on the..... day of....., 19..... at..... o'clock..... M.

(Register of Deeds)

By..... Deputy

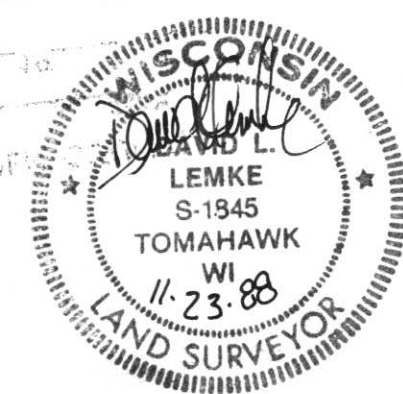

Stock No. 26272

H.C. Miller Company

FORM 965