

U S PUBLIC LAND SURVEY MONUMENT RECORD

NOTE: This form is intended and designed to fulfill all requirements of Wisconsin Administrative Code, Chapter A-E 7.08 U.S. Public Land Survey Monument Record (3) (a-i)

A-E 7.08(3)(a) Identity of corner:
 EAST 1/4 CORNER SECTION 03,
 TOWNSHIP 34 NORTH,
 RANGE 04 EAST OF THE 4TH PM,
 TOWN OF TOMAHAWK,
 COUNTY OF LINCOLN

WISCRS - LINCOLN COUNTY
 N: 224,728.064 USft (224,728.079)
 E: 322,786.181 USft (322,786.173)
 Datum: NAD83 (2011)
 GNSS Method RTN - Direct
 GNSS Control WISCORS VRS

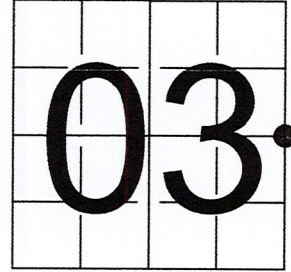

The coordinate value shown has been verified by the average of two or more GPS observations at a markedly different time. Coordinates shown in parenthesis are provided by Lincoln County.

A-E 7.08(3)(b)

Original Surveyor: Edward D. Palmer

Date of Original Survey	Commenced:	April 10, 1865	Original Accessories:		
	Completed:	April 20, 1865	Spruce	5	N 40° W 10 Links
			Spruce	3	S 70° W 15 Links

December 20, 2012 - Surveyor 2729 - Gregory S. Maines - indicate this position as "N: 224728.08, E: 322786.17 coordinates provided by Lincoln County Surveyor" on Lincoln County Section Summary - Section 2, T 34 N, R 4 E.

July 15, 2019 - Surveyor 2717 Keith J. Walkowski - indicates this position as "calculated from section summary & coordinates provided by Lincoln County Surveyor" on Lincoln County map M682B.

October 27, 2022 - While performing the 2022 Lincoln County PLSS Corner Remonumentation and GPS Services project, I went to the coordinate position provided by Lincoln County, I made a careful search of the area and found no evidence of the corner or witnesses. Under the direction of Lincoln County, I restored the corner using coordinates provided by Lincoln County and set a Berntsen aluminum "swamp monument" being a 1" diameter x 50" long aluminum pipe with a 2.5" diameter aluminum cap. I established 4 new reference monuments as shown below.

A-E 7.08(3)(c)(d) Plan view of corner with references to at least 4 witness monuments.

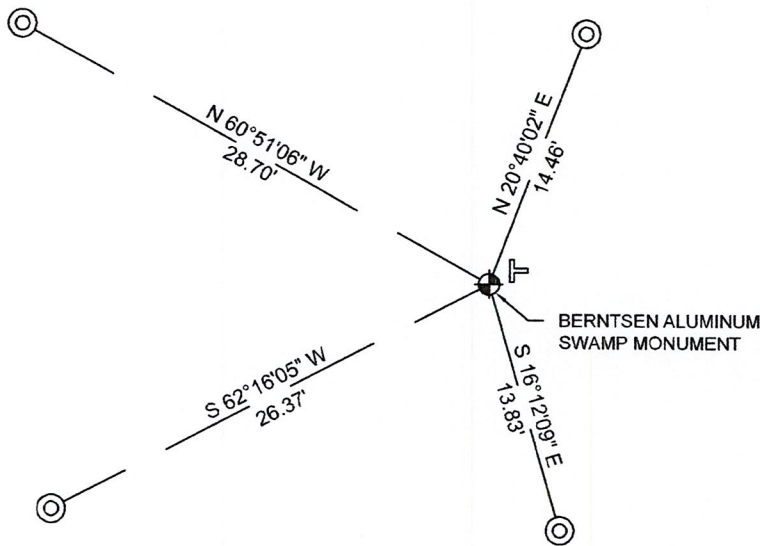

BEARINGS LISTED TO THE NEAREST SECOND ARE REFERENCED TO WISCONSIN COUNTY COORDINATE REFERENCE SYSTEM - LINCOLN COUNTY ZONE. ALL OTHER BEARINGS ARE MAGNETIC



RECEIVED BY LINCOLN COUNTY
 SURVEYOR THIS 27TH DAY
 OF December 20 22
James D. DeMuth
 COUNTY SURVEYOR

LEGEND

- 1" diameter x 50" long aluminum pipe monument with a 2.5" diameter aluminum cap, set
- 1" diameter X 32" long aluminum pipe with 2.5" diameter aluminum cap, set
- Vinyl T-post, set ±0.5 feet E-NE of corner

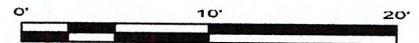

A-E 7.08(3)(e) 1865 Surveyor set a post, 2012 and 2019 Surveyors had coordinates. I set a Berntsen aluminum monument.

A-E 7.08(3)(f) I restored the corner through ACCEPTANCE OF AN OBLITERATED LOCATION.

A-E 7.08(3)(g)(h) This corner was not determined through lost-corner-proportionate methods.

A-E 7.08(3)(i) I, Jeffrey L. DeMuth, Professional Land Surveyor No. S-2656, hereby certify that the corner location on this record was determined by the Lincoln County Surveyor, and the monuments found or set as shown hereon were measured by me or under my direction and control, and that this U.S. Public Land Survey Monument Record is correct and complete to the best of my knowledge, and belief.

SIGNATURE

December 14, 2022

DATE

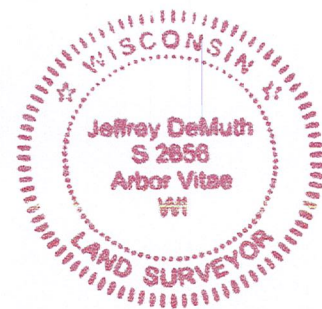

C-17

REPORT

2022-Lincoln County PLSS Corner Remonumentation and GPS Services

Wisconsin Corner Point Identification Number: 43404032000

Surveyor: Jeffrey L. DeMuth – S2656

Corner monument: Set Berntsen aluminum "swamp monument", 1" diameter x 50" long aluminum pipe with a 2.5" diameter aluminum cap at coordinates provided.

Field Book: Cardinal North – Lincoln Co. Remon. – 2022-00

Page: 60

Horizontal Datum: WisCRS – Lincoln County Zone – NAD83(2011)

Date / time of initial measurement:

October 27, 2022 - Start 15:18:19 CDT – End 15:27:48 CDT

Reference monuments:

4 – Set - 1" diameter X 32" long aluminum pipe with 2.5" diameter Lincoln Co. aluminum cap.

Coordinate Table

	County Provided	2022 Measurement	Difference
North	224728.079	224728.064	0.02
East	322786.173	322786.181	-0.01

Established coordinates match existing calculated coordinates within reason.

Request Data Log for more information.

Additional Notes:

Corner is in a black spruce swamp. There is a cut line heading west from the corner.

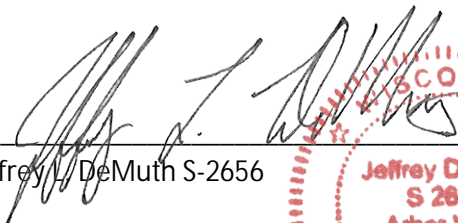

 Jeffrey L. DeMuth S-2656

 November 15, 2022
 Date

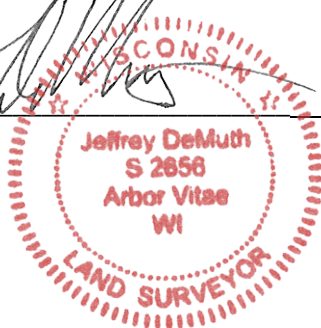

43404032000_Mon-N



43404032000_North

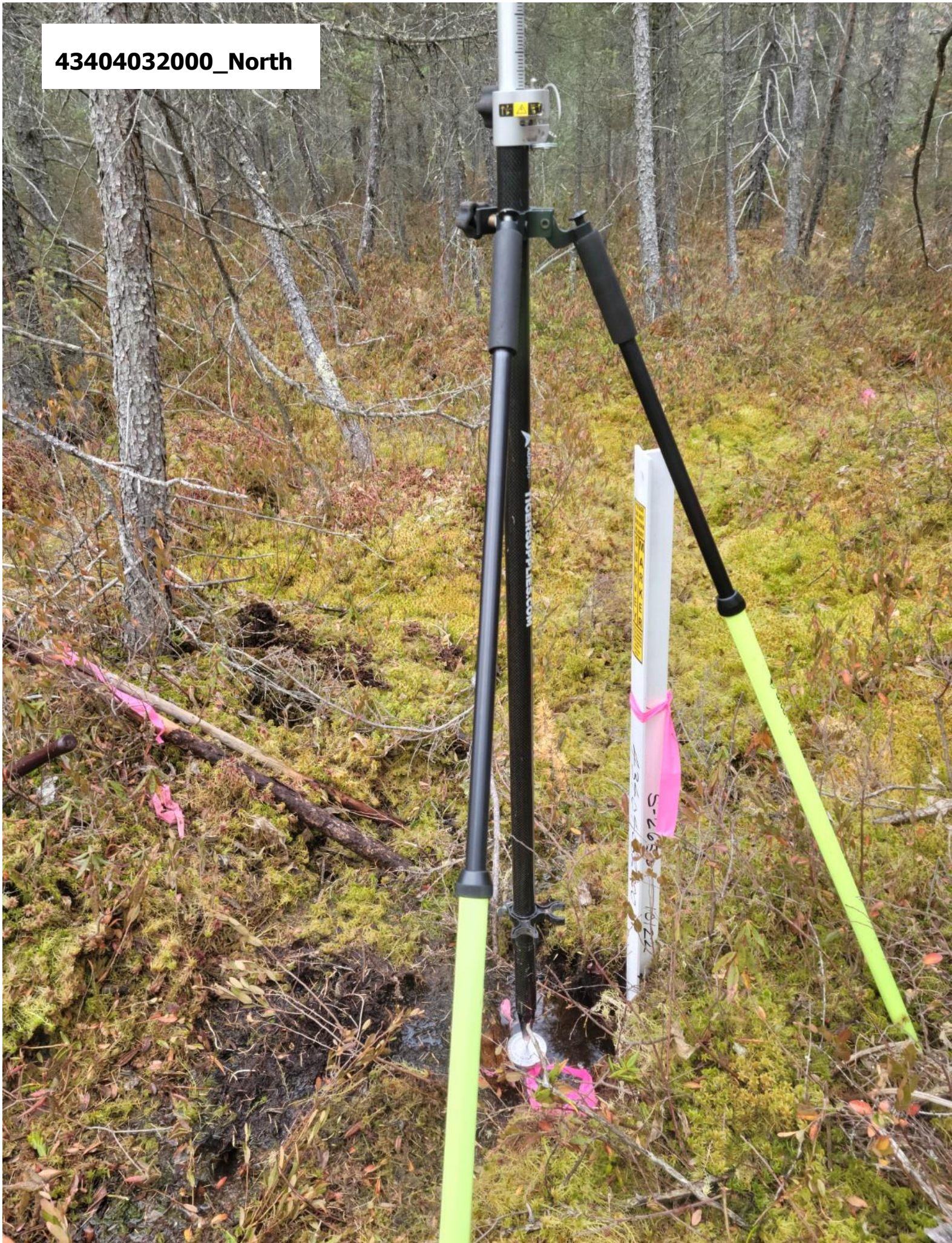

43404032000_West



43404032000_South



43404032000_East

PLEASE
DO NOT
DISTURB
NEARBY
SURVEY
POINTS

43404032000

