

U.S. PUBLIC LAND SURVEY MONUMENT RECORD

NOTE: This form is intended and designed to fulfill all requirements of Wisconsin Administrative Code, Chapter A-E 7.08 U.S. Public Land Survey Monument Record (3)(a)(b)(c)(d)(e)(f)(g)(h)(i). An additional sheet may be added if necessary to conform with said requirements.

(a) Corner location: Township 33 North
 Range 06 East
 Town of ROCK FALLS
 LINCOLN County, Wisconsin

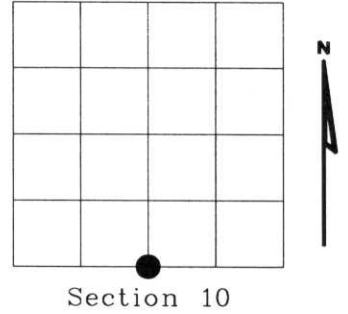

(b)(f)(g)(h) Description of monument found at this corner and if it was accepted, state all evidence (material, testimonial, occupational, plats, records, other monuments) used as a basis for accepting. If not accepted or if nothing was found, state evidence used as basis for establishing location. If reestablished through lost corner proportionate methods, indicate all monuments, distances and directions used to establish. Indicate type of monument found or set and sign post.

- 1943 - FRANCIS X. FOX SET 1/4 STONE IN ROAD OFF SET IRONS NS 24.75'.
- 1961 - P.M. JOHNSON W.H.C. DIST. NO. 7, 2" IRON WITNESS POST NORTH 33.0', SOUTH 33.0'.
- 2000 - I FIND EXSISTING 1" IRON PIPE NS BY OLD ROUND R.O.W. POST 66.0' APART, SET RAILROAD SPIKE ONLINE AND 33.0' FROM EACH 1" IRON PIPE, IN CENTERLINE OF HWY "J".

RECEIVED AT LINCOLN COUNTY
 COURTHOUSE THIS 10TH DAY
 OF August 20 00
Zony Wallman
 LAND INFORMATION OFFICE

(c)(d)(e) Plan view of corner with ties to at least 4 witness monuments. If in disagreement with previously established corner, show the distances between the two corners and also indicate the ties to the disputed corner.

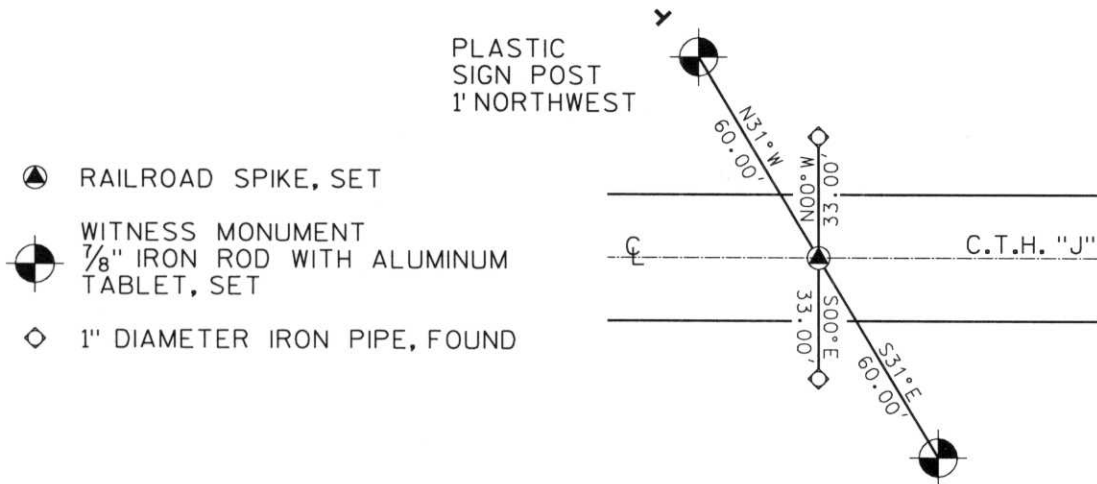

- RAILROAD SPIKE, SET
- ⊗ WITNESS MONUMENT 7/8" IRON ROD WITH ALUMINUM TABLET, SET
- ◇ 1" DIAMETER IRON PIPE, FOUND

(i) I, Dennis B. Roberts, Registered Land Surveyor *S-1863, hereby certify that the corner location on this record was determined by me or under my direction and control and that this U.S. Public Land Survey Monument Record is correct and complete to the best of my knowledge and belief.



Dennis B. Roberts 8-08-2000
 Signature Date

Index No. I-15

PRESERVATION OF LANDMARKS

SECTION 59,635(7) WISCONSIN STATUTES
COUNTY LINCOLN

TOWN ROCK FALLS

HIGHWAY C.T.H. "J"

SECTION NO. S 10 & 15

T. 33 N., R. 6 E.

TYPE OF LANDMARK 1/4 Corner

LOCATION INDICATED ON SKETCH X

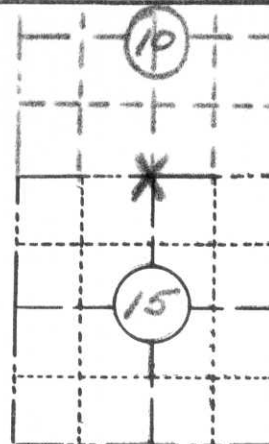

PAGE _____



LOCATION SKETCH

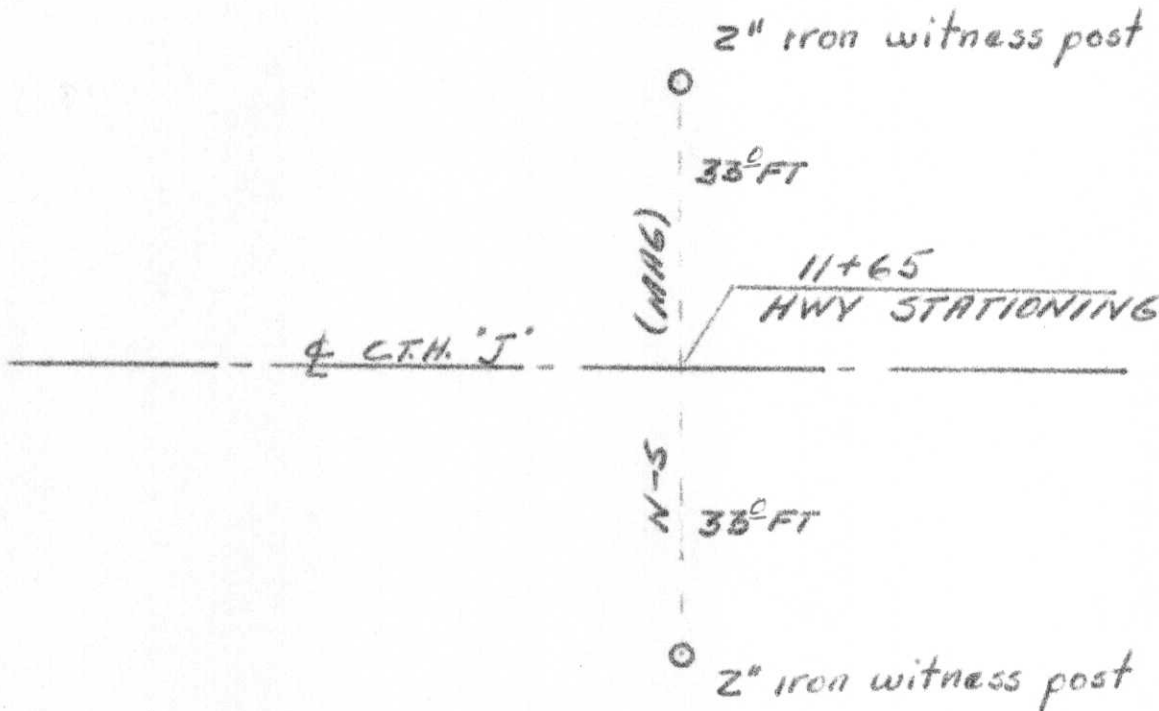

This space for copy of field notes or ties to the above described landmarks

Field notes or records filed in book no. Form 710 on file

at the W.H.C., Dist. No. 7 office.

City of Rhinalandar, Onaida County.

Located or established by P M Johnson, 1961

Title Engineer II

County Clerk's Office _____ County, Wis. } ss

Received for record _____, 19 _____

Copy sent to County Surveyor _____, 19 _____

County Clerk

Index No. I-15

PRESERVATION OF LANDMARKS

SECTION 59,635(7) WISCONSIN STATUTES
 COUNTY LINCOLN
 TOWN ROCK FALLS
 HIGHWAY C.T.H. "J"
 SECTION NO.S 10 & 15
 T. 33 N., R. 6 E.
 TYPE OF LANDMARK 1/4 Corner
 LOCATION INDICATED ON SKETCH X

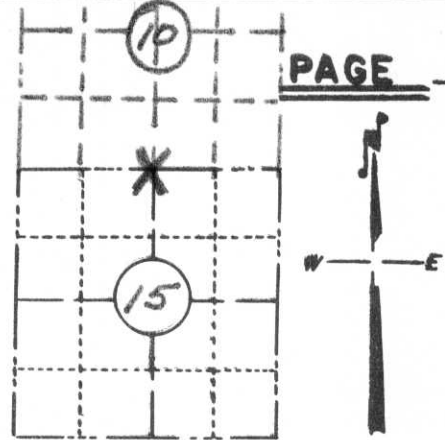

LOCATION SKETCH

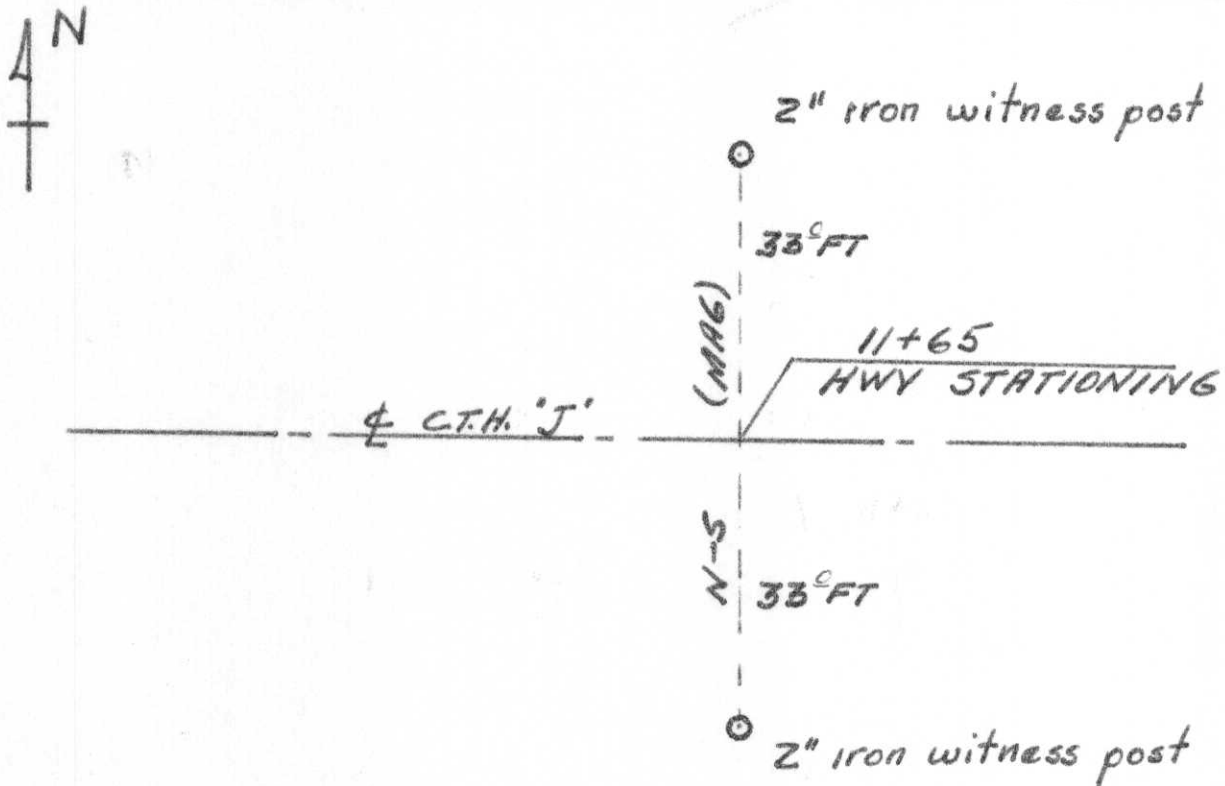

This space for copy of field notes or ties to the above described landmarks

Field notes or records filed in book no. Form 710 on file
 at the W.H.C., Dist. No. 7 office.
 City of Rhinelander Oneida County.
 Located or established by P M Johnson, 1961
 Title Engineer II

County Clerk's Office _____ County, Wis. } ss
 Received for record _____, 19____

Copy sent to County Surveyor _____, 19____

County Clerk

Index No. I-15

PRESERVATION OF LANDMARKS

SECTION 59,635(7) WISCONSIN STATUTES
 COUNTY LINCOLN
 TOWN ROCK FALLS
 HIGHWAY C.T.H. "J"
 SECTION NO. S 10 & 15
 T. 33 N., R. 6 E.
 TYPE OF LANDMARK 1/4 Corner
 LOCATION INDICATED ON SKETCH X

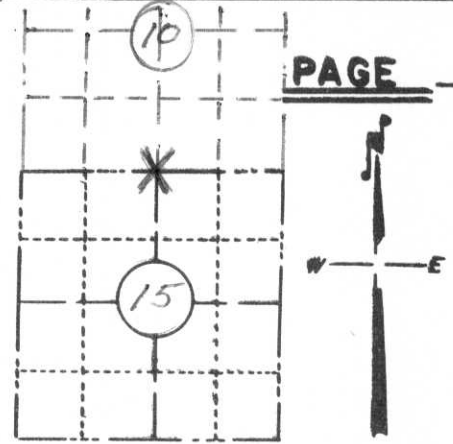

LOCATION SKETCH

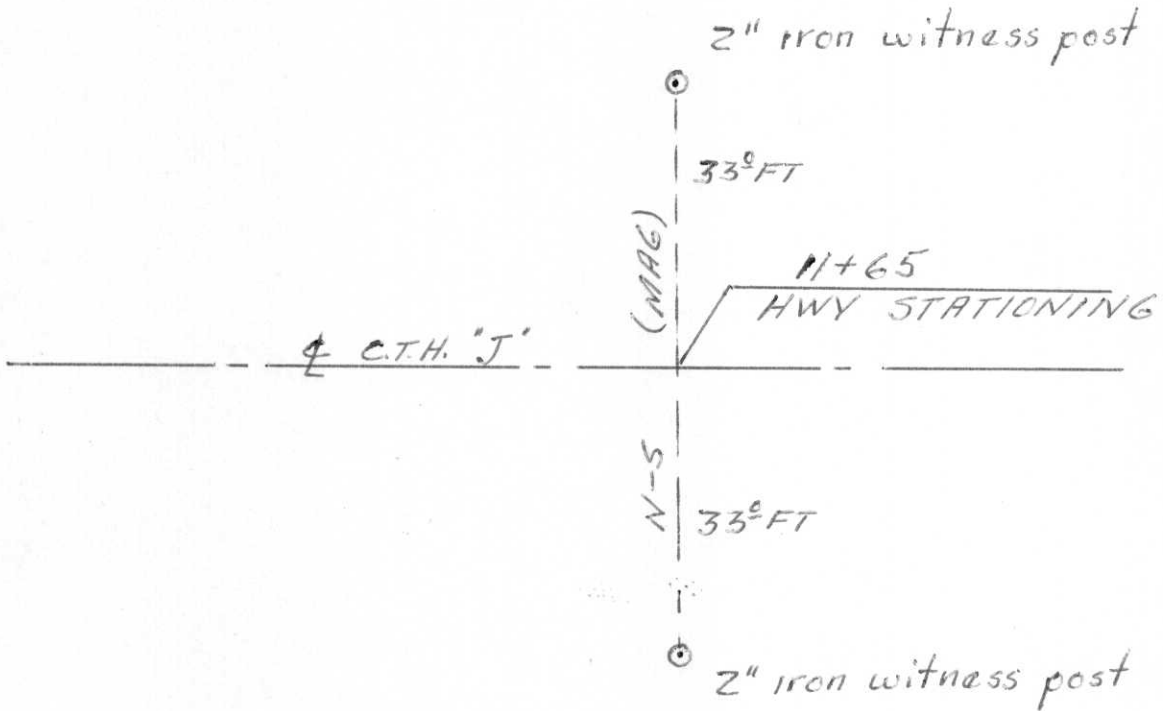

This space for copy of field notes or ties to the above described landmarks

Field notes or records filed in book no. Form 710 on file
 at the W.H.C., Dist. No. 7 office.
 City of Rhinelandar, Oneida County.
 Located or established by P.M. Johnson, 1961
 Title Engineer II

County Clerk's Office _____ County, Wis. } ss
 Received for record _____, 19____

Copy sent to County Surveyor _____, 19____

County Clerk

Index No. I-15









