

CERTIFIED LAND CORNER RESTORATION

Index No. 0-21

State of Wisconsin }  
County of LINCOLN } ss.

I WILLIAM IMMICH, do hereby certify that on the 5th day of DECEMBER, 1984, I found evidence of the EAST 1/4 corner of SECTION 23 Township 33, North, Range 5 East, Fourth, Principal Meridian, as described hereon; and that from this evidence I established a new monument and accessories as described hereon to perpetuate the original location of this corner.

Resident witnesses:

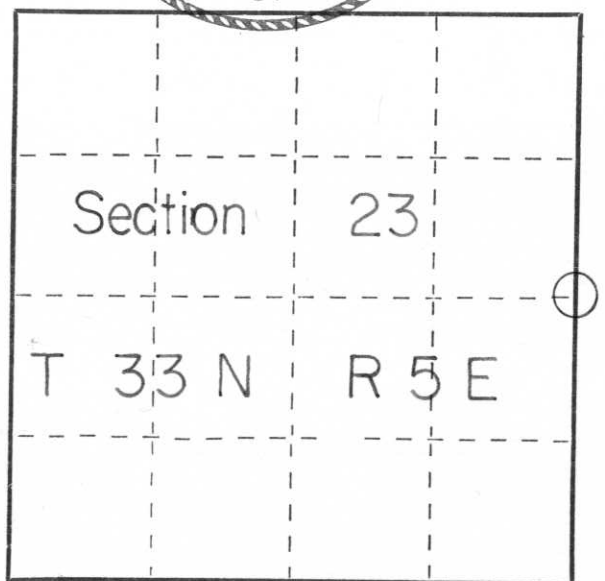
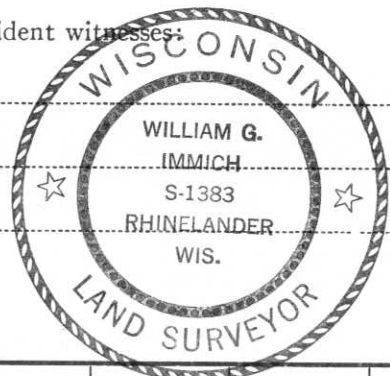

○ = Corner monument restored.

History of original corner establishment:

1854 - JACKSON PRENTICE, GOVERNMENT SURVEYOR, SET 1/4 POST AT 40.00 CHAINS MADE BEARING TREES - BIRCH 9 WEST 101k; BIRCH 18 S74E 211k  
1937 - F. FOX RAN SOUTH BETWEEN 23-24, 2547.4 SET 1/4 STONE (WEST 158.8): AT EDGE OF SWAMP PINE STUMP 18' N53E 40.7' PINE STUMP 10" N 71°W 50.6 MOUNDED WITH STONE

Description of corner evidence found:

FOUND SQUARE GRANITE MONUMENT SET BY FOX

Description of monument and accessories I established to perpetuate the original location of this corner.

MONUMENT IN GOOD CONDITION SET WITNESS PIPE\*, 1" x 24"  
IRON PIPE N 70°W 10.00'  
" N 20°E 10.00  
" S 30°W 10.00  
" N 60°E 10.00

\* BEARINGS MAG - DISTANCE TO CENTER OF PIPE

Dated at RHINELANDER, Wis., this 5th day of DECEMBER, 1984.

Signature William Immich Title REGISTERED LAND SURVEYOR Registration No. 1383  
(County Surveyor, Registered Land Surveyor, or other duly authorized official)

Office of Register of Deeds, County of \_\_\_\_\_, I hereby certify that the within instrument was filed in this office for record on the \_\_\_\_\_ day of \_\_\_\_\_, 19\_\_\_\_ at \_\_\_\_\_ o'clock \_\_\_\_\_ M.

\_\_\_\_\_  
(Register of Deeds)

By \_\_\_\_\_ Deputy









