

CERTIFIED LAND CORNER RESTORATION

Index No. Q-19

State of Wisconsin }
County of LINCOLN } ss.

I, WILLIAM IMMICH, do hereby certify that on the 5th day of DECEMBER, 1984, I found evidence of the SOUTH 1/4 corner of SECTION 23 Township 33, North, Range 5 EAST, Fourth, Principal Meridian, as described hereon; and that from this evidence I established a new monument and accessories as described hereon to perpetuate the original location of this corner.

Resident witnesses:

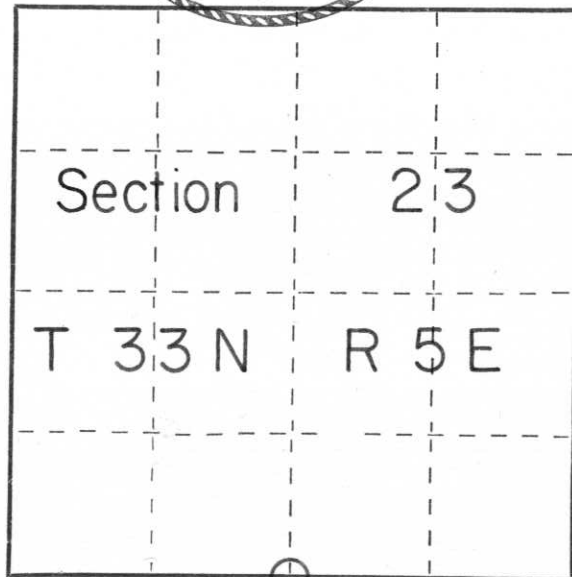
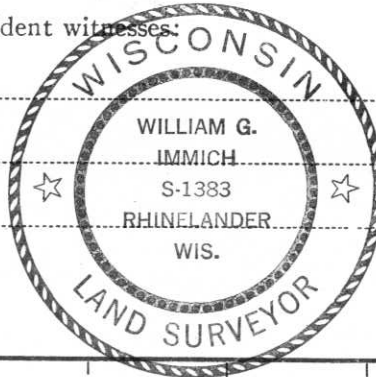

○ = Corner monument restored.

History of original corner establishment:

1857 - JACKSON PRENTICE, GOVERNMENT SURVEYOR, WEST CORRECTED SET 1/4 POST AT 40.05 CHAINS, MADE BEARING TREES TAMARACK 12 N57E 221K; ASPEN 10 S13W 66K
1937 - F. FOX WAS AT STONE AT INTERSECTION OF ROADS THEN RAN EAST - WEST FROM CORNER

Description of corner evidence found:

FOUND SQUARE GRANITE MONUMENT AT INTERSECTION OF ROADS

Description of monument and accessories I established to perpetuate the original location of this corner.

MONUMENT IN GOOD CONDITION; MADE NEW BEARING TREES*

ASH 6" N 11° E 40.50'
S. MAPLE 8" N 21° E 36.39'
S. MAPLE 14" S 47° W 68.08'
Y. BIRCH 14" S 50° E 102.55'

* BEARINGS MAG - DISTANCE TO FACE OF BLAZE

Dated at RHINELANDER, Wis., this 5th day of DECEMBER, 1984

Signature William Immich Title REGISTERED LAND SURVEYOR Registration No. 1383
(County Surveyor, Registered Land Surveyor, or other duly authorized official)

Office of Register of Deeds, County of _____, I hereby certify that the within instrument was filed in this office for record on the _____ day of _____, 19____ at _____ o'clock _____ M.

(Register of Deeds)

By _____ Deputy









