

CERTIFIED LAND CORNER RESTORATION

Index No. X-25

State of Wisconsin }
 County of LANGLADE } ss.

History of original corner establishment:

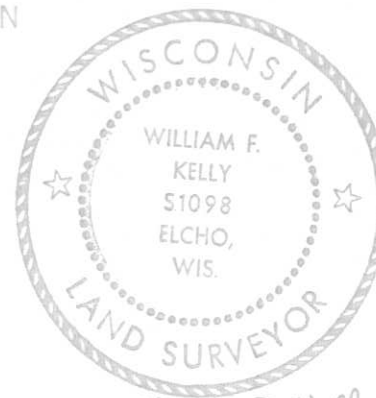

I WILLIAM F. KELLY, do hereby certify that on the 26TH day of NOVEMBER, 1975, I found evidence of the 5'16 corner of SECTIONS 31 & 36 Township 22, North, Range 8E & 9E, Fourth Principal Meridian, as described hereon; and that from this evidence I established a new monument and accessories as described hereon to perpetuate the original location of this corner.

Description of corner evidence found:

William F. Kelly
 LOCATED WITNESS COR TO 5'16 CORNER SECTION 36 & 31 T. 32N. - R. 8E. & 9E. FROM SURVEY MAP AND NOTES OF 1960.
 CORNER MISSING.

Resident witnesses:

.....

36-32-8
 T 32N - R 9E

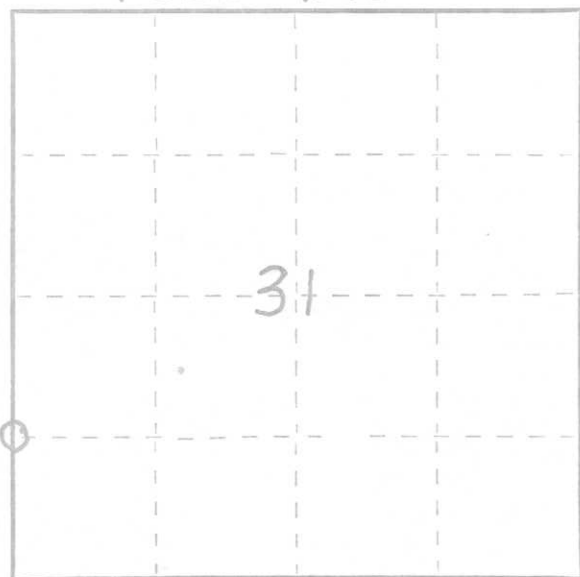

○ = Corner monument restored.

Description of monument and accessories I established to perpetuate the original location of this corner.

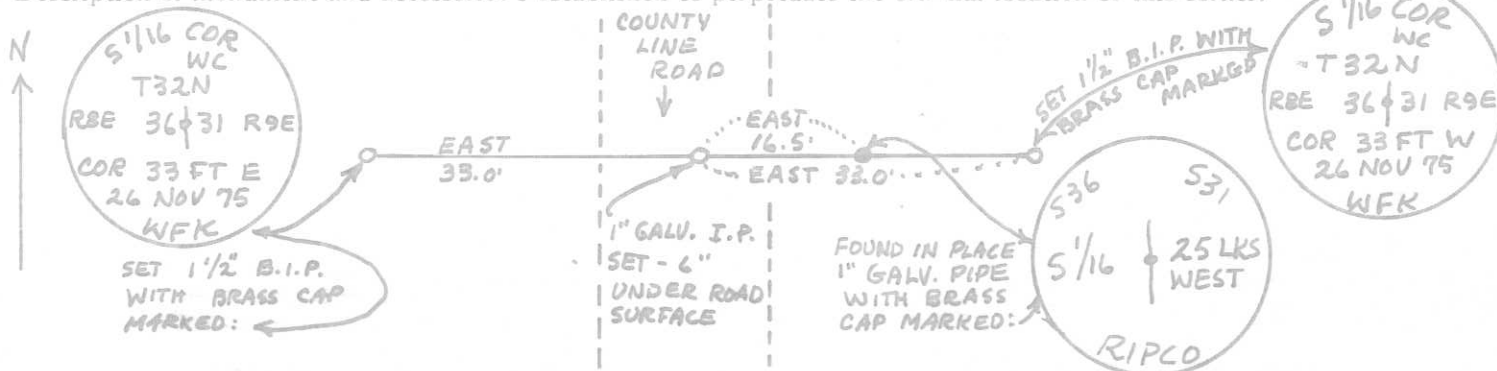

Dated at ELCHO, Wis., this 26TH day of NOVEMBER, 1975

Signature William F. Kelly Title REGISTERED LAND SURVEYOR Registration No. S 1098
 (County Surveyor, Registered Land Surveyor, or other duly authorized official)

Office of Register of Deeds, County of _____, I hereby certify that the within instrument was filed in this office for record on the _____ day of _____, 19____ at _____ o'clock _____ M.

(Register of Deeds)

By _____ Deputy

LINCOLN COUNTY