

CERTIFIED LAND CORNER RESTORATION

Index No. I-23

State of Wisconsin }
County of Lincoln } ss.

I, Sheridan D. Schwark, do hereby certify that on the 19th day of December, 1980, I found evidence of the N1/4 corner of Section 13 Township 32, North, Range 7 East, Fourth, Principal Meridian, as described hereon; and that from this evidence I established a new monument and accessories as described hereon to perpetuate the original location of this corner.

Resident witnesses:

.....
.....
.....

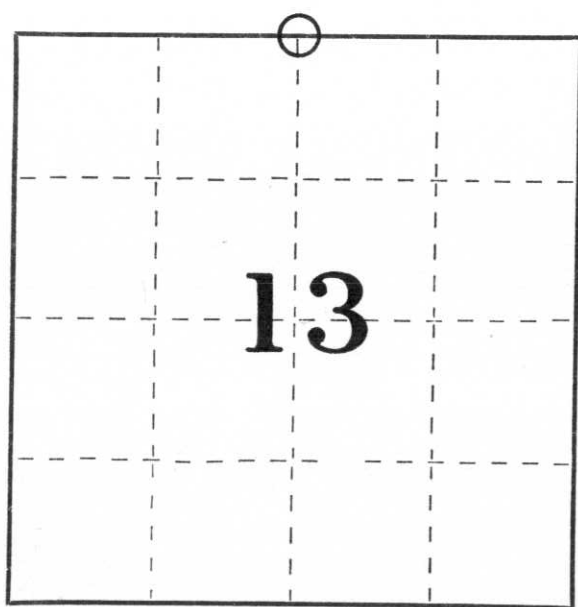

○ = Corner monument restored.

History of original corner establishment:

Wood post set by original government surveyor.

Description of corner evidence found:

We found a 7" x 7" red granite monument up approximately 1' above grade.

Description of monument and accessories I established to perpetuate the original location of this corner.

NOTE: All trees are blazed and have P.K. nails set in them.

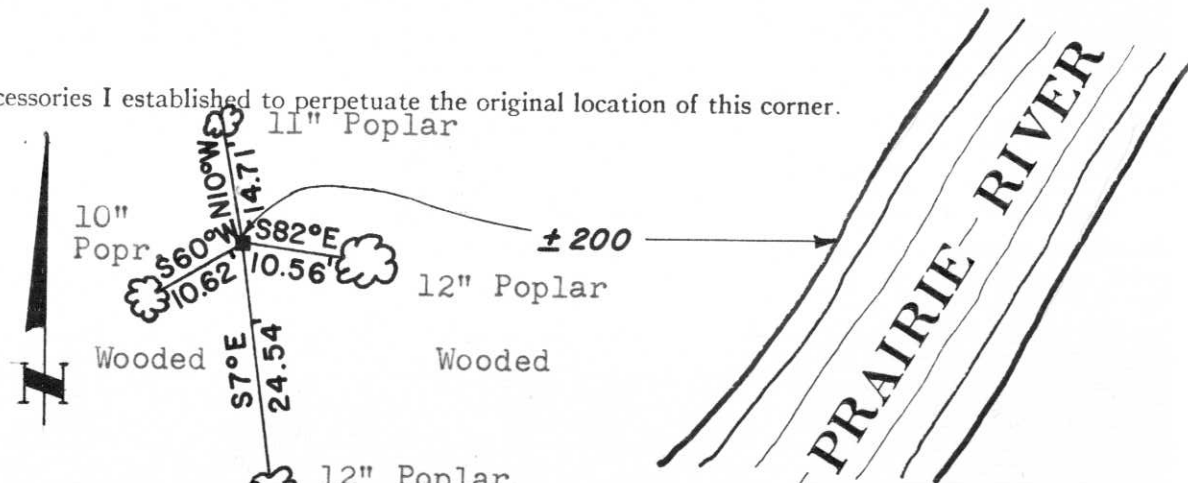

Dated at Wausau, Wis., this 19 day of December, 1980.

Signature Sheridan D. Schwark Title Registered Land Surveyor Registration No. S-1205
(County Surveyor, Registered Land Surveyor, or other duly authorized official)

Office of Register of Deeds, County of _____, I hereby certify that the within instrument was filed in this office for record on the _____ day of _____, 19____ at _____ o'clock _____ M.

.....
(Register of Deeds)

By _____ Deputy





11 12:37 PM



5
M
A
R
K
E
R
Y

11 12:42 PM