

CERTIFIED LAND CORNER RESTORATION

Index No. U-21

State of Wisconsin }
County of LINCOLN } ss.

I EDWIN R. ABENDROTH, do hereby certify that on the 3RD day of MAY, 1978, I found evidence of the SW corner of SEC. 25 Township 32, North, Range 6 EAST, Fourth, Principal Meridian, as described hereon; and that from this evidence I established a new monument and accessories as described hereon to perpetuate the original location of this corner.

Resident witnesses:

.....
.....
.....

History of original corner establishment:

NORTH BETWEEN SECTIONS 35 AND 36
SET POST COMMON TO SECTIONS 25, 26, 35 AND 36
HEMLOCK 11 S 34° E 17
BIRCH 14 N 19° E 18

Description of corner evidence found:

STATE OF WIS. DIV. OF HIGHWAYS SEARCHED AREA AND FOUND NO EVIDENCE DURING RECONSTRUCTION OF C.T.H. "K"



Description of monument and accessories I established to perpetuate the original location of this corner.

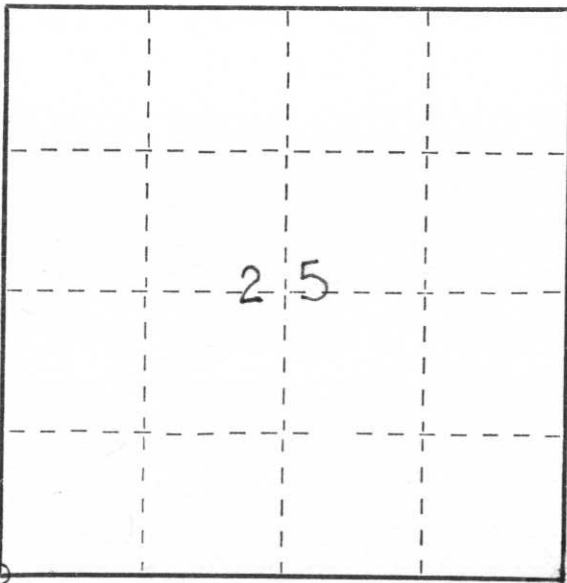
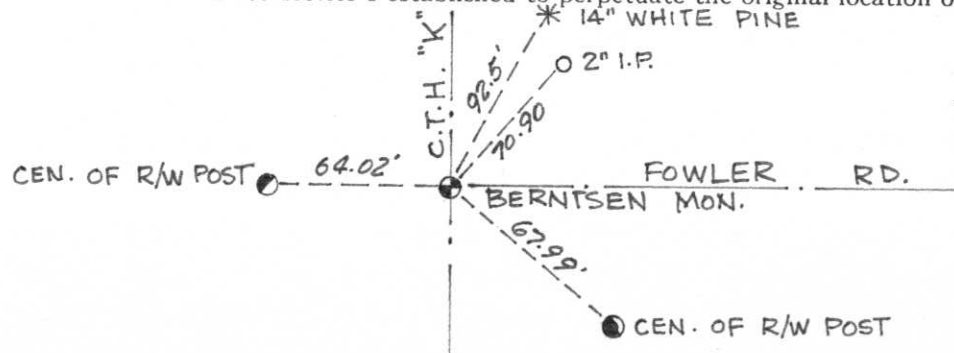

○ = Corner monument restored.

Dated at WAUSAU, Wis., this 14TH day of JUNE, 1978.

Signature Edwin R. Abendroth Title R.L.S. Registration No. S-798
(County Surveyor, Registered Land Surveyor, or other duly authorized official)

Office of Register of Deeds, County of _____, I hereby certify that the within instrument was filed in this office for record on the _____ day of _____, 19____ at _____ o'clock _____ M.

(Register of Deeds)

By _____ Deputy



2002 8 6



2002 8 6



2002 8 6



2002 8 6