

# U.S. PUBLIC LAND SURVEY MONUMENT RECORD

Note: This form is intended and designed to fulfill all requirements of Wisconsin Administrative Code, Chapter A-E 5.02, U.S. Public Land Survey Monument Record (3) (a) (b) (c) (d) (e) (f) (g) (h) (i). An additional sheet may be added if necessary to conform with said requirements.

(a) Corner location: Township 31 North

Range 5 East

Town/City/Village CORNING

County LINCOLN

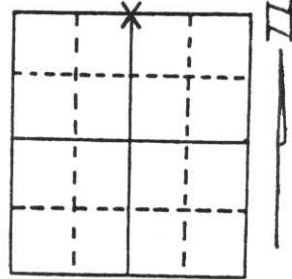

Section 6

(b) (f) (g) (h) Description of monument found at this corner and if it was accepted, state all evidence (material, testimonial, occupational, plats, records, other monuments) used as a basis for accepting. If not accepted or if nothing was found, state evidence used as basis for establishing location. If reestablished through lost corner proportionate methods, indicate all monuments, distances and directions used to establish.

There was no local testimony available that had witnessed a stone in this area. I dug at the intersection of a south fenceline - centerline Craneberry Trail. I found no evidence. I held the centerline - centerline location of the northwest corner of said section and came 40.07 chains (original chainage) east for the east - west alignment and the centerline of the existing road for the north - south alignment. This position fit the existing fenceline running south.

(c) (d) (e) Plan view of corner with ties to at least 4 witness monuments. If in disagreement with previously established corner, show the distances between the two corners and also indicate the ties to the disputed corner.

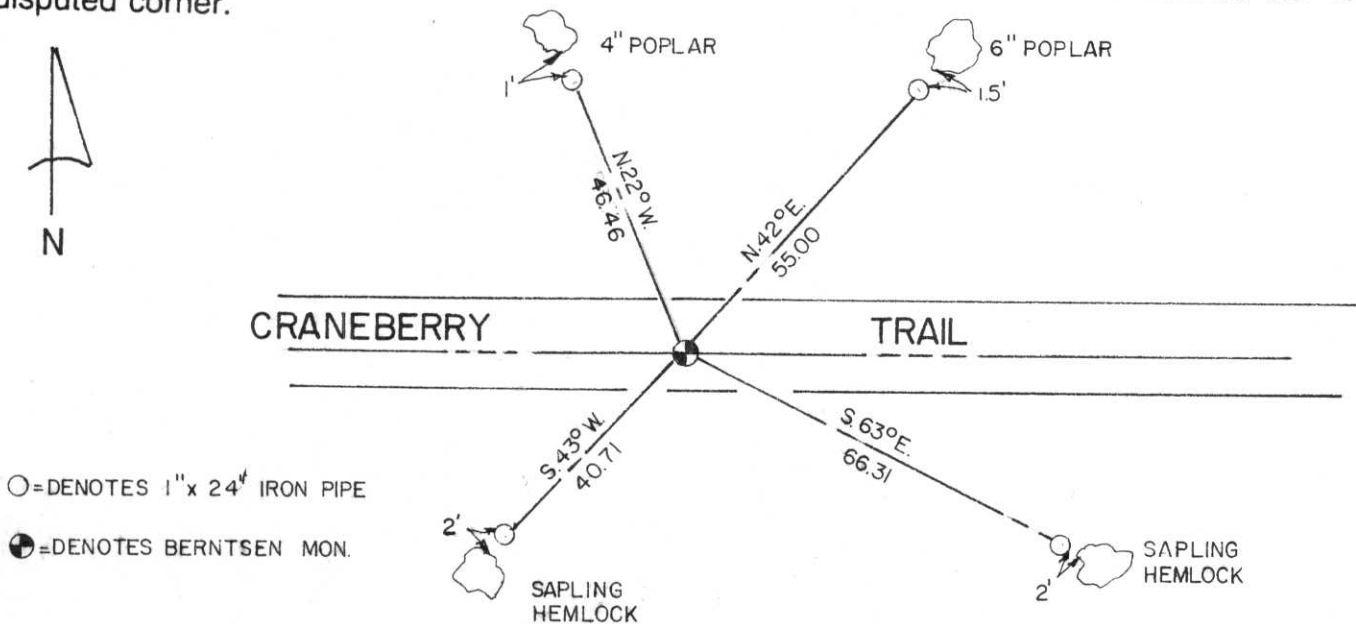

○ = DENOTES 1" x 24" IRON PIPE

● = DENOTES BERNTSEN MON.

(i) I, THOMAS A. RADENZ

(type or print name) certify that the corner location on this record was determined by me or under my direction and control and that this U.S. Public Land Survey Monument Record is correct and complete to the best of my knowledge and belief.

*Thomas A. Radenz*

Signature

12-28-93

Date



Index No. A-3











