

U.S. PUBLIC LAND SURVEY MONUMENT RECORD

Note: This form is intended and designed to fulfill all requirements of Wisconsin Administrative Code, Chapter A-E 5.02, U.S. Public Land Survey Monument Record (3) (a) (b) (c) (d) (e) (f) (g) (h) (i). An additional sheet may be added if necessary to conform with said requirements.

(a) Corner location: Township 32 North

Range 5 East

Town/City/Village HARDING

County LINCOLN

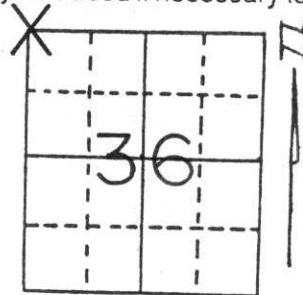

Section 36

(b) (f) (g) (h) Description of monument found at this corner and if it was accepted, state all evidence (material, testimonial, occupational, plats, records, other monuments) used as a basis for accepting. If not accepted or if nothing was found, state evidence used as basis for establishing location. If reestablished through lost corner proportionate methods, indicate all monuments, distances and directions used to establish.

Talked with Land Owner, Meyer, he said there never was a monument at this area. They always held existing fence corner as property line. Searched area, found no other evidence. Original Notes show corner set in swamp. Tried to look in swamp to south, but floating bog made it impossible to get out into area, and no corner would be at surface. Held fence corner as best evidence for corner. Set Lincoln County Aluminum Monument. Tied out, painted witness Bars yellow. Put yellow warning sign near corner.

SEE BACK FOR SECTION BREAK DOWN

(c) (d) (e) Plan view of corner with ties to at least 4 witness monuments. If in disagreement with previously established corner, show the distances between the two corners and also indicate the ties to the disputed corner.

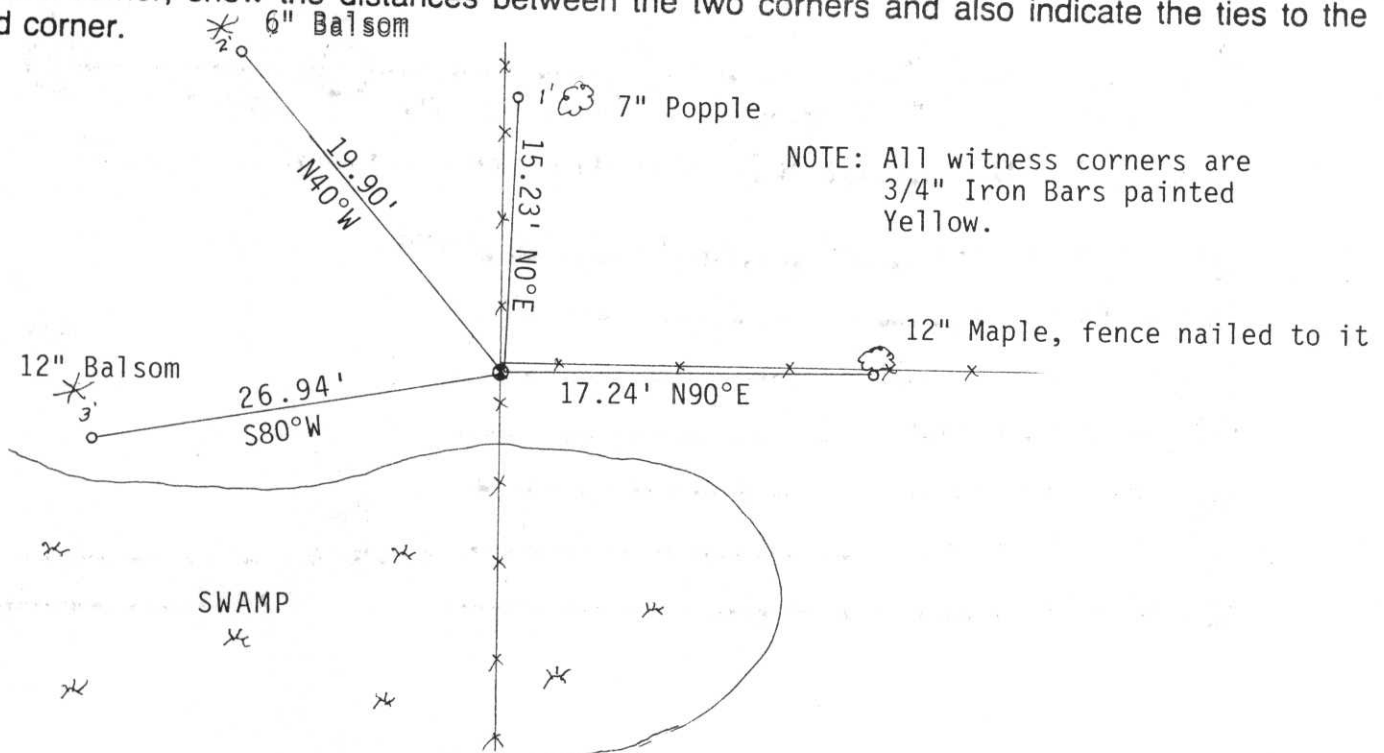

(i) I, David L. Osterbrink RLS No. S-2014
 (type or print name) certify that the corner location on this record was determined by me or under my direction and control and that this U.S. Public Land Survey Monument Record is correct and complete to the best of my knowledge and belief.

David L. Osterbrink 12-15-92
 Signature Date



Index No. U-21

HARDING
CITY VILLAGE TOWN

NOTE: USE REVERSE SIDE FOR EXPLANATORY REMARKS & SKETCHES.

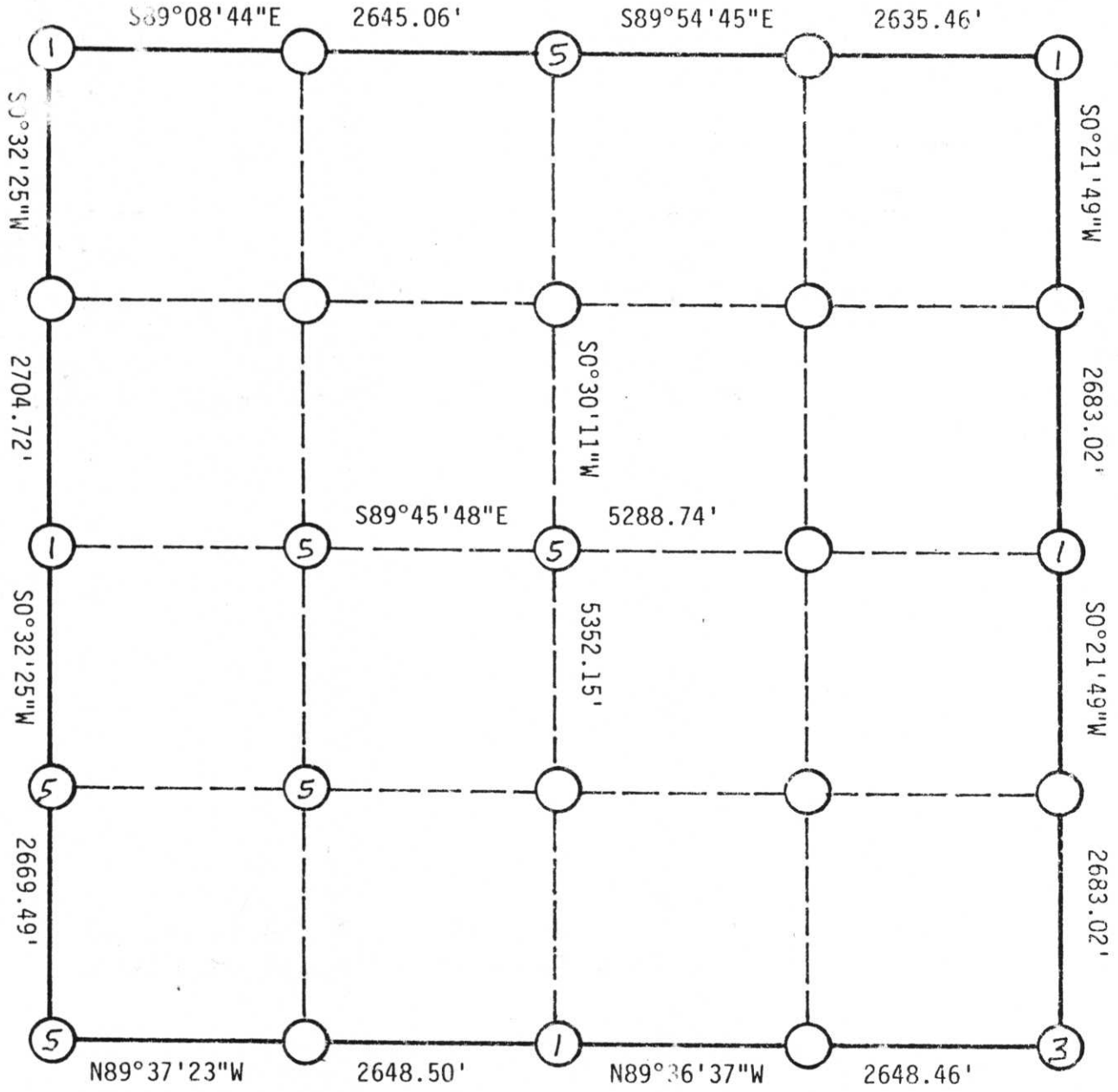

MONUMENT LEGEND : (Specify material and size)

- ① CAST METAL Lincoln County Aluminum Monument
- ② CONCRETE _____
- ③ STONE Granite
- ④ IRON ROD/BAR _____
- ⑤ IRON PIPE 2"
- ⑥ SPIKE / NAIL _____
- ⑦ OTHER _____

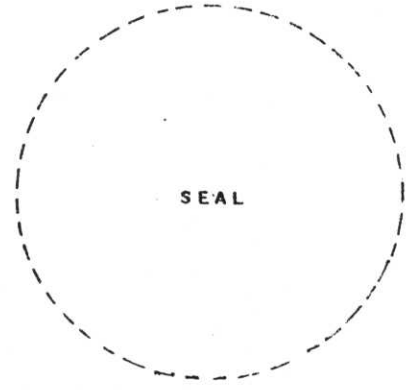

SIGNED: _____
DATE: _____

RECEIVED AT LINCOLN COUNTY
COURTHOUSE THIS 23rd DAY
OF Dec. 1992
Pat Prober
TAX DESCRIPTION OFFICE