

CERTIFIED LAND CORNER RESTORATION

Index No. M-5

State of Wisconsin }
County of LINCOLN } ss.

History of original corner establishment:

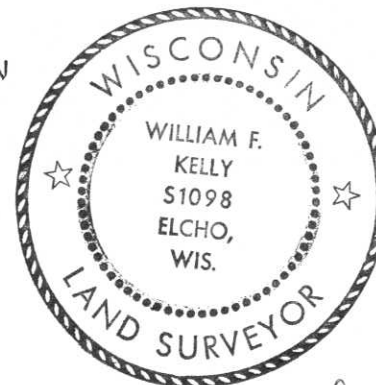

William F. Kelly

I WILLIAM F. KELLY, do hereby certify that on the 22nd day of JANUARY, 1975, I found evidence of the SECTION corner of SECTIONS 18, 17, 19, 20 Township 32, North, Range 4 EAST, Fourth, Principal Meridian, as described hereon; and that from this evidence I established a new monument and accessories as described hereon to perpetuate the original location of this corner.

Description of corner evidence found:

LOCATED SCRIBED POST AND 1" I.P. WITH BEARING TREES.
POST MARKED 5 5 5 5
19 20 17 18

Resident witnesses:

.....
.....
.....

Description of monument and accessories I established to perpetuate the original location of this corner.

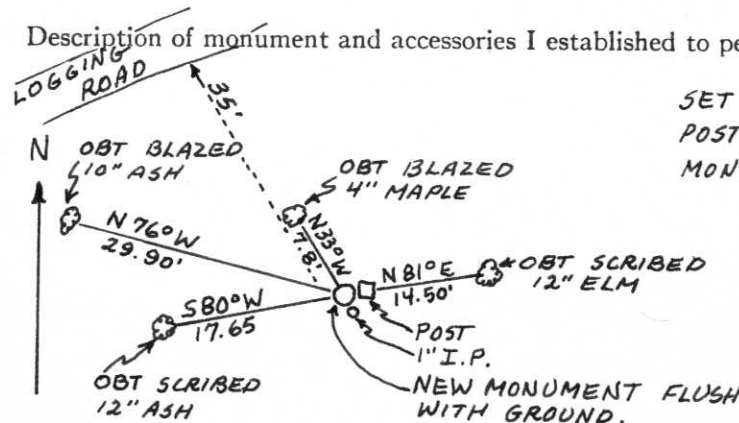

SET NEW MONUMENT AND RESET POST AND IRON PIPE AS WITNESS MONUMENT. NEW MONUMENT MARKED:

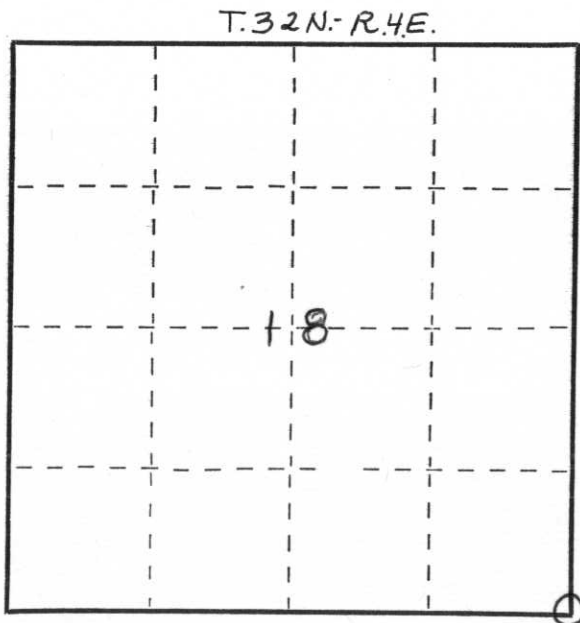

Dated at ELCHO, Wis., this 22nd day of JANUARY, 1974.

Signature William F. Kelly Title REGISTERED LAND SURVEYOR Registration No. 51098
(County Surveyor, Registered Land Surveyor, or other duly authorized official)

Office of Register of Deeds, County of _____, I hereby certify that the within instrument was filed in this office for record on the _____ day of _____, 19____ at _____ o'clock _____ M.

.....
(Register of Deeds)

By _____ Deputy

○ = Corner monument restored.