

CERTIFIED LAND CORNER RESTORATION

Index No. M-25

State of Wisconsin }  
 County of LINCOLN } ss.

I WILLIAM F. KELLY, do hereby certify that on the 31 st day of DECEMBER, 1975, I found evidence of the SECTION corner of SECTIONS 13, 18, 24, 19 Township 32 North, Range 4 EAST, Fourth, Principal Meridian, as described hereon; and that from this evidence I established a new monument and accessories as described hereon to perpetuate the original location of this corner.

Resident witnesses:  
 \_\_\_\_\_  
 \_\_\_\_\_  
 \_\_\_\_\_

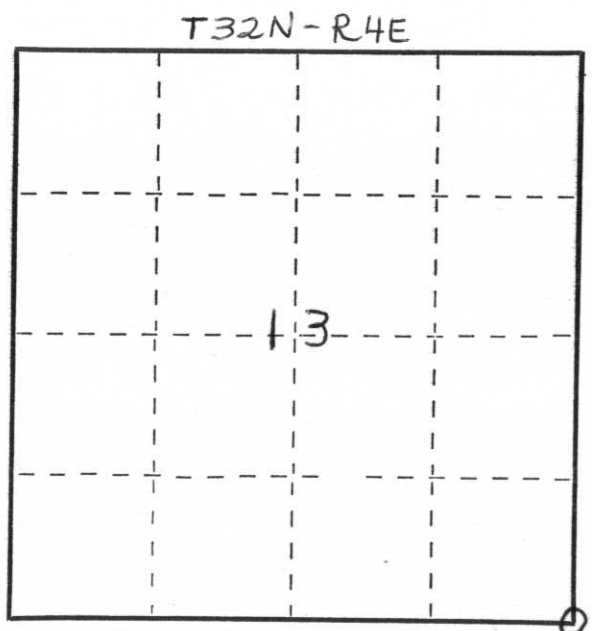

○ = Corner monument restored.

History of original corner establishment:  
 CORNER EST. BY GENISOT AND ASSOCIATES IN FEB 1968 ON SURVEY FOR OWENS-ILLINOIS

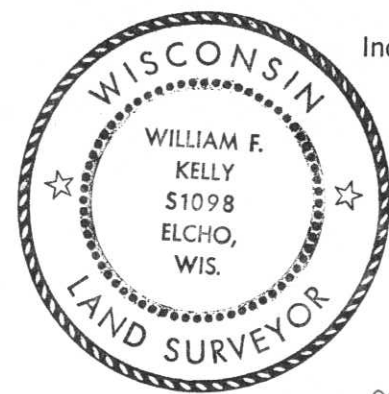

*William F. Kelly*

Description of corner evidence found:  
 LOCATED SQUARED POST SCRIBED  $\begin{matrix} S & S & S & S \\ 19 & 18 & 13 & 24 \end{matrix}$  AND A 1 1/2" I.P. ALONG WITH FOUR BEARING TREES.

Description of monument and accessories I established to perpetuate the original location of this corner.

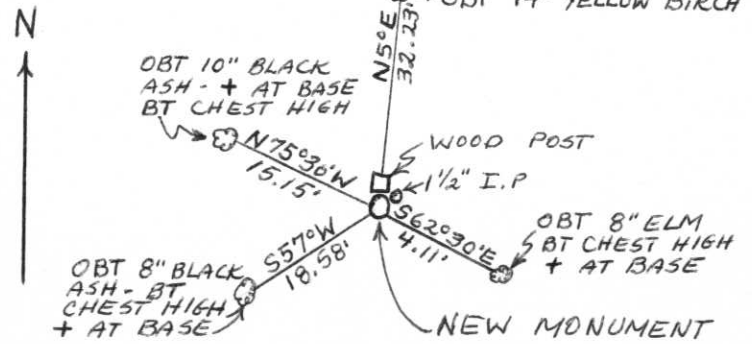

SET NEW LINCOLN COUNTY MONUMENT FLUSH WITH GROUND AND RESET I.P. NEXT TO MONUMENT.  
 MONUMENT MARKED:



Dated at ELCHO, Wis., this 31 st day of DECEMBER, 1974.

Signature William F. Kelly Title REGISTERED LAND SURVEYOR Registration No. S 1098  
 (County Surveyor, Registered Land Surveyor, or other duly authorized official)

Office of Register of Deeds, County of \_\_\_\_\_, I hereby certify that the within instrument was filed in this office for record on the \_\_\_\_\_ day of \_\_\_\_\_, 19\_\_\_\_ at \_\_\_\_\_ o'clock \_\_\_\_\_ M.

\_\_\_\_\_  
 (Register of Deeds)

By \_\_\_\_\_ Deputy