

CERTIFIED LAND CORNER RESTORATION

Index No. Q-3

State of Wisconsin }
County of Lincoln } ss.

History of original corner establishment:

Wood post set by original government surveyor.

I, Sheridan D. Schwark, do hereby certify that on the 6th day of January, 1981, I found evidence of the N 1/4 corner of Section 30 Township 31, North, Range 8 East, Fourth, Principal Meridian, as described hereon; and that from this evidence I established a new monument and accessories as described hereon to perpetuate the original location of this corner.

Description of corner evidence found:

We found a 6" x 6" red granite stone monument at a fence intersection. The stone had been heaved up by frost and was 2.3' above grade and was leaning northerly. We reset the stone in its location.

Resident witnesses:

.....
.....
.....

Description of monument and accessories I established to perpetuate the original location of this corner.

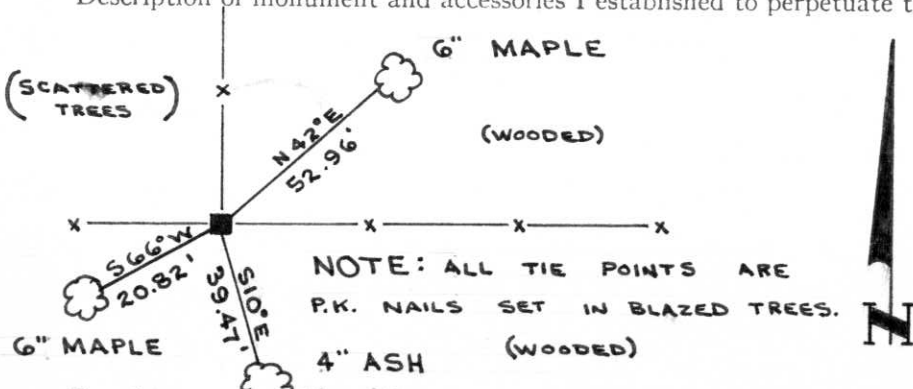
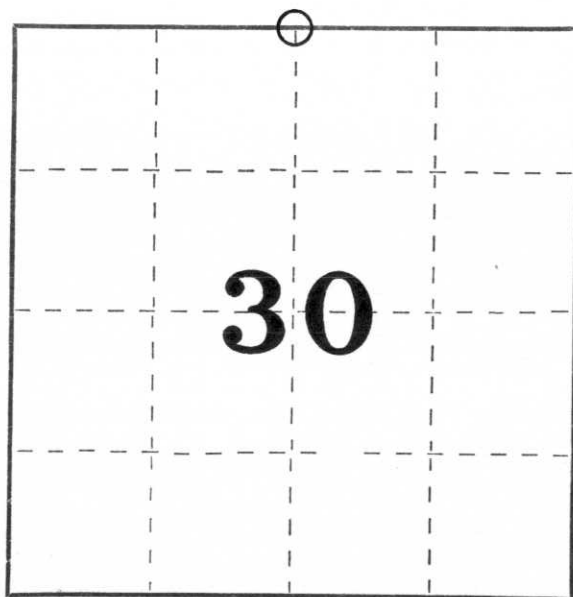

Dated at Merrill, Wis., this 13th day of January, 1981.

Signature Sheridan D. Schwark Title Registered Land Surveyor Registration No. S-1205
(County Surveyor, Registered Land Surveyor, or other duly authorized official)

Office of Register of Deeds, County of _____, I hereby certify that the within instrument was filed in this office for record on the _____ day of _____, 19____ at _____ o'clock _____ M.

(Register of Deeds)

By _____ Deputy

○ = Corner monument restored.







