

CERTIFIED LAND CORNER RESTORATION

Index No. 0-17

State of Wisconsin }
 County of Lincoln } ss.

History of original corner establishment:
 Original wood post set by Government Surveyor.

I Sheridan D. Schwark, do hereby certify that on the 6th day of April, 1985, I found evidence of the West one quarter corner of Section 23, Township 31, North, Range 7 East, Fourth, Principal Meridian, as described hereon; and that from this evidence I established a new monument and accessories as described hereon to perpetuate the original location of this corner.

Description of corner evidence found:

We dug near the intersection of a fenceline from the north and the centerline of Center Road and found a 6" x 6" red granite monument approximately 1.5 feet below the surface of the road. The monument had been broken into 2 pieces and was tipped northwesterly. We established the corner location at the base of the bottom portion which looked undisturbed. We set a Lincoln County Berntsen Monument and establish the references shown below.

Resident witnesses:

.....

Description of monument and accessories I established to perpetuate the original location of this corner.

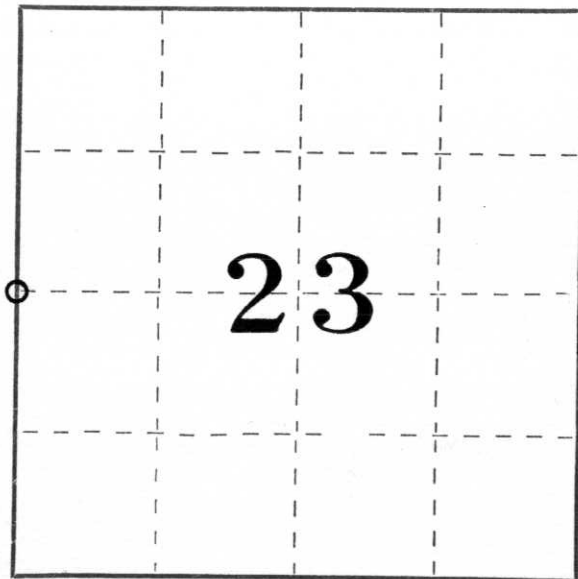

○ = Corner monument restored.

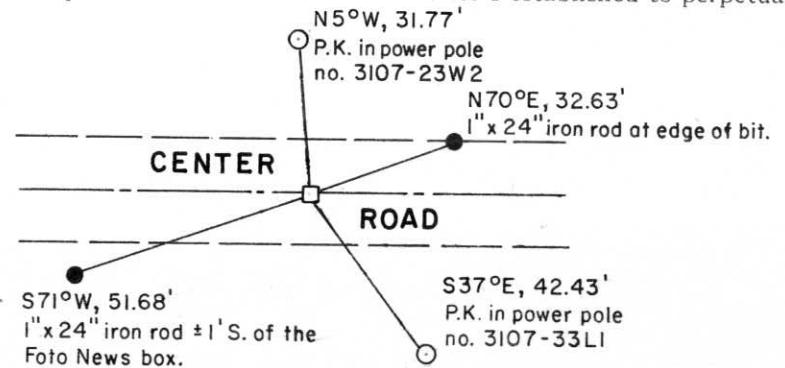

Dated at Merrill, Wis., this 12th day of April, 1985

Signature Sheridan D. Schwark Title Registered Land Surveyor Registration No S-1205
 (County Surveyor, Registered Land Surveyor, or other duly authorized official)

Office of Register of Deeds, County of _____, I hereby certify that the within instrument was filed in this office for record on the _____ day of _____, 19____ at _____ o'clock _____ M.

.....
 (Register of Deeds)

By _____ Deputy