

CERTIFIED LAND CORNER RESTORATION

Index No. Q-11

State of Wisconsin }
County of Lincoln } ss.

History of original corner establishment:

Wood post set by original government surveyor.

I Sheridan D. Schwark, do hereby certify that on the 13th day of October, 1980, I found evidence of the North one-quarter corner of Section 28 in Section 28 Township 31, North, Range 7 East, Fourth, Principal Meridian, as described hereon; and that from this evidence I established a new monument and accessories as described hereon to perpetuate the original location of this corner.

Description of corner evidence found:

We found a 6" x 6" granite monument and set the references shown below.

Resident witnesses:

.....
.....
.....

Description of monument and accessories I established to perpetuate the original location of this corner.

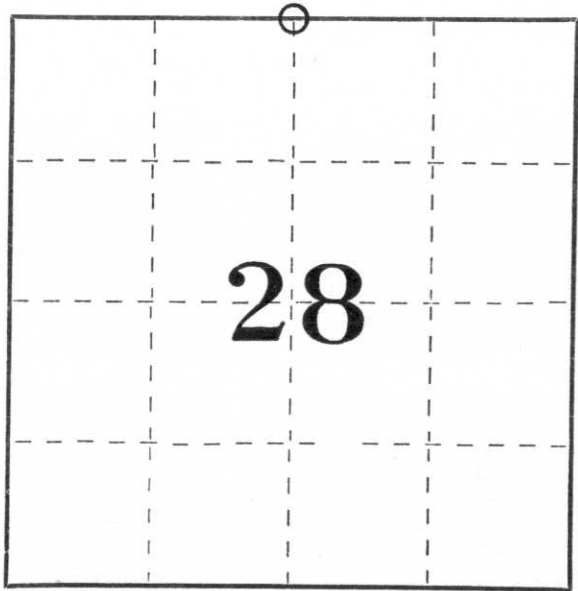

○ = Corner monument restored.

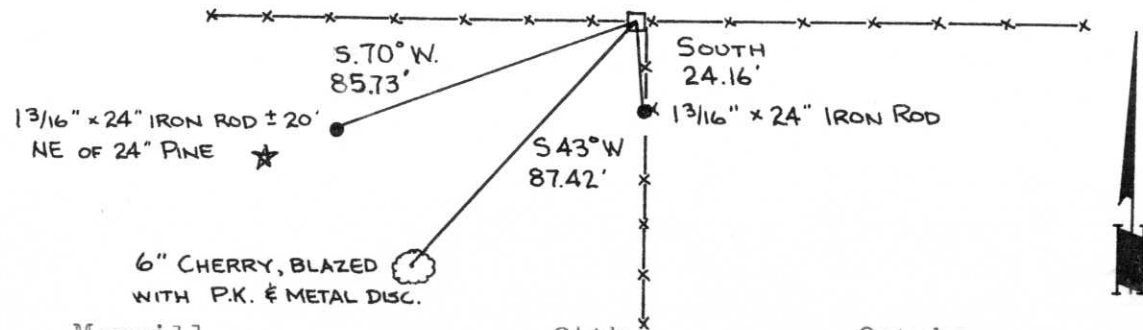

Dated at Merrill, Wis., this 24th day of October, 1980.

Signature Sheridan D. Schwark Title Registered Land Surveyor Registration No. S-1205
(County Surveyor, Registered Land Surveyor, or other duly authorized official)

Office of Register of Deeds, County of _____, I hereby certify that the within instrument was filed in this office for record on the _____ day of _____, 19____ at _____ o'clock _____ M.

(Register of Deeds)

By _____ Deputy





