

CERTIFIED LAND CORNER RESTORATION

Index No. Y-13

State of Wisconsin }  
County of LINCOLN } ss.

History of original corner establishment:

I FRANCIS X FOX, do hereby certify that on the \_\_\_\_\_ day of \_\_\_\_\_, 1971, I found evidence of the SW CORNER STONE corner of SECTION 34 Township 31, North, Range 5 EAST, Fourth, Principal Meridian, as described hereon; and that from this evidence I established a new monument and accessories as described hereon to perpetuate the original location of this corner.

Description of corner evidence found:

CORNER STONE

Resident witnesses:

\_\_\_\_\_  
\_\_\_\_\_  
\_\_\_\_\_

23.

Description of monument and accessories I established to perpetuate the original location of this corner.

SET 3 IRON REFERENCE STAKES AS SHOWN

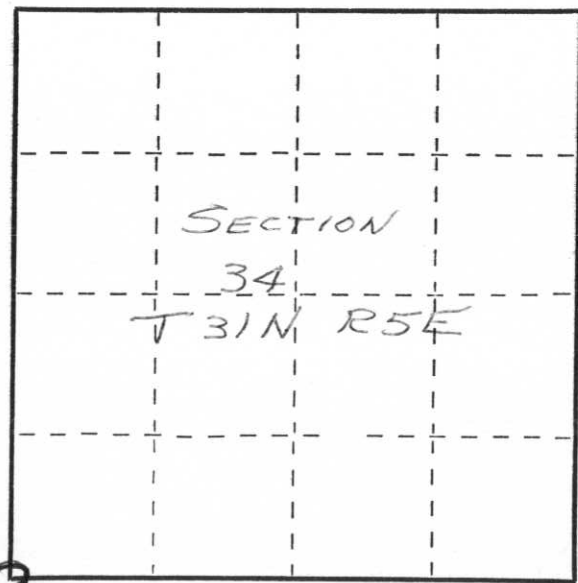
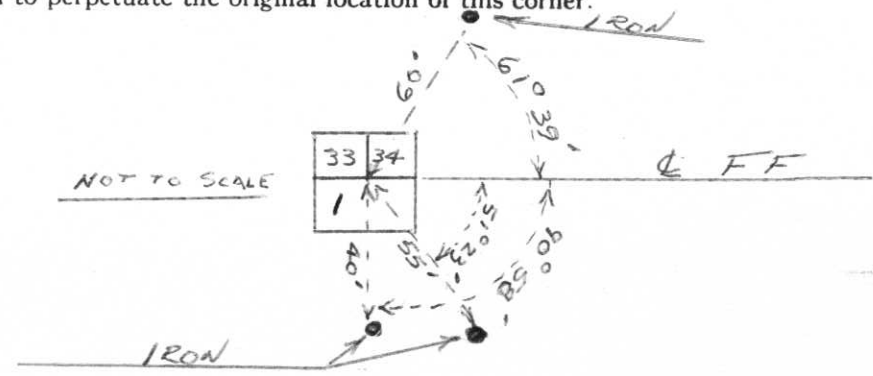

○ = Corner monument restored.

Dated at MERRILL, Wis., this 6th day of DECEMBER, 1972.

Signature Francis X Fox Title HIGHWAY COMMISSIONER Registration No. S 0046  
(County Surveyor, Registered Land Surveyor, or other duly authorized official)

Office of Register of Deeds, County of \_\_\_\_\_, I hereby certify that the within instrument was filed in this office for record on the \_\_\_\_\_ day of \_\_\_\_\_, 19\_\_\_\_ at \_\_\_\_\_ o'clock \_\_\_\_\_ M.

\_\_\_\_\_  
(Register of Deeds)

By \_\_\_\_\_ Deputy





