

CERTIFIED LAND CORNER RESTORATION

Index No. 0-13

State of Wisconsin }  
County of Lincoln } ss.

I Lester J. Schmit, do hereby  
certify that on the 4th day  
of December, 1979, I found  
evidence of the Northeast  
corner of Section 33  
Township 35, North, Range  
7 East, Fourth, Principal Meridian,  
as described hereon; and that from this evidence  
I established a new monument and accessories  
as described hereon to perpetuate the original  
location of this corner.

Resident witnesses:

Guy Myers  
\_\_\_\_\_  
\_\_\_\_\_  
\_\_\_\_\_

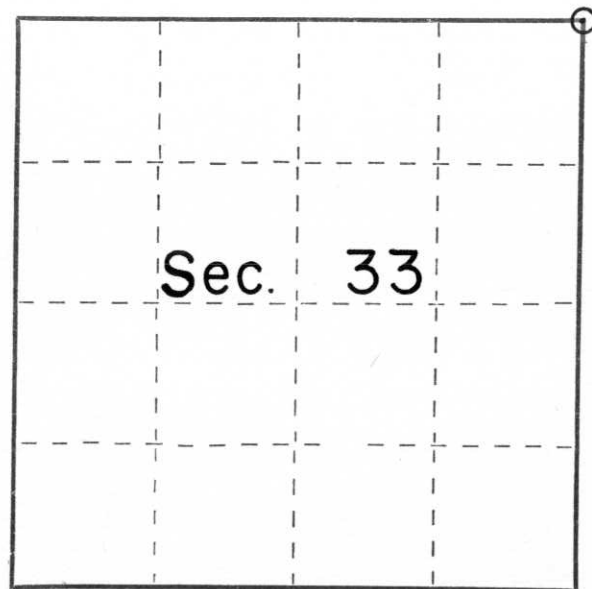

○ = Corner monument restored.

History of original corner establishment:

Surveyor: Alfred Millard  
Date: 8 August 1860  
Monumentation: Wood Post  
Witnesses: 16" White Pine, S 11° E, 25 links  
16" White Pine, N 39° E, 20 links

Description of corner evidence found:

A 1" iron pipe & a rotted off wood post for corner location.  
Witnessed by a 10" Norway Pine, S 35° E, 4.42'  
11" Norway Pine, S 87° W, 12.04'

Description of monument and accessories I established to perpetuate the original location of this corner.

Replaced the iron pipe with a 30" Berntsen monument for the corner.  
New witnesses: 17" Norway Pine, N 4° E, 15.14'  
14" Norway Pine, N 73° E, 21.20'

Dated at Tomahawk, Wis., this 4th day of August, 1980

Signature Lester J. Schmit Title Land Surveyor Registration No. S 1192  
(County Surveyor, Registered Land Surveyor, or other duly authorized official)

Office of Register of Deeds, County of \_\_\_\_\_, I hereby certify that the within  
instrument was filed in this office for record on the \_\_\_\_\_ day of \_\_\_\_\_, 19\_\_\_\_  
at \_\_\_\_\_ o'clock \_\_\_\_\_ M.

\_\_\_\_\_  
(Register of Deeds)

By \_\_\_\_\_ Deputy