

CERTIFIED LAND CORNER RESTORATION

Index No. K-25

State of Wisconsin }
County of LINCOLN } ss.

History of original corner establishment:

I Chester J. Nowaczyk, do hereby certify that on the 9th day of Oct, 1977, I found evidence of the EVA COR corner of SEC 13 Township 35 North, North, Range 7 EAST, Fourth, Principal Meridian, as described hereon; and that from this evidence I established a new monument and accessories as described hereon to perpetuate the original location of this corner.

Description of corner evidence found:

FOUND EXISTING 1" IRON LOCATION VERTIED
By sub division of SECTION

Resident witnesses:

.....
.....
.....

Description of monument and accessories I established to perpetuate the original location of this corner.

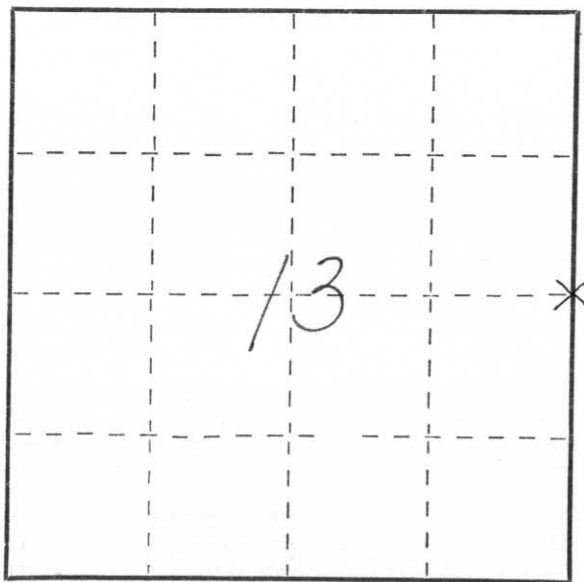
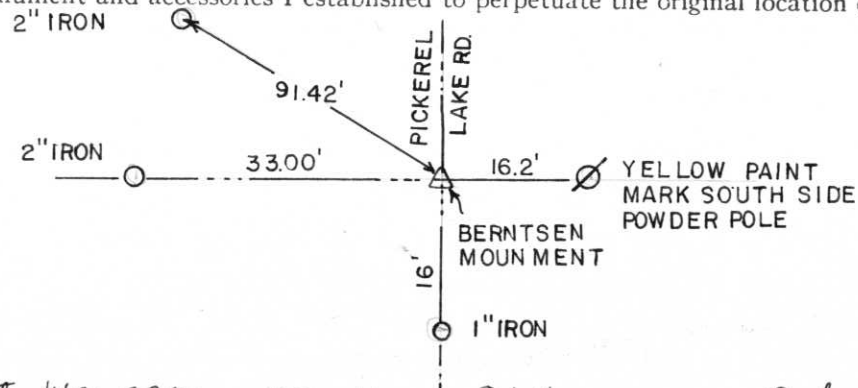

○ = Corner monument restored.

Dated at WAUSAU, Wis., this 25th day of Oct, 1977.

Signature Chester J. Nowaczyk Title SURVEYOR LAND Registration No. 51143
(County Surveyor, Registered Land Surveyor, or other duly authorized official)

Office of Register of Deeds, County of _____, I hereby certify that the within instrument was filed in this office for record on the _____ day of _____, 19____ at _____ o'clock _____ M.

.....
(Register of Deeds)

By _____ Deputy