

Index No. 8-15

CERTIFIED LAND CORNER RESTORATION

History of original corner establishment:

Surveyor: Joseph W. Jenkins
Date: 27 September 1862
Monumentation: Wood Post
Witnesses: Birch 8, S 70° E, 17 links
 Birch 6, N 40° W, 13 links

Description of corner evidence found: Found no monument in for the corner. On a retracement of a survey done by Ray Hallisy (S685), reset corner location by the extension southerly of 25.00' from the pipe set by Hallisy. See diagram below:

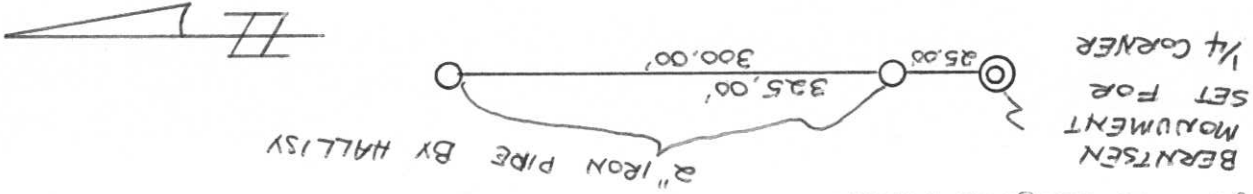

Description of monument and accessories I established to perpetuate the original location of this corner. Set Berntsen monument for the corner. See reverse side for diagram. Witnessed by: 14" norway pine, N 57° E, 36.10'; 13" norway pine, S 16° E, 34.31'; 9" white pine, S 42° W, 49.06'; 16" norway pine, N 52° W, 62.78'

Dated at Tomahawk, Wis., this 11th day of November, 19 84
Signature: *Luigi Schmit*
Title: Land Surveyor
(County Surveyor, Registered Land Surveyor, or other duly authorized official)
Registration No. S-1192
Office of Register of Deeds, County of _____, I hereby certify that the within instrument was filed in this office for record on the _____ day of _____, 19 _____ at _____ o'clock _____ M.

By _____
(Register of Deeds)
Deputy

State of Wisconsin }
County of Lincoln } ss.

I, Lester J. Schmit, do hereby certify that on the 8th day of November, 19 84, I found evidence of the North 1/4 corner of Section 27, Township 35 North, Range 5 East, Fourth, Principal Meridian, as described hereon; and that from this evidence I established a new monument and accessories as described hereon to perpetuate the original location of this corner.

Resident witnesses:

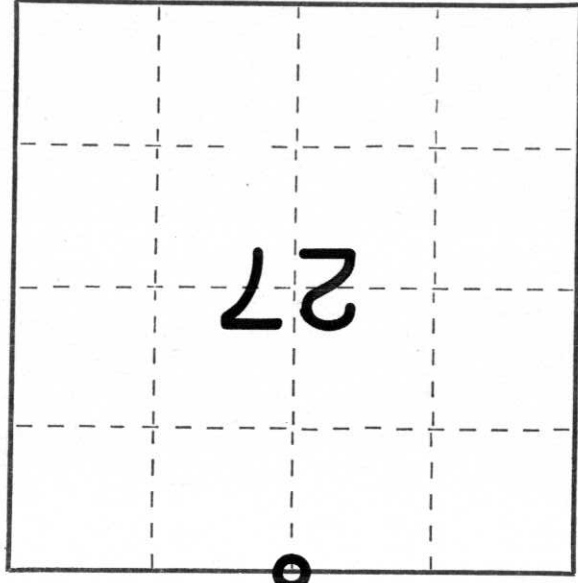

○ = Corner monument restored.