

CERTIFIED LAND CORNER RESTORATION

Index No. A-17

State of Wisconsin }  
County of Lincoln } ss.

History of original corner establishment:

Wood post set by original government surveyor

I Alan C. Drum th do hereby  
certify that on the 24 day  
of March, 19 81, I found  
evidence of the NW Section Corner  
~~corner~~ of Section 2  
Township 33, North, Range  
8E, Fourth, Principal Meridian,  
as described hereon; and that from this evidence  
I established a new monument and accessories  
as described hereon to perpetuate the original  
location of this corner.

Description of corner evidence found:

Found 6" x 6" red granite monument upright in ground on old fenceline  
intersection. Tied in to witness trees, placing P.K. Nail in trees.

Resident witnesses:

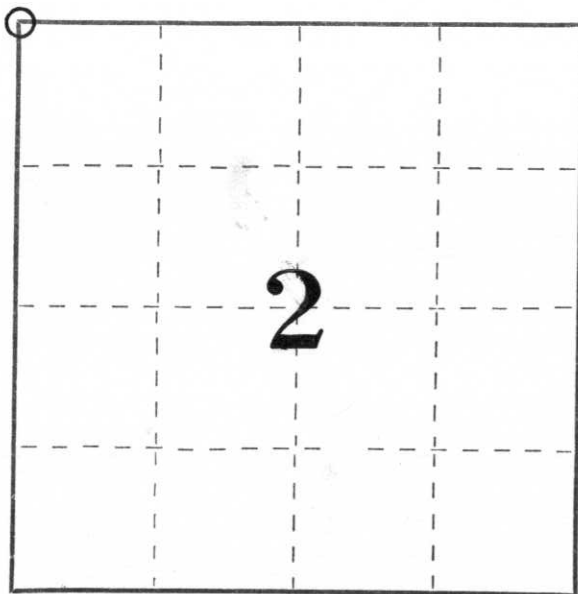

○ = Corner monument restored.

Description of monument and accessories I established to perpetuate the original location of this corner.

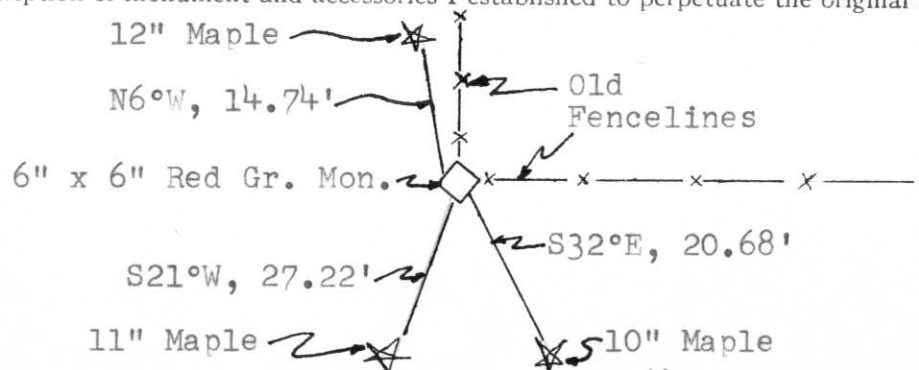

Dated at Merrill, Wis., this 11 day of August, 19 81

Signature Alan C. Drum Title R.L.S. Registration No. S-1456  
(County Surveyor, Registered Land Surveyor, or other duly authorized official)

Office of Register of Deeds, County of Lincoln, I hereby certify that the within  
instrument was filed in this office for record on the \_\_\_\_\_ day of \_\_\_\_\_, 19 \_\_\_\_\_  
at \_\_\_\_\_ o'clock \_\_\_\_\_ M.

(Register of Deeds)

By \_\_\_\_\_ Deputy