

U.S. PUBLIC LAND SURVEY MONUMENT RECORD

Note: This form is intended and designed to fulfill all requirements of Wisconsin Administrative Code, Chapter A-E 5.02, U.S. Public Land Survey Monument Record (3) (a) (b) (c) (d) (e) (f) (g) (h) (i). An additional sheet may be added if necessary to conform with said requirements.

(a) Corner location: Township 34 North
 Range 8 East

Town Harrison

County Lincoln

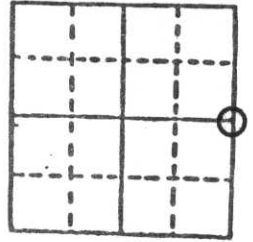

Section 24

b) (f) (g) (h) Description of monument found at this corner and if it was accepted, state all evidence (material, testimonial, occupational, plats, records, other monuments) used as a basis for accepting. If not accepted or if nothing was found, state evidence used as basis for establishing location. If reestablished through lost corner proportionate methods, indicate all monuments, distances and directions used to establish. Original Gov't. Survey: 1851 by James M. Marsh, set wood post for corner with bearings, elm 8 S 20 E 41, sugar 8 S 21 W 18, sugar 12 N 30 W 64 & white pine 12 N 49 E 9. I found a 4" capped iron pipe for the corner with 4 old B.T.s having a nail & washer in the face of the B.T. to reference the corner as shown below.

c) (d) (e) Plan view of corner with ties to at least 4 witness monuments. If in disagreement with previously established corner, show the distances between the two corners and also indicate the ties to the disputed corner.

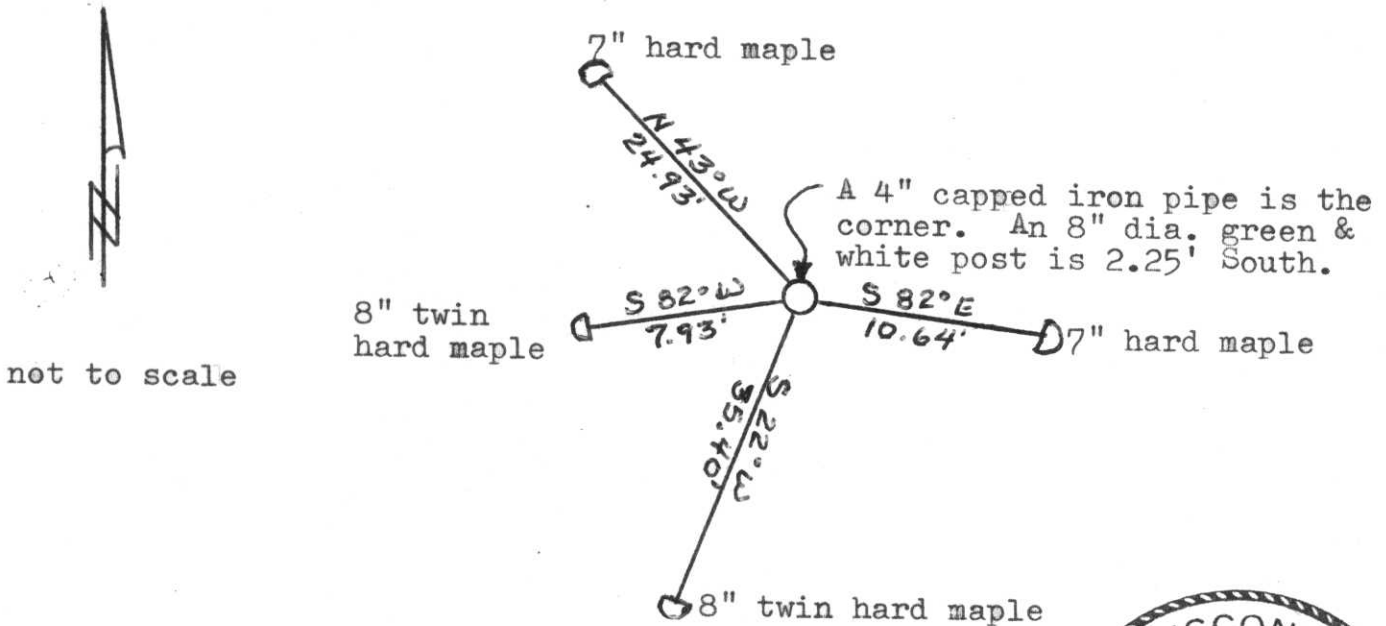

(i) I, Lester J. Schmit R.L.S. 1192
 (type or print name) certify that the corner location on this record was determined by me or under my direction and control and that this U.S. Public Land Survey Monument Record is correct and complete to the best of my knowledge and belief.

Lester J. Schmit Signature 7 May 91 Date



Index No. 0-25

RECEIVED AT LINCOLN COUNTY
 COURTHOUSE THIS 13 DAY
 OF May 1991.
Pat Pribe
 TAX DESCRIPTION OFFICE