

LINCOLN COUNTY U.S. PUBLIC LAND SURVEY MONUMENT LOCATION RECORD

SECTION 6
 TOWNSHIP 34
 RANGE 6

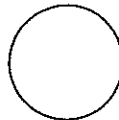

LANDMARK BENCHMARK _____
 CORNER IDENTITY: _____ SURVEY NAIL FOUND SET
 RE-SET RE-TIED

BRADLEY
 CITY, VILLAGE, TOWN

LINCOLN COUNTY COORDINATE: N: _____
 E: _____

ELEVATION-(FEET): _____ DATUM: _____

WEATHER: _____ PARTLY SUNNY

DATE OF SURVEY: 4/8/2011 TEMPERATURE: 50 °F

SURVEY PARTY: NATHAN WINCENTSEN / KEITH WALKOWSKI

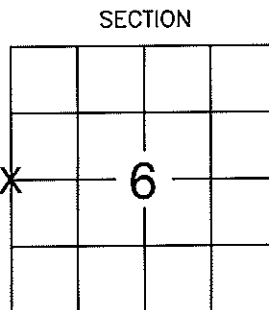

LOCATION
(Indicated By X)



BASIS FOR MONUMENT LOCATION:
 (DESCRIBE METHOD OF SURVEY AND CORNER AUTHENTICATION)

SEARCHED FOR THE WEST 1/4 CORNER AND FOUND A SURVEY NAIL THAT WAS SET BY THE LINCOLN COUNTY SURVEYOR ON A STRAIGHT LINE PRORATION. THE POSITION OF THE NAIL FITS A 40 FENCE FOUND SOUTH OF THE WEST 1/4. HELD SURVEY NAIL OF AS BEST AVAILABLE EVIDENCE FOR THE WEST 1/4 CORNER AND PERPETUATED AS SHOWN BELOW.

RECEIVED BY LINCOLN COUNTY SURVEYOR THIS 21ST DAY OF April 20 11
Tom Dahl
 COUNTY SURVEYOR

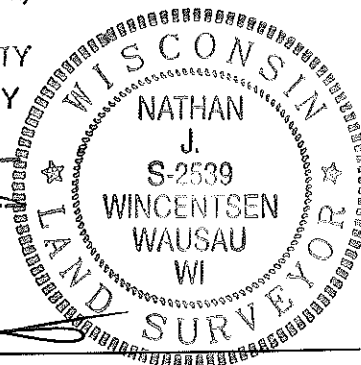

CERTIFIED CORRECT:

NW JNW

NATHAN WINCENTSEN S-2539

Registered Land Surveyor

DATE: 4-7-2011

FIELD BOOK NO. 31 PAGE NO. 22

COMPANY RIVERSIDE LAND SURVEYING LLC

TIE SKETCH:

SHOW MINIMUM OF FOUR (4) HORIZONTAL TIE DISTANCES TO FIXED WITNESS MONUMENTS. DESCRIBE ALL MONUMENTS FOUND OR SET. CORRECT ALL DISTANCES SHOWN TO STANDARD TEMPERATURE OF 68° F.

- SURVEY NAIL FOUND
- - 7/8" REBAR WITH ALUMINUM CAP SET
- ⊥ - VINYL POST

WOODED AREA

BEARINGS ARE REFERENCED TO THE LINCOLN COUNTY COORDINATE SYSTEM.

THIS DRAWING IS NOT TO SCALE

