

CERTIFIED LAND CORNER RESTORATION

Index No. Q-19

State of Wisconsin }
County of Lincoln } ss.

History of original corner establishment:
Original wood post set by Government Surveyor

I Sheridan D. Schwark, do hereby certify that on the 1st day of October, 1984, I found evidence of the North one quarter corner of Section 26 Township 33, North, Range 6 East, Fourth, Principal Meridian, as described hereon; and that from this evidence I established a new monument and accessories as described hereon to perpetuate the original location of this corner.

Description of corner evidence found:

We found a 6" x 6" red granite set by Francis Fox during the remonumentation of the Town of Rock Falls.

Resident witnesses:

.....
.....
.....

Description of monument and accessories I established to perpetuate the original location of this corner.

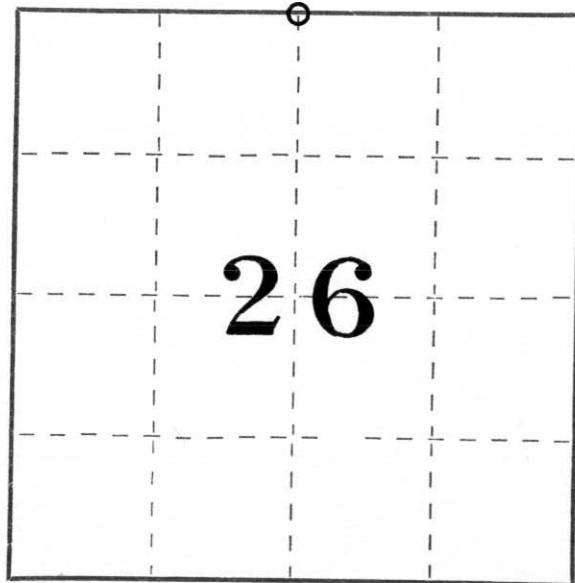

○ = Corner monument restored.

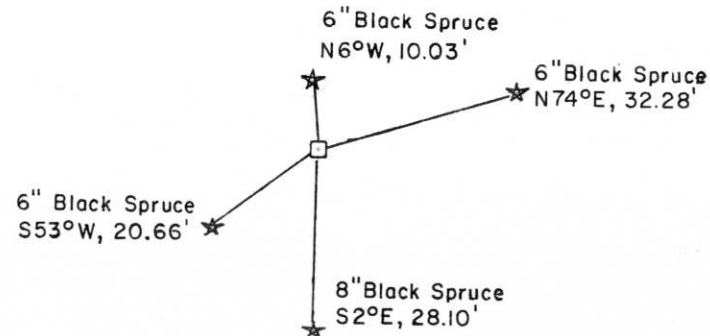

Dated at Merrill, Wis., this 11th day of March, 1985.

Signature Sheridan D. Schwark Title Registered Land Surveyor Registration No. S-1205
(County Surveyor, Registered Land Surveyor, or other duly authorized official)

Office of Register of Deeds, County of _____, I hereby certify that the within instrument was filed in this office for record on the _____ day of _____, 19____ at _____ o'clock _____ M.

(Register of Deeds)

By _____ Deputy