

# LINCOLN COUNTY U.S. PUBLIC LAND SURVEY MONUMENT LOCATION RECORD

SECTION 24  
 TOWNSHIP 33 N  
 RANGE 6 E

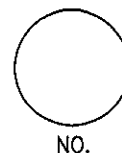

LANDMARK  BENCHMARK \_\_\_\_\_  
 CORNER IDENTITY: GRANITE STONE

FOUND   
 SET   
 RESET   
 RE-TIED

ROCK FALLS  
 CITY, VILLAGE, TOWN

LINCOLN COUNTY COORDINATE: N: 177041.95  
 E: 393944.35

ELEVATION--(FEET): \_\_\_\_\_ DATUM: \_\_\_\_\_

WEATHER: CLOUDY/DRIZZLE

DATE OF SURVEY: 11/19/2009 TEMPERATURE: 47 °F

SURVEY PARTY: KEITH WALKOWSKI / NATHAN WINCENTSEN

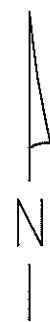
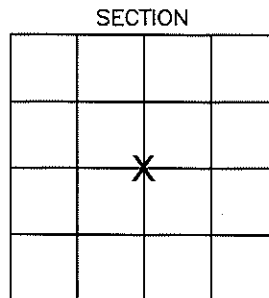

## BASIS FOR MONUMENT LOCATION:

(DESCRIBE METHOD OF SURVEY AND CORNER AUTHENTICATION)

SEARCHED FOR CENTER OF SECTION USING FRANCIS FOX'S NOTES. FOUND POLISHED GRAY GRANITE STONE LEANING TO THE EAST. RESET STONE AT ITS BASE AND PERPETUATED CORNER AS SHOWN BELOW.

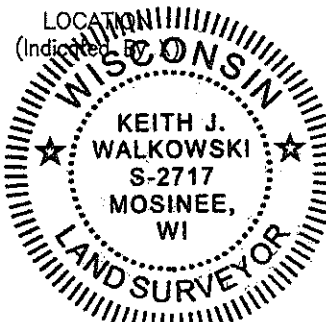

FIELD BOOK NO. NA PAGE NO. NA

COMPANY RIVERSIDE LAND SURVEYING LLC

CERTIFIED CORRECT:

*Keith J. Walkowski*

KEITH WALKOWSKI S-2717

Registered Land Surveyor

DATE: NOVEMBER 24, 2009

**TIE SKETCH:** SHOW MINIMUM OF FOUR (4) HORIZONTAL TIE DISTANCES TO FIXED WITNESS MONUMENTS. DESCRIBE ALL MONUMENTS FOUND OR SET. CORRECT ALL DISTANCES SHOWN TO STANDARD TEMPERATURE OF 68° F.

- GRANITE STONE FOUND
- SET 60D SPIKE IN BRIDGE ABUTMENT

NOTE:  
 BEARINGS AND COORDINATES ARE BASED ON THE LINCOLN COUNTY COORDINATE SYSTEM AND REFERENCED TO THE ROCK FALLS NORTH GPS STATION.

RECEIVED BY LINCOLN COUNTY SURVEYOR THIS 30<sup>TH</sup> DAY

OF November 20 09

*Tommy Dalen*  
 COUNTY SURVEYOR

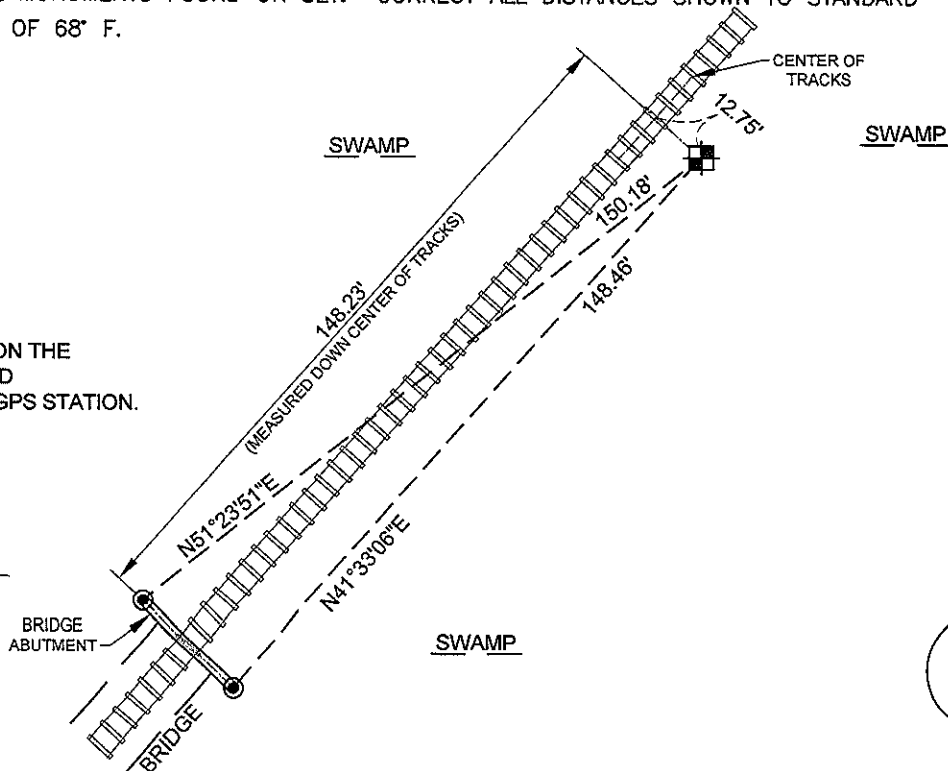

- THIS DRAWING IS NOT TO SCALE

0-23